

Itasca County Timber Appraisal Report

Appraised By: Nick Schreiber Appraisal Date: 10/25/2018	Sale Type: REGULAR AUCTION SALE Auction Date: 12/08/2022	Appraisal Number: 18-03-20 Permit Number: Expiration Date: 03/01/2025 Page: 1 of 3
--	---	---

Legal Description

<u>RE Code</u>	<u>Sec.</u>	<u>Twp.</u>	<u>Rge.</u>	<u>City/Twp</u>	<u>Subd</u>
60-026-2100	26	60	25	Unorganized	NE NW
60-026-2200	26	60	25	Unorganized	NW NW
60-026-2300	26	60	25	Unorganized	SW NW
60-026-2400	26	60	25	Unorganized	SE NW
60-026-3100	26	60	25	Unorganized	NE SW
60-026-4101	26	60	25	Unorganized	LOT 3

<u>Block 1 Species</u>	<u>Volume</u>	<u>Units</u>	<u>Unit Price</u>	<u>Value</u>	<u>Comments</u>	<u>Bolt %</u>	<u>Bid</u>
Ash	487	Cords	\$8.00	\$3,896.00	3-7 sticks, 86-98 yrs. old.	40	^
Aspen	58	Cords	\$15.00	\$870.00	5-7 sticks.	15	#
Balsam Fir	54	Cords	\$5.00	\$270.00	4-6 sticks	15	#
Balm	22	Cords	\$10.00	\$220.00	4-6 sticks	0	#
				\$5,256.00	Subtotal		
Total Cords =	621	Total MBF: 0		\$5,256.00	Total		

Bid Symbols: ^ = Bid Species; # = Non-Bid Species; + = Sold Area Estimate; * = Sold Area Estimate & Non-Bid Species
 All species woodsrun unless listed otherwise.

Species Scaled: Ash , Aspen, Balm , Balsam Fir
Species SAE:

Operability: Winter-frozen ground only.: 1/1 - 3/1 **Soil Type:** Seelyeville-Bowstring association (799)
Topography: Level **Cutting Acres:** 43.0

All permits must follow Itasca County Forest Management Guidelines and Specifications (can be found at <http://www.co.itasca.mn.us/DocumentCenter/View/567/Forest-Management-Guidelines-and-Specifications>).

Harvest Specifications

Comments
Harvest Type: =Ash thin, operator select (37ac) & Aspen clearcut with reserves (6ac) RE-OFFER

Harvest and Reserves
Blks 1,2,3, 5 & 6 are ash thins. Blk 2 is aspen clearcut with reserves. Reserve all oak, elm, cedar, basswood, balsam <2 stick & non-merchantable timber & snags. Reserve 1 well-formed ash (>12"DBH) tree/acre. Reserve all non-merchantable timber within 10 feet of Co. Rd. 7.

Landings and Access Roads
Roads and landings must be approved by sale administrator. Landings must be kept back at least 100 feet from Scenic HWY. Trails and landings need to be rehabilitated to a satisfactory condition, determined by administering forester, before performance bond is returned. Berm(s) must be installed after sale is completed.

Itasca County Timber Appraisal Report

Appraised By: Nick Schreiber Appraisal Date: 10/25/2018	Sale Type: REGULAR AUCTION SALE Auction Date: 12/08/2022	Appraisal Number: 18-03-20 Permit Number: Expiration Date: 03/01/2025 Page: 2 of 3
--	---	---

Cutting, Felling, and Skidding

Ash Thin; Operator Select- Thin stand down to an average of 50 basal area. Favor the removal of smaller diameter, poor quality, and damaged trees.

Ash Thin; All aspen and balm will have 60ft radius gap cuts.

Aspen Clearcut; Harvest all stems except reserve trees.

Do not disturb survey markers, including witness trees.

Sale boundaries painted blue or are natural.

Site, Soil, and Water Protection

Blk 6 has a creek a 50ft buffer has been painted in orange. No clearcutting within the buffer & only one stream crossing.

Slash must be kept out of the creek.

Slash Disposal

Slash must be evenly distributed throughout permit area.

Slash height must not exceed 3 feet within view of road.

Regeneration Plan

Natural regeneration.

Itasca County Timber Appraisal Report

Appraised By:
Nick Schreiber
Appraisal Date:
10/25/2018

Sale Type:
REGULAR AUCTION SALE
Auction Date:
12/08/2022

Appraisal Number: 18-03-20
Permit Number:
Expiration Date: 03/01/2025
Page: 3 of 3

Site Map:

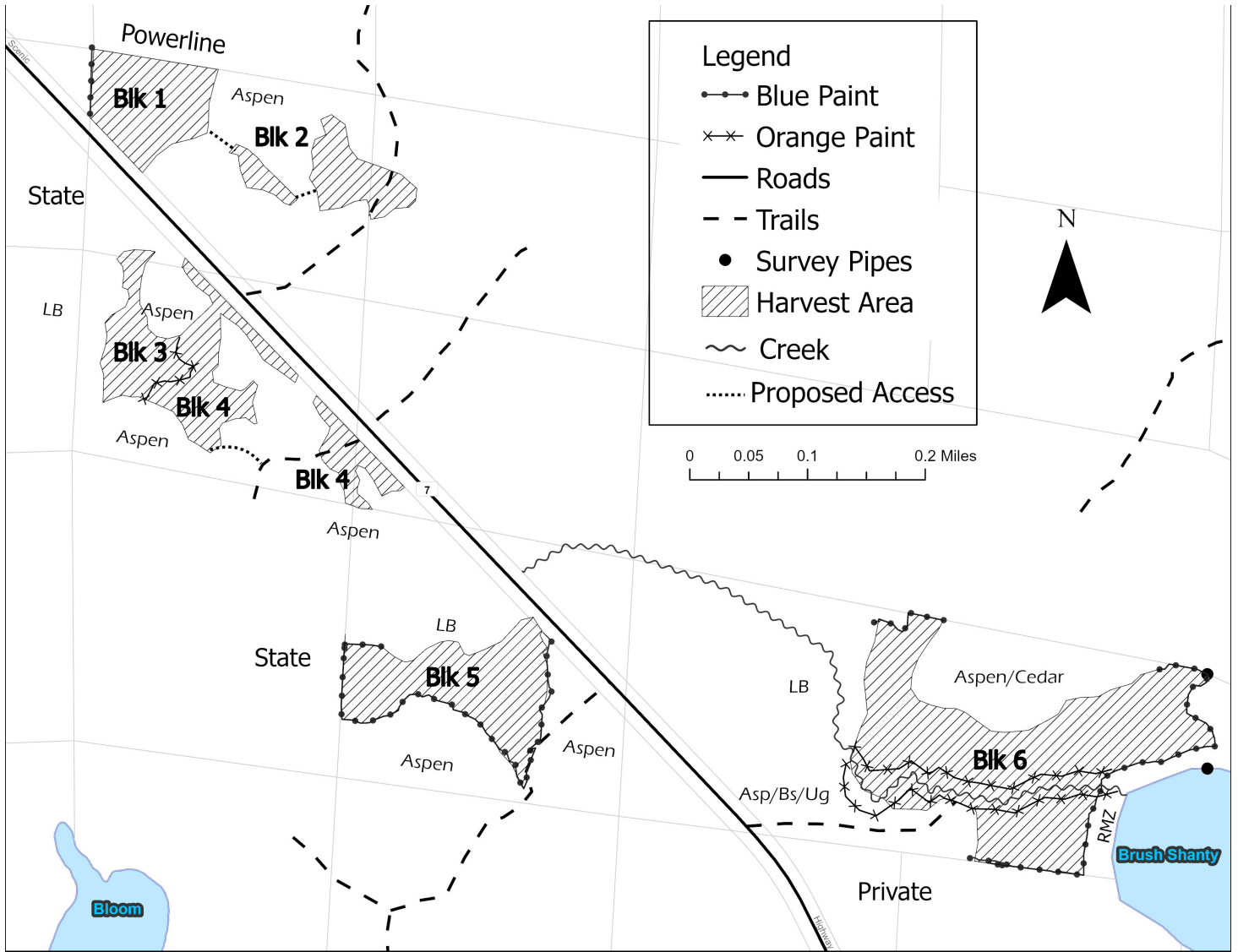

Appraisal examined and approved by _____
Forester Date

Appraisal examined and approved by _____
Land Department Date