

Itasca County Timber Appraisal Report

Appraised By:

Loren Eide

Appraisal Date:

09/03/2019

Sale Type:

REGULAR AUCTION SALE

Auction Date:

12/07/2020

Appraisal Number: 19-05-16**Permit Number:****Expiration Date:** 03/01/2023**Page:** 1 of 3**Legal Description**

RE Code	Sec.	Twp.	Rge.	City/Twp	Subd			
06-035-1100	35	61	22	Bearville	NE NE			
06-035-1300	35	61	22	Bearville	SW NE			
06-035-4200	35	61	22	Bearville	NW SE			
06-035-4300	35	61	22	Bearville	SW SE			
Block 1 Species	Volume	Units	Unit Price	Value	Comments	Bolt %	Bid	
Red Pine	494	Cords	\$13.00	\$6,422.00	3-4 stick, 8"-9"	50	^	
Aspen	120	Cords	\$20.00	\$2,400.00	5-7 stick, 8"-12"		^	
Balsam Fir	56	Cords	\$5.00	\$280.00	3-4 stick, 5"-8"		#	
Jack Pine	36	Cords	\$26.00	\$936.00	6-7 stick, 6"-12"	60	#	
Paper Birch	44	Cords	\$9.00	\$396.00	3-5 stick, 6"-10"		#	
Spruce	12	Cords	\$14.00	\$168.00	3-4 stick, 6"-8", Black Spruce		#	
Tamarack	10	Cords	\$6.00	\$60.00	6-7 stick, 8"-12"	40	#	
				\$10,662.00	Subtotal			
Total Cords =	772		Total MBF: 0	\$10,662.00	Total			

Bid Symbols: ^ = Bid Species; # = Non-Bid Species; + = Sold Area Estimate; * = Sold Area Estimate & Non-Bid Species
All species woodsrun unless listed otherwise.

Species Scaled: Aspen, Balsam Fir, Jack Pine, Paper Birch, Red Pine, Spruce, Tamarack

Species SAE:

Operability: Frozen ground harvest: 12/1 - 3/1

Soil Type: 620B Cutaway loamy sand

Topography: Level

Cutting Acres: 45.0

All permits must follow Itasca County Forest Management Guidelines and Specifications (can be found at <http://www.co.itasca.mn.us/DocumentCenter/View/567/Forest-Management-Guidelines-and-Specifications>).

Harvest Specifications

Comments
HARVEST TYPE: Red Pine 1st time thin, operator select (37 ac); Clear-cut w/reserves aspen mix (8 ac) Re-offer

Harvest and Reserves

In the clearcut block reserve all non hazardous snags, white pine and cedar. The pine thin reserve better quality crop trees.

Access

Access from North Snake Trail Forest Road south along county forest road approximately 1 mile into permit area. Access road also serves two private cabin owners and must be kept in good condition at all times, do not block road access.

Landings and Access Roads

Location and construction of any new roads/landings must be pre-approved by the sale administrator. Trails and landings need to be rehabilitated to a satisfactory condition before performance bond is returned.
Timber sale administrator shall be notified at least 3 working days prior to completion of hauling and road work. This provides adequate time for permit area inspection and addressing of permit compliance requirements before hauling and road work equipment is removed.

Itasca County Timber Appraisal Report

Appraised By: Loren Eide Appraisal Date: 09/03/2019	Sale Type: REGULAR AUCTION SALE Auction Date: 12/07/2020	Appraisal Number: 19-05-16 Permit Number: Expiration Date: 03/01/2023 Page: 2 of 3
--	---	---

Cutting, Felling, and Skidding

Pine thin painted orange. Processed at stump required for thinning. Cut 12 ft. access strips reserving 40 ft. in between strips for thinning. Thin stand down to an average of 90 basal area. Removal of smaller diameter, poor quality, and damaged trees. The clearcut block property line is painted blue rest of boundary painted orange, all slash must be evenly distributed across permit area.

Regeneration Plan

North cutting block will be allowed to naturally regenerate back to aspen, balsam and birch.

Itasca County Timber Appraisal Report

Appraised By: Loren Eide	Sale Type: REGULAR AUCTION SALE	Appraisal Number: 19-05-16
Appraisal Date: 09/03/2019	Auction Date: 12/07/2020	Permit Number:
		Expiration Date: 03/01/2023
		Page: 3 of 3

Site Map:

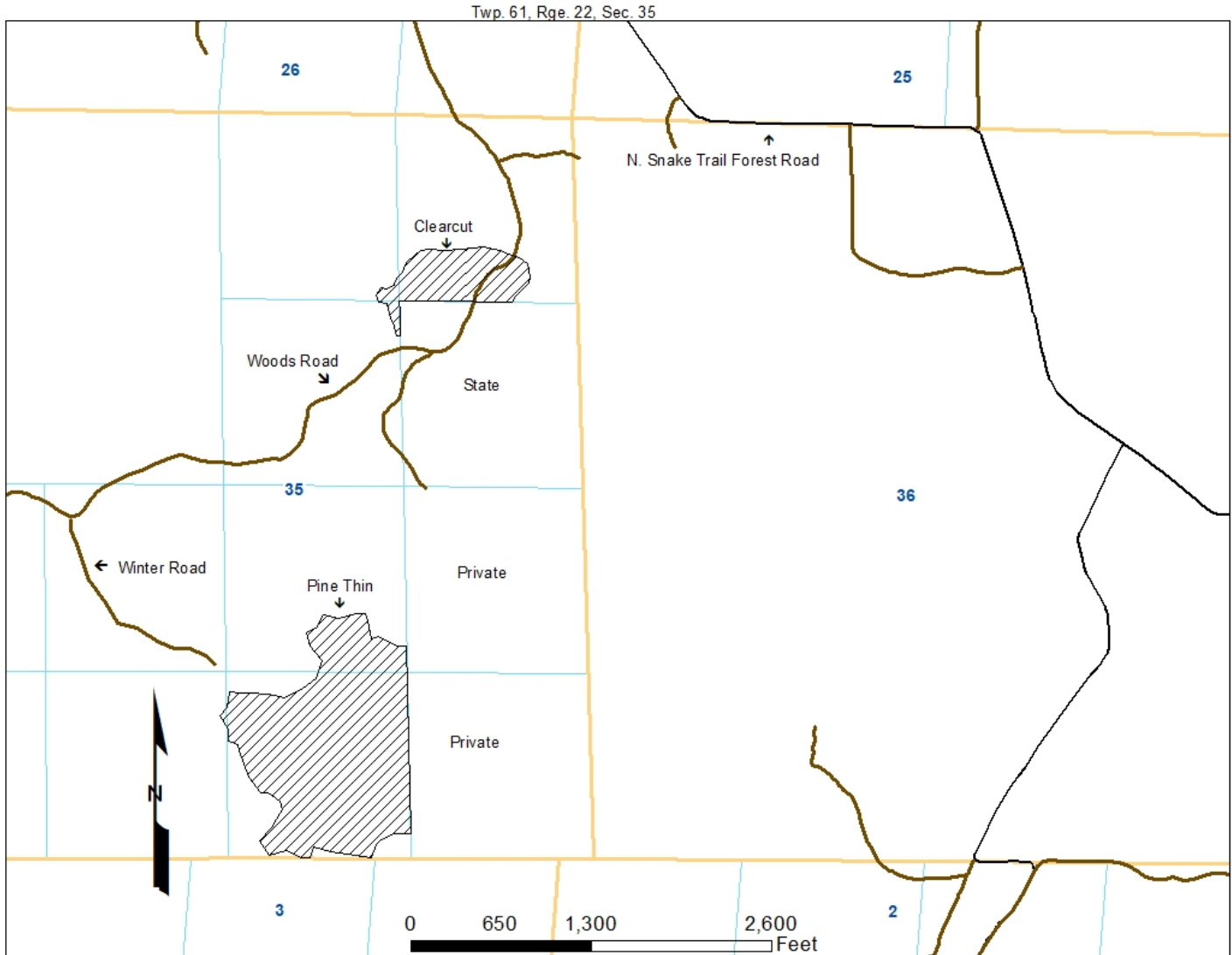

Appraisal examined and approved by _____
Forester Date

Appraisal examined and approved by _____
Land Department Date