

## Itasca County Timber Appraisal Report

<b>Appraised By:</b> Ryan Newman  <b>Appraisal Date:</b> 09/30/2019	<b>Sale Type:</b> REGULAR AUCTION SALE  <b>Auction Date:</b> 12/07/2020	<b>Appraisal Number:</b> 19-05-17 <b>Permit Number:</b> <b>Expiration Date:</b> 03/01/2023 <b>Page:</b> 1 of 3
---------------------------------------------------------------------------------	-------------------------------------------------------------------------------------	-------------------------------------------------------------------------------------------------------------------------

**Legal Description**

RE Code	Sec.	Twp.	Rge.	City/Twp	Subd
53-002-2200	2	60	23	Unorganized	LOT 4
53-003-1000	3	60	23	Unorganized	NE 1/4

Block 1 Species	Volume	Units	Unit Price	Value	Comments	Bolt %	Bid
Spruce	185	Cords	\$10.00	\$1,850.00	3-4 stick, 6"-12", 70% Black Spruce	10	^
Red Pine	20	Cords	\$14.00	\$280.00	5-6 stick, 8"-12"	70	^
Balsam Fir	14	Cords	\$5.00	\$70.00	3-5 stick, 6"-10"	10	#
Jack Pine	5	Cords	\$14.00	\$70.00	5-6 stick, 7"-9"	25	^
Tamarack	3	Cords	\$5.00	\$15.00	6-7 stick, 8"-10"	30	#

\$2,285.00    **Subtotal**

**Total Cords =**    227                      **Total MBF: 0**    \$2,285.00    **Total**

Bid Symbols: ^ = Bid Species; # = Non-Bid Species; + = Sold Area Estimate; \* = Sold Area Estimate & Non-Bid Species  
 All species woodsrun unless listed otherwise.

**Species Scaled:**    Balsam Fir, Jack Pine, Red Pine, Spruce , Tamarack

**Species SAE:**

<b>Operability:</b> Frozen ground harvest only.: 12/1 - 3/1	<b>Soil Type:</b> 627 Twas muck
<b>Topography:</b> Level	<b>Cutting Acres:</b> 14.0

All permits must follow Itasca County Forest Management Guidelines and Specifications (can be found at <http://www.co.itasca.mn.us/DocumentCenter/View/567/Forest-Management-Guidelines-and-Specifications> ).

**Harvest Specifications**

Comments
HARVEST TYPE: White spruce 1st time thin, operator select (9 ac); Final harvest Black spruce (5ac). REOFFER

Access
Access from County Road 52 approximately 1 mile north along woods road to permit area. Road accesses private property that must remain open to highway vehicles. Caution truck hauling signs must be posted.

Landings and Access Roads
Location and construction of any new roads/landings must be pre-approved by the sale administrator. Trails and landings need to be rehabilitated to a satisfactory condition before performance bond is returned. Timber sale administrator shall be notified at least 3 working days prior to completion of hauling and road work. This provides adequate time for permit area inspection and addressing of permit compliance requirements before hauling and road work equipment is removed.

Cutting, Felling, and Skidding
Sale boundary painted blue. In the white spruce stand cut 12 ft. access strips reserving 40 ft. in between strips for thinning. Thin stand down to an average of 90 basal area. Favor the removal of smaller diameter, poor quality, and damaged trees. The black spruce type requires clearcut harvest.

Site, Soil, and Water Protection
There is a small 1'-2' wide intermittent creek / drainage on the north side of the white spruce thin area. Any tree tops or slash that falls into this area must be hauled back into permit area.

**Itasca County Timber Appraisal Report**

<b>Appraised By:</b> Ryan Newman	<b>Sale Type:</b> REGULAR AUCTION SALE	<b>Appraisal Number:</b> 19-05-17
<b>Appraisal Date:</b> 09/30/2019	<b>Auction Date:</b> 12/07/2020	<b>Permit Number:</b>
		<b>Expiration Date:</b> 03/01/2023
		<b>Page:</b> 2 of 3

**Slash Disposal**

Slash must be evenly distributed throughout permit area.

**Regeneration Plan**

The black spruce area should be seeded back to black spruce to insure full stocking potential of this site.

# Itasca County Timber Appraisal Report

<b>Appraised By:</b> Ryan Newman	<b>Sale Type:</b> REGULAR AUCTION SALE	<b>Appraisal Number:</b> 19-05-17
<b>Appraisal Date:</b> 09/30/2019	<b>Auction Date:</b> 12/07/2020	<b>Permit Number:</b>
		<b>Expiration Date:</b> 03/01/2023
		<b>Page:</b> 3 of 3

**Site Map:**

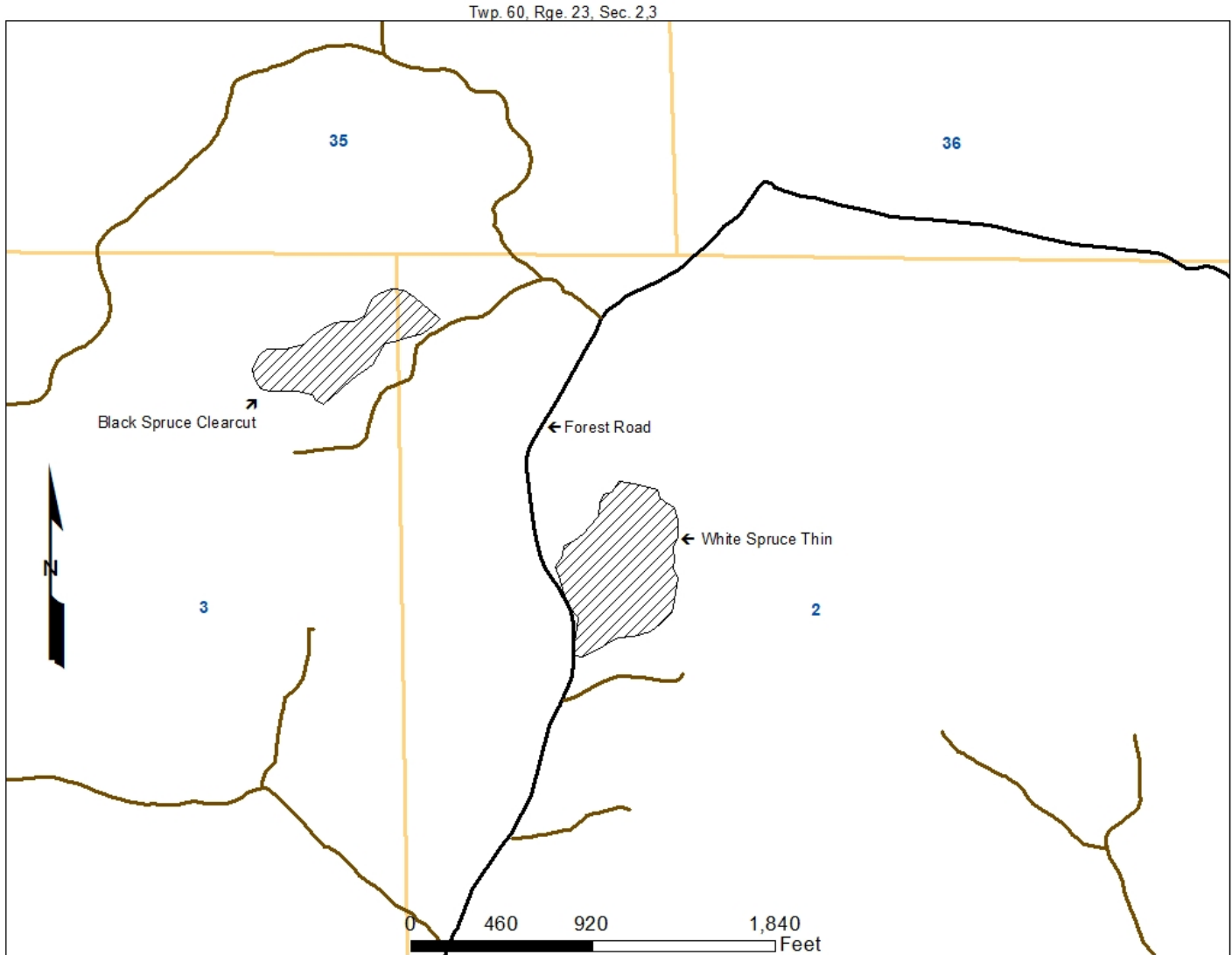

Appraisal examined and approved by \_\_\_\_\_ Forester \_\_\_\_\_ Date

Appraisal examined and approved by \_\_\_\_\_ Land Department \_\_\_\_\_ Date