

# Itasca County Timber Appraisal Report

<b>Appraised By:</b> Bob Rother  <b>Appraisal Date:</b> 09/10/2020	<b>Sale Type:</b> REGULAR AUCTION SALE  <b>Auction Date:</b> 12/07/2020	<b>Appraisal Number:</b> 20-01-13 <b>Permit Number:</b> <b>Expiration Date:</b> 03/01/2023 <b>Page:</b> 1 of 3
--	---	---

**Legal Description**

<u>RE Code</u>	<u>Sec.</u>	<u>Twp.</u>	<u>Rge.</u>	<u>City/Twp</u>	<u>Subd</u>
98-020-4100	20	54	23	Feeley	NE SE
98-020-4200	20	54	23	Feeley	NW SE
98-020-4400	20	54	23	Feeley	SE SE
98-029-1100	29	54	23	Feeley	NE NE LESS R/W & H/W

<u>Block 1 Species</u>	<u>Volume</u>	<u>Units</u>	<u>Unit Price</u>	<u>Value</u>	<u>Comments</u>	<u>Bolt %</u>	<u>Bid</u>
Aspen	550	Cords	\$23.00	\$12,650.00	4-6 Sticks, 7-15" DBH, Fair-Good Condition	15	^
Ash	135	Cords	\$11.00	\$1,485.00	2-5 Sticks, 7-14" DBH, Fair-Good Conditon	30	#
Balm	75	Cords	\$17.00	\$1,275.00	2-5 Sticks, 7-12" DBH, Fair Condition	0	^
Balsam Fir	40	Cords	\$6.00	\$240.00	2-6 Sticks, 7-12" DBH, Fair-Good Condition	15	*
				\$15,650.00	<b>Subtotal</b>		
<b>Total Cords =</b>	800	<b>Total MBF: 0</b>		\$15,650.00	<b>Total</b>		

Bid Symbols: ^ = Bid Species; # = Non-Bid Species; + = Sold Area Estimate; \* = Sold Area Estimate & Non-Bid Species  
 All species woodsrun unless listed otherwise.

**Species Scaled:** Ash , Aspen, Balm  
**Species SAE:** Balsam Fir

**Operability:** Winter Chance - Frozen Ground: 12/1 - 3/1      **Soil Type:** Morph very fine sandy loam  
**Topography:** Level to rolling      **Cutting Acres:** 30.8

All permits must follow Itasca County Forest Management Guidelines and Specifications (can be found at <http://www.co.itasca.mn.us/DocumentCenter/View/567/Forest-Management-Guidelines-and-Specifications> ).

**Harvest Specifications**

Comments
Harvest Type = Aspen Clearcut with Reserves, Ash Thin

Harvest and Reserves
Within Aspen Clearcuts: Reserve Oak, Cedar, Elm, Birch, 'R' painted trees, Ash and Balsam Fir less than 2 sticks, advanced regen patches, and all non-hazardous snags. Within pure Ash types: Reserve Ash less than 8" DBH and all other reserve species.

Access
Easement road must be used to access the timber sale. Access road must be kept in good condition, as determined by administering forester, at all times. 0.1 miles to public road County Road 10.

Landings and Access Roads
Location and construction of any new roads/landings must be pre-approved by the sale administrator. Use north approach to access block north of creek. Trails and landings need to be rehabilitated to a satisfactory condition, determined by administering forester, before performance bond is returned.

Cutting, Felling, and Skidding
Do not damage reserve trees. Property boundaries painted Orange Circle (oOo). Cutting boundaries painted Orange Slashes (III) or Natural.

## Itasca County Timber Appraisal Report

<b>Appraised By:</b> Bob Rother	<b>Sale Type:</b> REGULAR AUCTION SALE	<b>Appraisal Number:</b> 20-01-13
<b>Appraisal Date:</b> 09/10/2020	<b>Auction Date:</b> 12/07/2020	<b>Permit Number:</b> <b>Expiration Date:</b> 03/01/2023
		<b>Page:</b> 2 of 3

### Slash Disposal

Slash must be evenly distributed throughout permit area.  
 A 10 ft. wide slash free zone must be maintained along roads and trails.  
 Slash height must not exceed 3 ft. within view of road.

### Regeneration Plan

Natural Regeneration to Aspen species and Lowland Hardwoods

# Itasca County Timber Appraisal Report

<b>Appraised By:</b> Bob Rother	<b>Sale Type:</b> REGULAR AUCTION SALE	<b>Appraisal Number:</b> 20-01-13
<b>Appraisal Date:</b> 09/10/2020	<b>Auction Date:</b> 12/07/2020	<b>Permit Number:</b>
		<b>Expiration Date:</b> 03/01/2023
		<b>Page:</b> 3 of 3

**Site Map:**

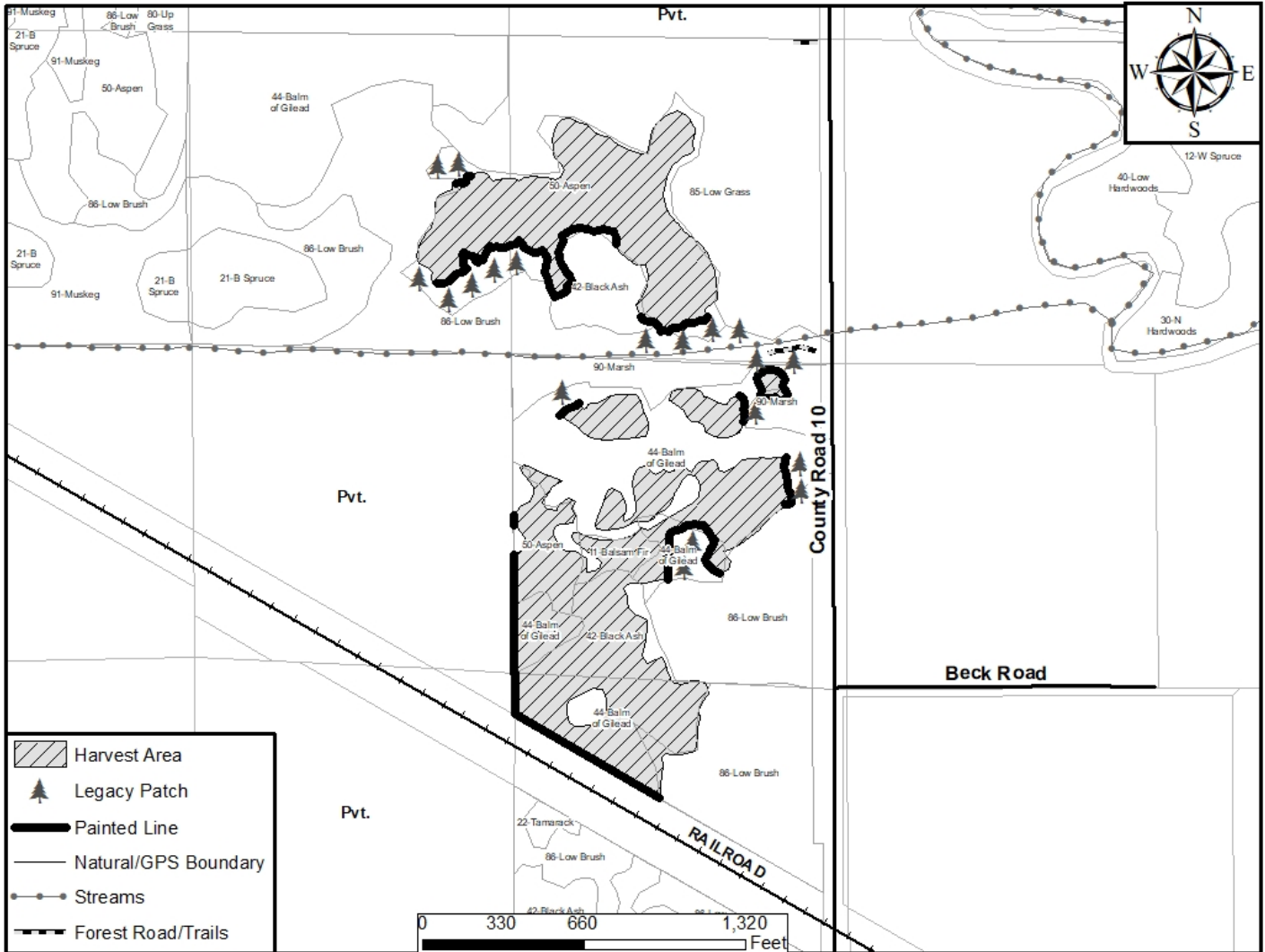

Appraisal examined and approved by \_\_\_\_\_ Forester \_\_\_\_\_ Date

Appraisal examined and approved by \_\_\_\_\_ Land Department \_\_\_\_\_ Date