

# Itasca County Timber Appraisal Report

<b>Appraised By:</b> Casey Dabrowski	<b>Sale Type:</b> REGULAR AUCTION SALE	<b>Appraisal Number:</b> 20-02-08
<b>Appraisal Date:</b> 10/22/2020	<b>Auction Date:</b> 12/07/2020	<b>Permit Number:</b>
		<b>Expiration Date:</b> 03/01/2023
		<b>Page:</b> 1 of 3

## Legal Description

<u>RE Code</u>	<u>Sec.</u>	<u>Twp.</u>	<u>Rge.</u>	<u>City/Twp</u>	<u>Subd</u>			
10-209-2000	9	62	24	Carpenter	NW 1/4			
10-208-1000	8	62	24	Carpenter	NE 1/4			
<u>Block 1 Species</u>	<u>Volume</u>	<u>Units</u>	<u>Unit Price</u>	<u>Value</u>	<u>Comments</u>	<u>Bolt %</u>	<u>Bid</u>	
Aspen	1,120	Cords	\$26.00	\$29,120.00	5-16", 3-8 st, Good.	5	^	
Paper Birch	65	Cords	\$11.00	\$715.00	7-10", 3-5 st, Fair.	10	#	
Balsam Fir	40	Cords	\$9.00	\$360.00	8-13", 4-6 st, Fair. Optional.	30	#	
Ash	15	Cords	\$8.00	\$120.00	6-8", 3-5 st, Fair.	0	#	
Balm	5	Cords	\$17.00	\$85.00	8-12", 3-5 st, Poor.	0	#	
				\$30,400.00	<b>Subtotal</b>			
<b>Total Cords =</b>	1,245		<b>Total MBF: 0</b>	\$30,400.00	<b>Total</b>			

Bid Symbols: ^ = Bid Species; # = Non-Bid Species; + = Sold Area Estimate; \* = Sold Area Estimate & Non-Bid Species  
All species woodsrun unless listed otherwise.

**Species Scaled:** Ash , Aspen, Balm , Balsam Fir, Paper Birch

**Species SAE:**

<b>Operability:</b>	Summer - Dry soil conditions: 7/1 - 10/1, Winter - Frozen ground: 12/1 - 3/1	<b>Soil Type:</b>	Nashwauk-Menahga Complex
<b>Topography:</b>	Level to rolling	<b>Cutting Acres:</b>	42.9

All permits must follow Itasca County Forest Management Guidelines and Specifications (can be found at <http://www.co.itasca.mn.us/DocumentCenter/View/567/Forest-Management-Guidelines-and-Specifications> ).

## Harvest Specifications

<u>Comments</u>
Harvest type: clearcut with reserves.

<u>Harvest and Reserves</u>
Harvest: cut all aspen, ash, and balm; balsam fir 8" and over, and excess birch stems.
Reserve: balsam under 8", all maple, spruce, and oak. Retain well-formed birch spaced 100' where no other reserves exist.
Reserve all non-hazardous snags.
Trees marked with "R" are to be reserved for wildlife.

<u>Access</u>
Gates must remain locked during hunting season.
Gravel pit road must be used to access the timber sale. Access road must be kept in good condition, as determined by administering forester, at all times. Equipment operation and/or log landing will not be allowed on the road.

<u>Landings and Access Roads</u>
Location and construction of new landings must be pre-approved by the sale administrator.
Timber sale administrator shall be notified at least 3 working days prior to completion of hauling and road work. This provides adequate time for permit area inspection and addressing of permit compliance requirements before hauling and road work equipment is removed.

# Itasca County Timber Appraisal Report

<b>Appraised By:</b> Casey Dabrowski	<b>Sale Type:</b> REGULAR AUCTION SALE	<b>Appraisal Number:</b> 20-02-08
<b>Appraisal Date:</b> 10/22/2020	<b>Auction Date:</b> 12/07/2020	<b>Permit Number:</b>
		<b>Expiration Date:</b> 03/01/2023
		<b>Page:</b> 2 of 3

## Cutting, Felling, and Skidding

Do not damage reserve trees.

Do not disturb survey markers, including witness trees, which have been painted orange.

Sale boundaries painted with orange lines (I I I); ownership boundaries painted with orange circles (O O O). Natural boundaries are also used; see sale map.

## Site, Soil, and Water Protection

Filter strips require <5% soil disturbance within 50' of all wetlands.

## Slash Disposal

Slash must be evenly distributed throughout permit area.

Slash height must not exceed 3 ft. within view of road.

## Regeneration Plan

Natural aspen regeneration.

# Itasca County Timber Appraisal Report

**Appraised By:**  
Casey Dabrowski  
**Appraisal Date:**  
10/22/2020

**Sale Type:**  
REGULAR AUCTION SALE  
**Auction Date:**  
12/07/2020

**Appraisal Number:** 20-02-08  
**Permit Number:**  
**Expiration Date:** 03/01/2023  
**Page:** 3 of 3

## Site Map:

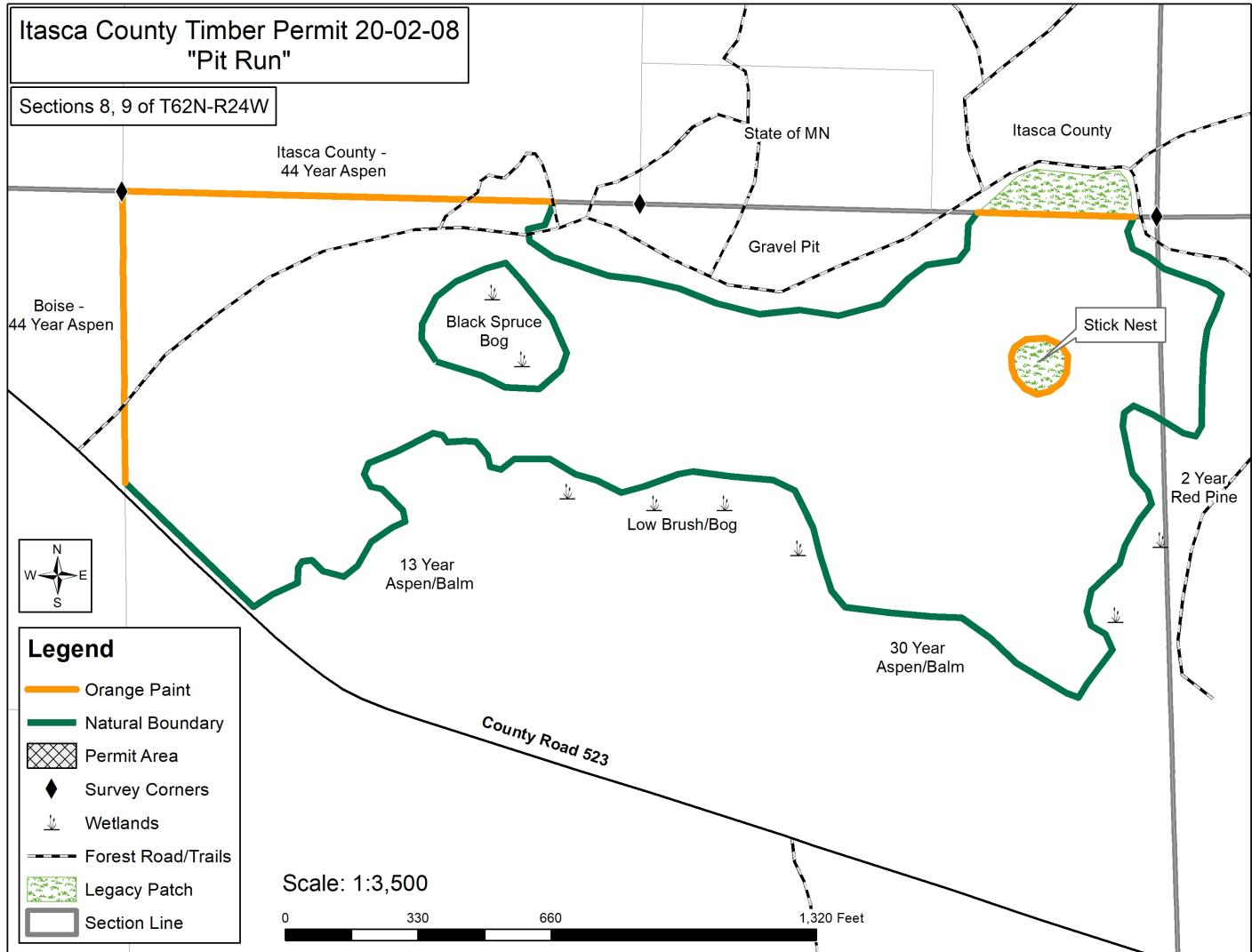

Appraisal examined and approved by \_\_\_\_\_  
Forester Date

Appraisal examined and approved by \_\_\_\_\_  
Land Department Date