

Itasca County Timber Appraisal Report

Appraised By:
Casey Dabrowski
Appraisal Date:
10/20/2020

Sale Type:
INTERMEDIATE AUCTION
Auction Date:
12/07/2020

Appraisal Number: 20-02-09
Permit Number:
Expiration Date: 03/01/2023
Page: 1 of 2

Legal Description

RE Code	Sec.	Twp.	Rge.	City/Twp	Subd
72-026-2000	26	62	27	Unorganized	NW 1/4
72-026-4100	26	62	27	Unorganized	NE SE
72-026-4200	26	62	27	Unorganized	NW SE
72-026-1000	26	62	27	Unorganized	NE 1/4
72-026-3000	26	62	27	Unorganized	SW 1/4

Block 1 Species	Volume	Units	Unit Price	Value	Comments	Bolt %	Bid
Spruce	534	Cords	\$10.00	\$5,340.00	5-9", 2-4 st, Fair.	15	^
Aspen	128	Cords	\$12.00	\$1,536.00	5-7", 3-4 st, Fair.	0	^
Balm	39	Cords	\$12.00	\$468.00	5-7", 3-4 st, Fair.	0	^
Tamarack	20	Cords	\$6.00	\$120.00	5-8", 2-4 st, Fair.	0	#
Ash	2	Cords	\$7.00	\$14.00	5-7", 3-4 st, Fair.	0	#
				\$7,478.00	Subtotal		
Total Cords =	723	Total MBF: 0		\$7,478.00	Total		

Bid Symbols: ^ = Bid Species; # = Non-Bid Species; + = Sold Area Estimate; * = Sold Area Estimate & Non-Bid Species
All species woodsrun unless listed otherwise.

Species Scaled: Ash , Aspen, Balm , Spruce , Tamarack

Species SAE:

Operability: Winter - Frozen Ground: 12/1 - 3/1
Topography: Level
Soil Type: Effie Loam
Cutting Acres: 83.5

All permits must follow Itasca County Forest Management Guidelines and Specifications (can be found at <http://www.co.itasca.mn.us/DocumentCenter/View/567/Forest-Management-Guidelines-and-Specifications>).

Harvest Specifications

Comments
Harvest type: operator select 1st time spruce thin. Early winter opportunity in north block.

Landings and Access Roads
Trails and landings need to be rehabilitated to a satisfactory condition, determined by administering forester, before performance bond is returned. Timber sale administrator shall be notified at least 3 working days prior to completion of hauling and road work. This provides adequate time for permit area inspection and addressing of permit compliance requirements before hauling and road work equipment is removed.

Cutting, Felling, and Skidding
Timber must be processed at the stump. Cut 12 ft. access strips reserving 40 ft. in between strips for thinning. Thin stand down to an average of 90 basal area. Favor the removal of smaller diameter, poor quality, and damaged trees. Sale boundaries painted with orange lines (I I I). Natural boundaries are also used; see sale map.

Site, Soil, and Water Protection
Do not cross the drainages shown between blocks on sale map. Cross only using existing road. Filter strips require <5% soil disturbance within 50' of all wetlands.

Itasca County Timber Appraisal Report

Appraised By:
Casey Dabrowski
Appraisal Date:
10/20/2020

Sale Type:
INTERMEDIATE AUCTION
Auction Date:
12/07/2020

Appraisal Number: 20-02-09
Permit Number:
Expiration Date: 03/01/2023
Page: 2 of 2

Site Map:

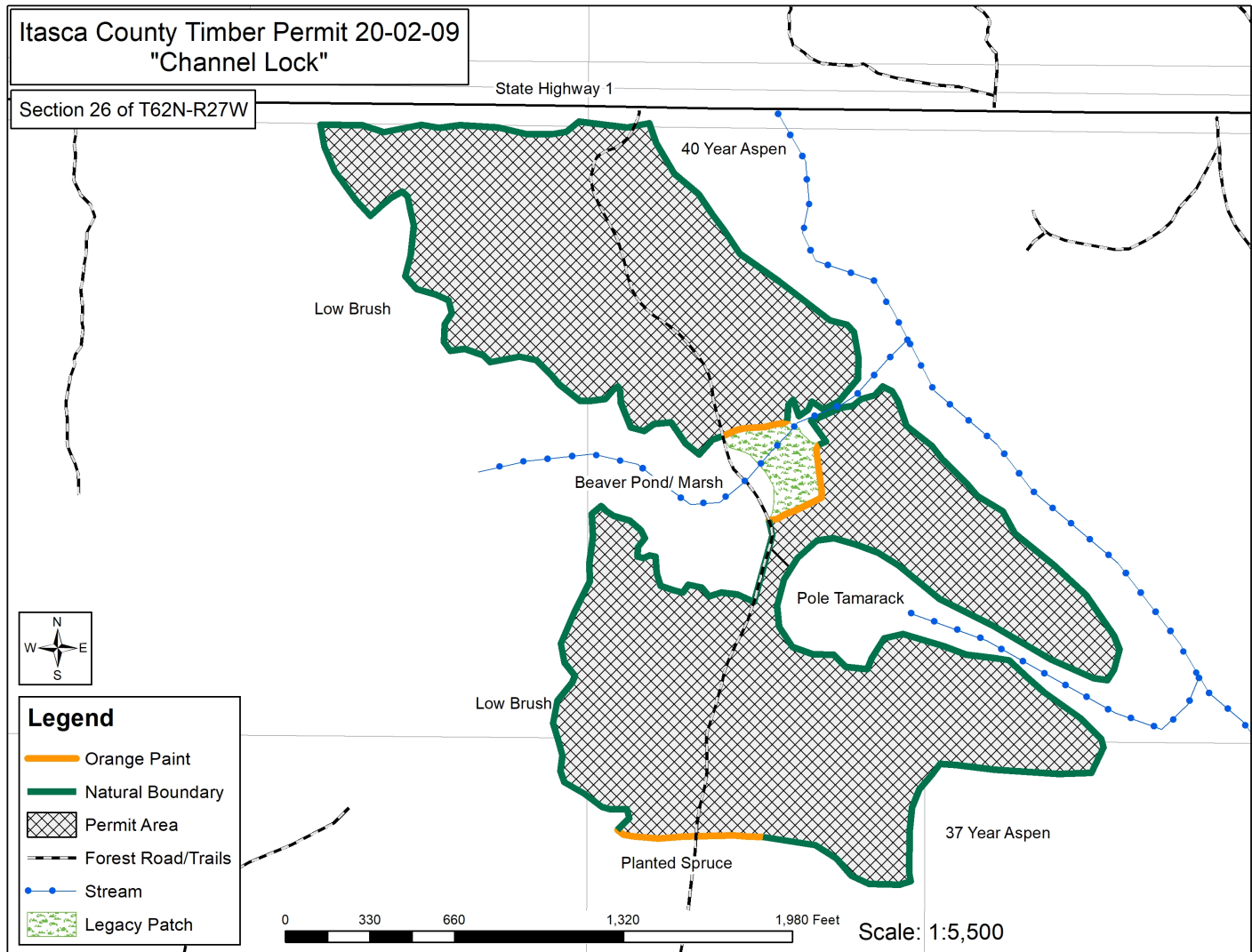

Appraisal examined and approved by _____
Forester Date

Appraisal examined and approved by _____
Land Department Date