

## Itasca County Timber Appraisal Report

**Appraised By:**  
Casey Dabrowski  
**Appraisal Date:**  
10/20/2020

**Sale Type:**  
REGULAR AUCTION SALE  
**Auction Date:**  
12/07/2020

**Appraisal Number:** 20-02-10  
**Permit Number:**  
**Expiration Date:** 03/01/2023  
**Page:** 1 of 3

**Legal Description**

<u>RE Code</u>	<u>Sec.</u>	<u>Twp.</u>	<u>Rge.</u>	<u>City/Twp</u>	<u>Subd</u>
72-024-2200	24	62	27	Unorganized	NW NW
72-024-2100	24	62	27	Unorganized	NE NW
72-024-1200	24	62	27	Unorganized	NW NE

<u>Block 1 Species</u>	<u>Volume</u>	<u>Units</u>	<u>Unit Price</u>	<u>Value</u>	<u>Comments</u>	<u>Bolt %</u>	<u>Bid</u>
Aspen	1,270	Cords	\$25.00	\$31,750.00	6-11", 4-7 st, Good.	5	^
Balm	15	Cords	\$17.00	\$255.00	6-9", 3-5 st, Good.	0	#
Spruce	12	Cords	\$18.00	\$216.00	5-7", 2-5 st, Poor. 100% Black.	0	#
				\$32,221.00	<b>Subtotal</b>		
<b>Total Cords =</b>	1,297		<b>Total MBF: 0</b>	\$32,221.00	<b>Total</b>		

Bid Symbols: ^ = Bid Species; # = Non-Bid Species; + = Sold Area Estimate; \* = Sold Area Estimate & Non-Bid Species  
All species woodsrun unless listed otherwise.

**Species Scaled:** Aspen, Balm, Spruce

**Species SAE:**

**Operability:** Winter - Frozen Ground: 12/1 - 3/1  
**Topography:** Level  
**Soil Type:** Effie Loam  
**Cutting Acres:** 32.2

All permits must follow Itasca County Forest Management Guidelines and Specifications (can be found at <http://www.co.itasca.mn.us/DocumentCenter/View/567/Forest-Management-Guidelines-and-Specifications> ).

**Harvest Specifications**

<b>Comments</b>
Harvest type: clearcut with reserves (3 blocks)

<b>Harvest and Reserves</b>
Harvest: Cut all aspen and balm. Reserves: all other species. Reserve all non-hazardous snags.

<b>Access</b>
Snowmobile trail regulations in Itasca County Forest Management Guideline & Specifications apply. A minimum of two inches of compacted snow must remain on the trail as a running surface. 1.5 miles to public road State Hwy 6.

<b>Landings and Access Roads</b>
Trails and landings need to be rehabilitated to a satisfactory condition, determined by administering forester, before performance bond is returned. Timber sale administrator shall be notified at least 3 working days prior to completion of hauling and road work. This provides adequate time for permit area inspection and addressing of permit compliance requirements before hauling and road work equipment is removed.

<b>Cutting, Felling, and Skidding</b>
Do not damage reserve trees. Do not disturb survey markers, including witness trees, which have been painted orange. Survey pipes exist within the roadway; use caution when opening road. Sale boundaries painted with orange lines (I I I). Ownership boundaries painted with orange circles (O O O). Natural boundaries are also used; see sale map.

**Itasca County Timber Appraisal Report**

**Appraised By:**  
Casey Dabrowski  
**Appraisal Date:**  
10/20/2020

**Sale Type:**  
REGULAR AUCTION SALE  
**Auction Date:**  
12/07/2020

**Appraisal Number:** 20-02-10  
**Permit Number:**  
**Expiration Date:** 03/01/2023  
**Page:** 2 of 3

**Slash Disposal**

Slash must be evenly distributed throughout permit area.

**Regeneration Plan**

Natural aspen regeneration.

# Itasca County Timber Appraisal Report

**Appraised By:**  
Casey Dabrowski  
**Appraisal Date:**  
10/20/2020

**Sale Type:**  
REGULAR AUCTION SALE  
**Auction Date:**  
12/07/2020

**Appraisal Number:** 20-02-10  
**Permit Number:**  
**Expiration Date:** 03/01/2023  
**Page:** 3 of 3

## Site Map:

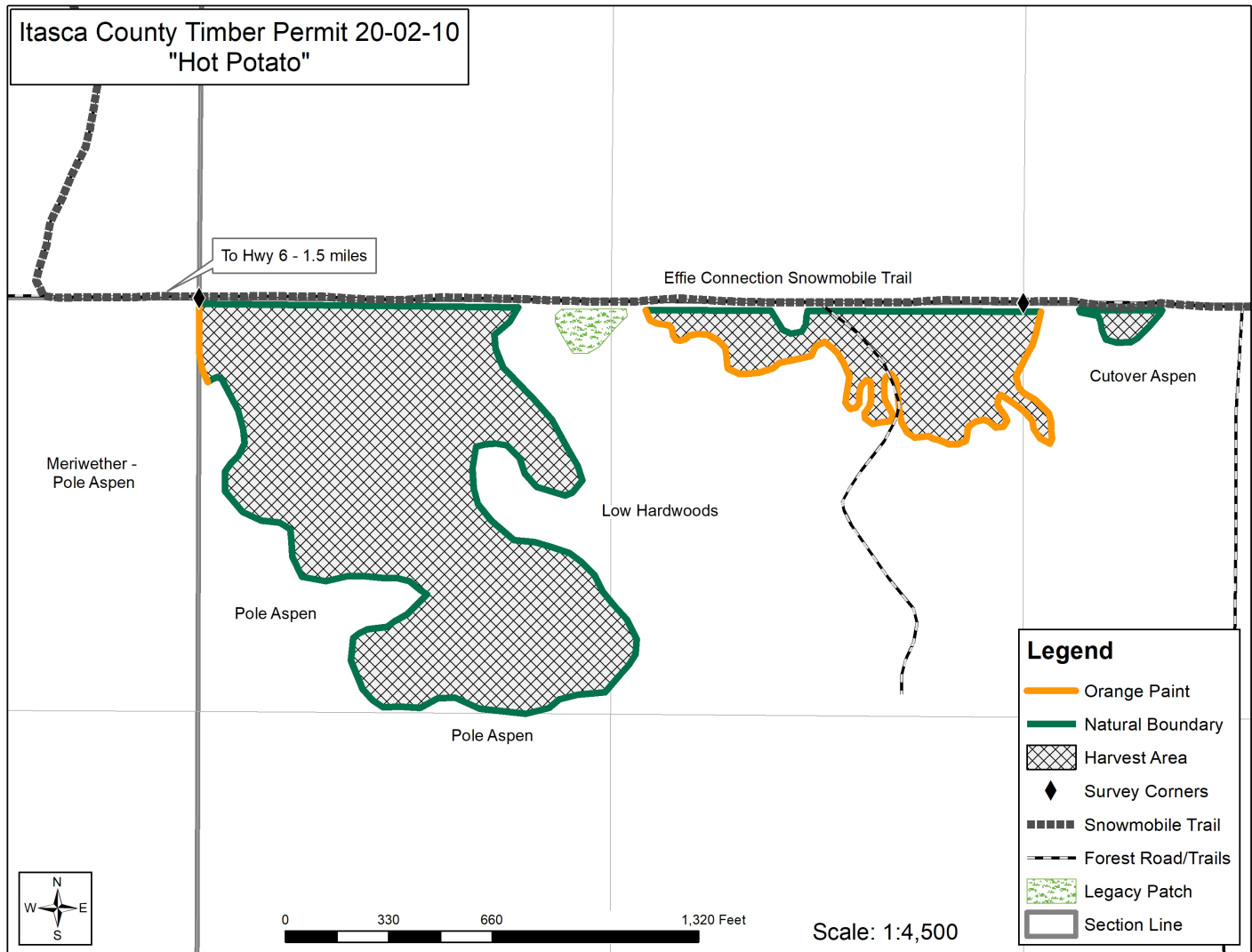

Appraisal examined and approved by \_\_\_\_\_  
Forester Date

Appraisal examined and approved by \_\_\_\_\_  
Land Department Date