

Itasca County Timber Appraisal Report

Appraised By: Tony Schram Appraisal Date: 06/25/2020	Sale Type: INTERMEDIATE AUCTION Auction Date: 12/07/2020	Appraisal Number: 20-06-15 Permit Number: Expiration Date: 03/01/2024 Page: 1 of 3
---	---	---

Legal Description

RE Code	Sec.	Twp.	Rge.	City/Twp	Subd		
39-009-4300	9	148	29	Third River	SW SE		
39-009-4400	9	148	29	Third River	SE SE		
Block 1 Species	Volume	Units	Unit Price	Value	Comments	Bolt %	Bid
Aspen	926	Cords	\$28.00	\$25,928.00	6-16" DBH, 3-7 sticks, good quality	30	^
Ash	16	Cords	\$10.00	\$160.00	6-16" DBH, 3-5 sticks, fair quality, 5% saw	15	#
Paper Birch	13	Cords	\$12.00	\$156.00	6-14" DBH, 2-5 sticks, good quality, 10% saw	30	#
Balm	13	Cords	\$18.00	\$234.00	8-15" DBH, 4-6 sticks, fair quality	15	#
Jack Pine	1	Cords	\$8.00	\$8.00	6-9" DBH, 2-3 sticks, poor quality	0	+
				\$26,486.00	Subtotal		
Total Cords =	969			Total MBF: 0	\$26,486.00	Total	

Bid Symbols: ^ = Bid Species; # = Non-Bid Species; + = Sold Area Estimate; * = Sold Area Estimate & Non-Bid Species
 All species woodsrun unless listed otherwise.

Species Scaled: Ash , Aspen, Balm , Paper Birch
Species SAE: Jack Pine

Operability: Dry Summer : 7-1 - 12-1, Frozen ground : 12-1 - 3-1 **Soil Type:** Rosy very fine sandy loam, Zimmerman loamy fine sand
Topography: Level **Cutting Acres:** 25.6

All permits must follow Itasca County Forest Management Guidelines and Specifications (can be found at <http://www.co.itasca.mn.us/DocumentCenter/View/567/Forest-Management-Guidelines-and-Specifications>).

Harvest Specifications

Comments
Harvest Type = Aspen clear-cut with reserves.

Harvest and Reserves
Reserve all non-hazardous snags.

Access
Sale immediately east of and adjacent to Will Paul Road (a public road).

Landings and Access Roads
Location and construction of any new roads/landings must be pre-approved by the sale administrator. Trails and landings need to be rehabilitated to a satisfactory condition, determined by administering forester, before performance bond is returned. Timber sale administrator shall be notified at least 3 working days prior to completion of hauling and road work. This provides adequate time for permit area inspection and addressing of permit compliance requirements before hauling and road work equipment is removed.

Itasca County Timber Appraisal Report

Appraised By: Tony Schram Appraisal Date: 06/25/2020	Sale Type: INTERMEDIATE AUCTION Auction Date: 12/07/2020	Appraisal Number: 20-06-15 Permit Number: Expiration Date: 03/01/2024 Page: 2 of 3
---	---	---

Cutting, Felling, and Skidding

Do not fell timber into wetlands or across sale boundaries.

Cut all aspen, ash, paper birch, balm of Gilead, and jack pine. Do not cut any other tree species or reserve trees marked with a blue "R". Leave as much advanced regeneration as possible.

The property boundary is painted with 3 orange circles (oOo); where trees are too small for paint, pink ribbons denote the property boundary. The cutting boundary is painted with 3 orange dashes (III). Legacy patches, not to be cut, are painted with 3 blue dashes (III); "END" is written at the start and end of each legacy patch.

Cut up to the beaver felled trees in the NE corner of the sale between the two legacy patches. Leave the beaver felled trees on site.

Site, Soil, and Water Protection

Filter strips require <5% soil disturbance within 50' of all wetlands.

Slash Disposal

Slash must be evenly distributed throughout permit area.

Regeneration Plan

Natural regeneration.

Itasca County Timber Appraisal Report

Appraised By: Tony Schram	Sale Type: INTERMEDIATE AUCTION	Appraisal Number: 20-06-15
Appraisal Date: 06/25/2020	Auction Date: 12/07/2020	Permit Number:
		Expiration Date: 03/01/2024
		Page: 3 of 3

Site Map:

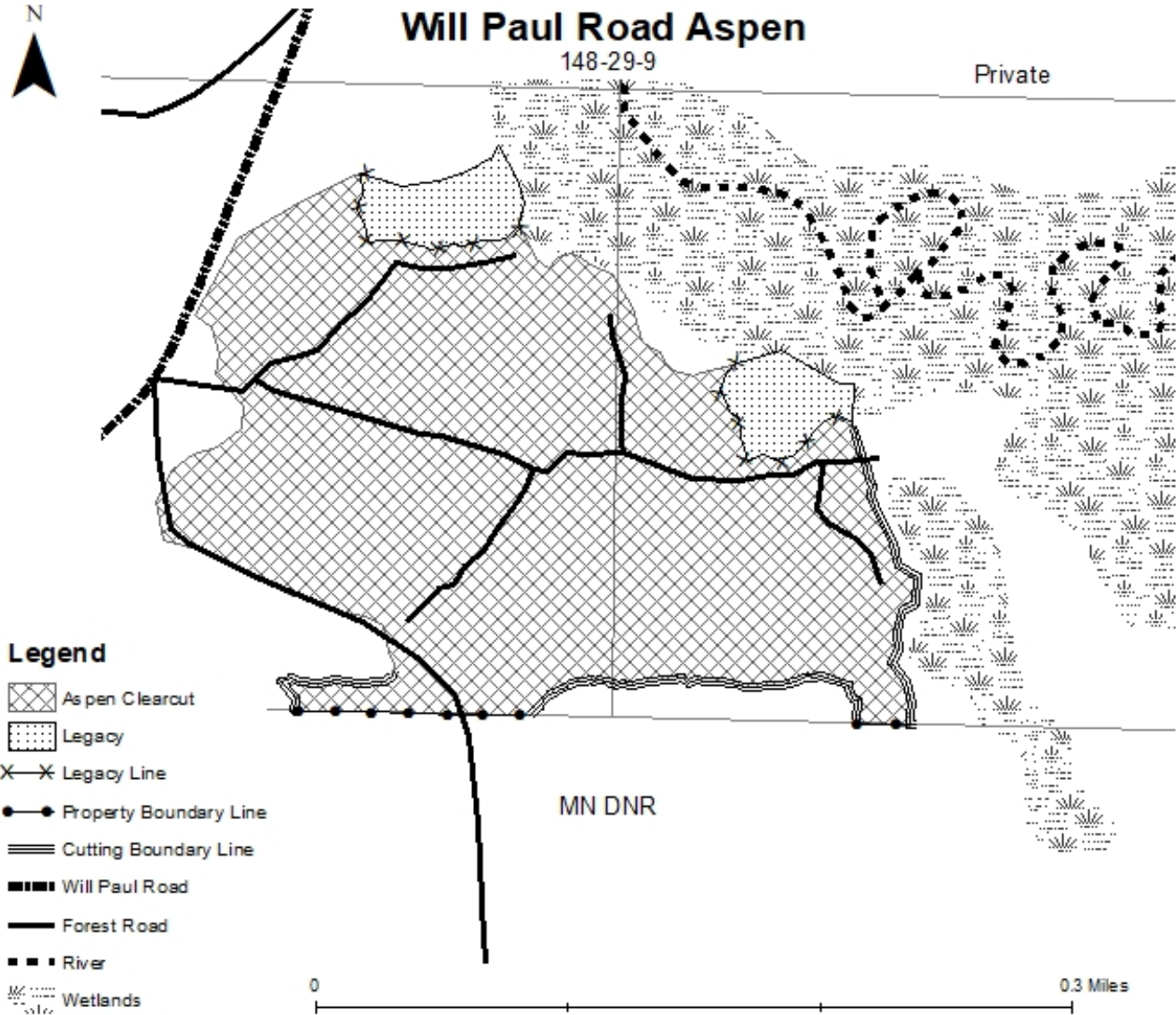

Appraisal examined and approved by _____
Forester
Date

Appraisal examined and approved by _____
Land Department
Date