

Itasca County Timber Appraisal Report

Appraised By: Jesse Lehner Appraisal Date: 05/26/2020	Sale Type: REGULAR AUCTION SALE Auction Date: 12/07/2020	Appraisal Number: 20-07-07 Permit Number: Expiration Date: 03/01/2024 Page: 1 of 3
------------------------------------------------------------------------------	---------------------------------------------------------------------------------	-------------------------------------------------------------------------------------------------------------------------

Legal Description

<u>RE Code</u>	<u>Sec.</u>	<u>Twp.</u>	<u>Rge.</u>	<u>City/Twp</u>	<u>Subd</u>		
97-003-3102	3	56	24	Iron Range	UND 22/48 INT NE SW		
97-003-3402	3	56	24	Iron Range	UND 22/48 INT SE SW		
97-003-4102	3	56	24	Iron Range	UND 22/48 INT NE SE		
97-003-4202	3	56	24	Iron Range	UND 22/48 INT NW SE		
<u>Block 1 Species</u>	<u>Volume</u>	<u>Units</u>	<u>Unit Price</u>	<u>Value</u>	<u>Comments</u>	<u>Bolt %</u>	<u>Bid</u>
Ash	517	Cords	\$8.00	\$4,136.00	3-5 stick, 5-15 inch Dbh, Fair quality	30	^
Aspen	12	Cords	\$8.00	\$96.00	3-5 stick, 7-14 inch Dbh, Fair quality	5	^
				\$4,232.00	Subtotal		
Total Cords =	529	Total MBF: 0		\$4,232.00	Total		

Bid Symbols: ^ = Bid Species; # = Non-Bid Species; + = Sold Area Estimate; * = Sold Area Estimate & Non-Bid Species
 All species woodsrun unless listed otherwise.

Species Scaled: Ash , Aspen

Species SAE:

Operability: Winter Frozen: 12/1 - 3/1 **Soil Type:** Mooselake and Lupton mucky peats
Topography: Flat **Cutting Acres:** 35.0

All permits must follow Itasca County Forest Management Guidelines and Specifications (can be found at <http://www.co.itasca.mn.us/DocumentCenter/View/567/Forest-Management-Guidelines-and-Specifications>).

Harvest Specifications

Comments
Harvest Type: Operator select thinning

Harvest and Reserves
Harvest aims to provide growing space for non-ash species within permit area. Reduce stand BA to 50-60 sqft/acre, focusing on the removal of ash and aspen species. Reserve all non-ash, non-aspen species. In addition, reserve one "plus" quality ash per acre to maintain genetics within harvest area. Plus ash trees are designated with an orange paint ring around individual trees. Standing residual BA may be left higher than above mentioned residual goals if all ash/aspen have been removed and residual stem are non-ash/aspen species. Reserve all non-hazardous snags. Trees marked with "R" are to be reserved for wildlife.

Landings and Access Roads
Location and construction of any new roads/landings must be pre-approved by the sale administrator. Temporary water/wetland crossing needed on one or more locations. Remove crossing when harvesting activity is completed. Timber sale administrator shall be notified at least 3 working days prior to completion of hauling and road work. This provides adequate time for permit area inspection and addressing of permit compliance requirements before hauling and road work equipment is removed.

Cutting, Felling, and Skidding
Do not damage reserve trees. Do not fell timber across sale boundaries. Sale boundaries are painted with Orange paint.

Itasca County Timber Appraisal Report

Appraised By: Jesse Lehner	Sale Type: REGULAR AUCTION SALE	Appraisal Number: 20-07-07
Appraisal Date: 05/26/2020	Auction Date: 12/07/2020	Permit Number:
		Expiration Date: 03/01/2024
		Page: 2 of 3

Site, Soil, and Water Protection

If site/soil damage becomes apparent, alter or cease operations and contact sale administrator immediately.
Can cross creek/drainage in 1 location. All slash must be pulled from the creek and banks rehabilitated upon sale completion.

Slash Disposal

Slash must be evenly distributed throughout permit area.

Regeneration Plan

Natural Regeneration of all species currently found within the harvest area.

Itasca County Timber Appraisal Report

Appraised By: Jesse Lehner	Sale Type: REGULAR AUCTION SALE	Appraisal Number: 20-07-07
Appraisal Date: 05/26/2020	Auction Date: 12/07/2020	Permit Number:
		Expiration Date: 03/01/2024
		Page: 3 of 3

Site Map:

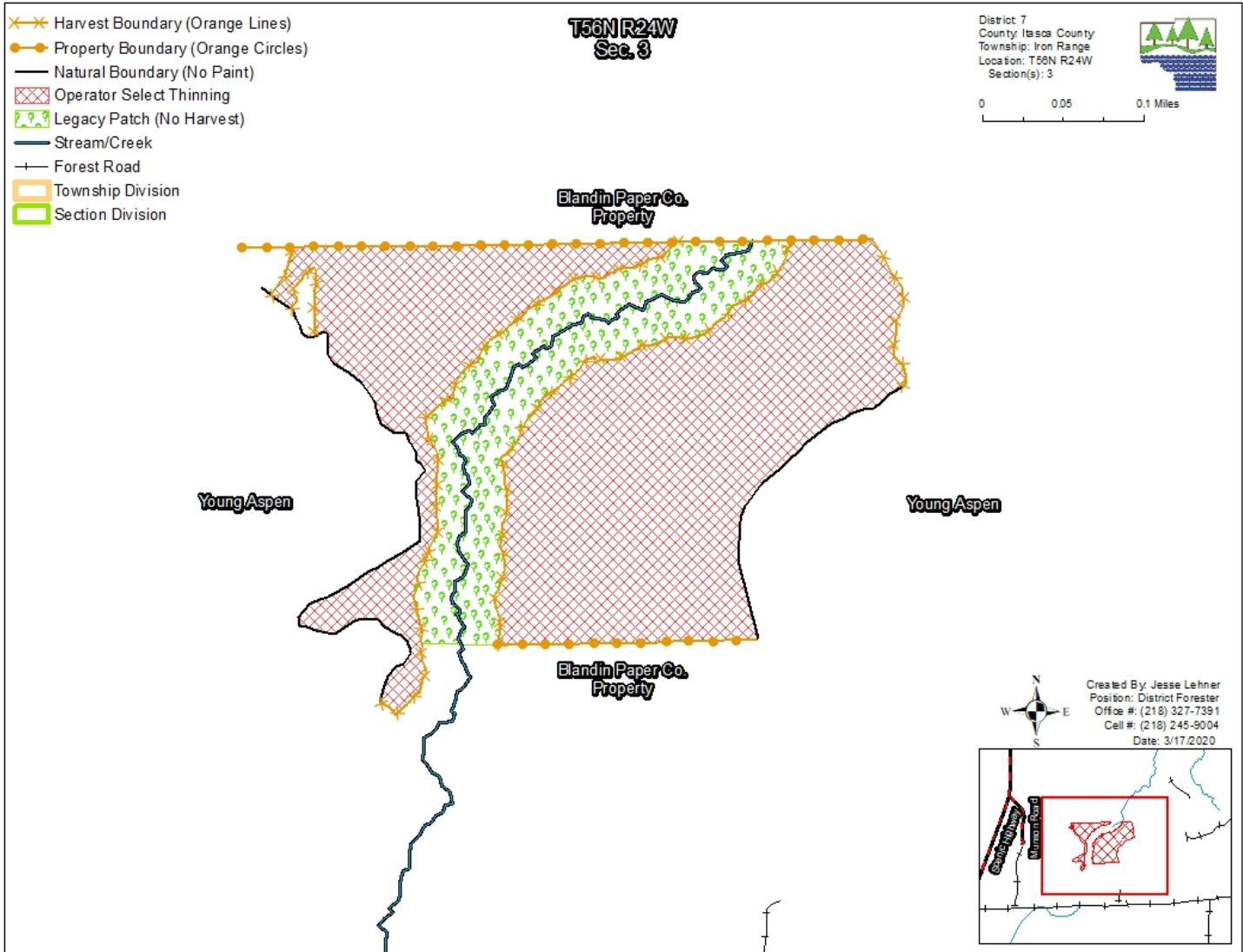

Appraisal examined and approved by _____
 Forester Date

Appraisal examined and approved by _____
 Land Department Date