

# Itasca County Timber Appraisal Report

<b>Appraised By:</b> Jesse Lehner  <b>Appraisal Date:</b> 08/28/2020	<b>Sale Type:</b> REGULAR AUCTION SALE  <b>Auction Date:</b> 12/07/2020	<b>Appraisal Number:</b> 20-07-09 <b>Permit Number:</b> <b>Expiration Date:</b> 03/01/2024 <b>Page:</b> 1 of 3
--	---	---

**Legal Description**

<u>RE Code</u>	<u>Sec.</u>	<u>Twp.</u>	<u>Rge.</u>	<u>City/Twp</u>	<u>Subd</u>		
63-006-3000	6	54	26	Unorganized	SW 1/4		
63-006-2000	6	54	26	Unorganized	NW 1/4		
68-001-0000	1	54	27	Unorganized	ALL OF SECTION 1		
<u>Block 1 Species</u>	<u>Volume</u>	<u>Units</u>	<u>Unit Price</u>	<u>Value</u>	<u>Comments</u>	<u>Bolt %</u>	<u>Bid</u>
Aspen	395	Cords	\$22.00	\$8,690.00	7-9 stick, 13-26 inch Dbh, Fair quality	5	^
Maple	170	Cords	\$8.00	\$1,360.00	2-6 stick, 6-12 inch Dbh, Fair-Poor quality	0	^
Basswood	98	Cords	\$8.00	\$784.00	10% saw, 3-5 stick, 7-10 inch Dbh, Fair quality	15	#
Red Oak	85	Cords	\$19.00	\$1,615.00	25% saw, 5-7 stick, 7-12 inch Dbh, Fair-Good quality	15	^
Paper Birch	52	Cords	\$14.00	\$728.00	50% saw, 5-7 stick, 14-19 inch Dbh, Fair-Good quality	20	#
Ash	7	Cords	\$8.00	\$56.00	3-5 stick, 7-12 inch Dbh, Fair quality	0	#
				\$13,233.00	<b>Subtotal</b>		
<b>Total Cords =</b>	<b>807</b>			<b>Total MBF: 0</b>	<b>\$13,233.00</b>	<b>Total</b>	

Bid Symbols: ^ = Bid Species; # = Non-Bid Species; + = Sold Area Estimate; \* = Sold Area Estimate & Non-Bid Species  
 All species woodsrun unless listed otherwise.

**Species Scaled:** Ash , Aspen, Basswood , Maple , Paper Birch , Red Oak

**Species SAE:**

**Operability:** Aspen removal/Marked hardwood thin: Winter frozen: 12/1 - 3/1, Oak Shelterwood: Dry summer: 7/1 - 10/1      **Soil Type:** Itasca-Goodland silt loams

**Topography:** Level to rolling      **Cutting Acres:** 38.6

All permits must follow Itasca County Forest Management Guidelines and Specifications (can be found at <http://www.co.itasca.mn.us/DocumentCenter/View/567/Forest-Management-Guidelines-and-Specifications> ).

**Harvest Specifications**

Comments
Harvest type: Aspen removal/Marked hardwood thin & Oak Shelterwood

Harvest and Reserves
Aspen removal/Marked hardwood thin: Cut all aspen and orange ringed hardwood species within sale boundaries. Reserve all non-marked species.
Oak shelterwood: Leave tree marking. Cut all non-marked stems, reserve all stems ringed with blue paint.

Access
Gate must be locked at all times, except on days when 3 or more loads are hauled.
Permit area is located approx. 4 miles from State Highway 6.

# Itasca County Timber Appraisal Report

<b>Appraised By:</b> Jesse Lehner <b>Appraisal Date:</b> 08/28/2020	<b>Sale Type:</b> REGULAR AUCTION SALE <b>Auction Date:</b> 12/07/2020	<b>Appraisal Number:</b> 20-07-09 <b>Permit Number:</b> <b>Expiration Date:</b> 03/01/2024 <b>Page:</b> 2 of 3
--	---	---

### Landings and Access Roads

Trails and landings need to be rehabilitated to a satisfactory condition, determined by administering forester, before performance bond is returned.  
 Roads and landings must be approved by sale administrator.  
 Timber sale administrator shall be notified at least 3 working days prior to completion of hauling and road work. This provides adequate time for permit area inspection and addressing of permit compliance requirements before hauling and road work equipment is removed.

### Cutting, Felling, and Skidding

Timber must be processed at the stump.  
 Do not damage reserve trees.  
 Do not fell timber into wetlands or across sale boundaries.  
 Do not disturb survey markers, including witness trees.  
 Harvest boundaries are painted with orange paint.

### Site, Soil, and Water Protection

Filter strips require <5% soil disturbance within 50' of all wetlands.  
 Roads and skid trails must be stabilized. This may involve installing water bars, strike outs, and/or mulching and seeding.

### Slash Disposal

Slash must be evenly distributed throughout permit area.

### Regeneration Plan

Natural Regeneration

# Itasca County Timber Appraisal Report

<b>Appraised By:</b> Jesse Lehner <b>Appraisal Date:</b> 08/28/2020	<b>Sale Type:</b> REGULAR AUCTION SALE <b>Auction Date:</b> 12/07/2020	<b>Appraisal Number:</b> 20-07-09 <b>Permit Number:</b> <b>Expiration Date:</b> 03/01/2024 <b>Page:</b> 3 of 3
--	---	---

**Site Map:**

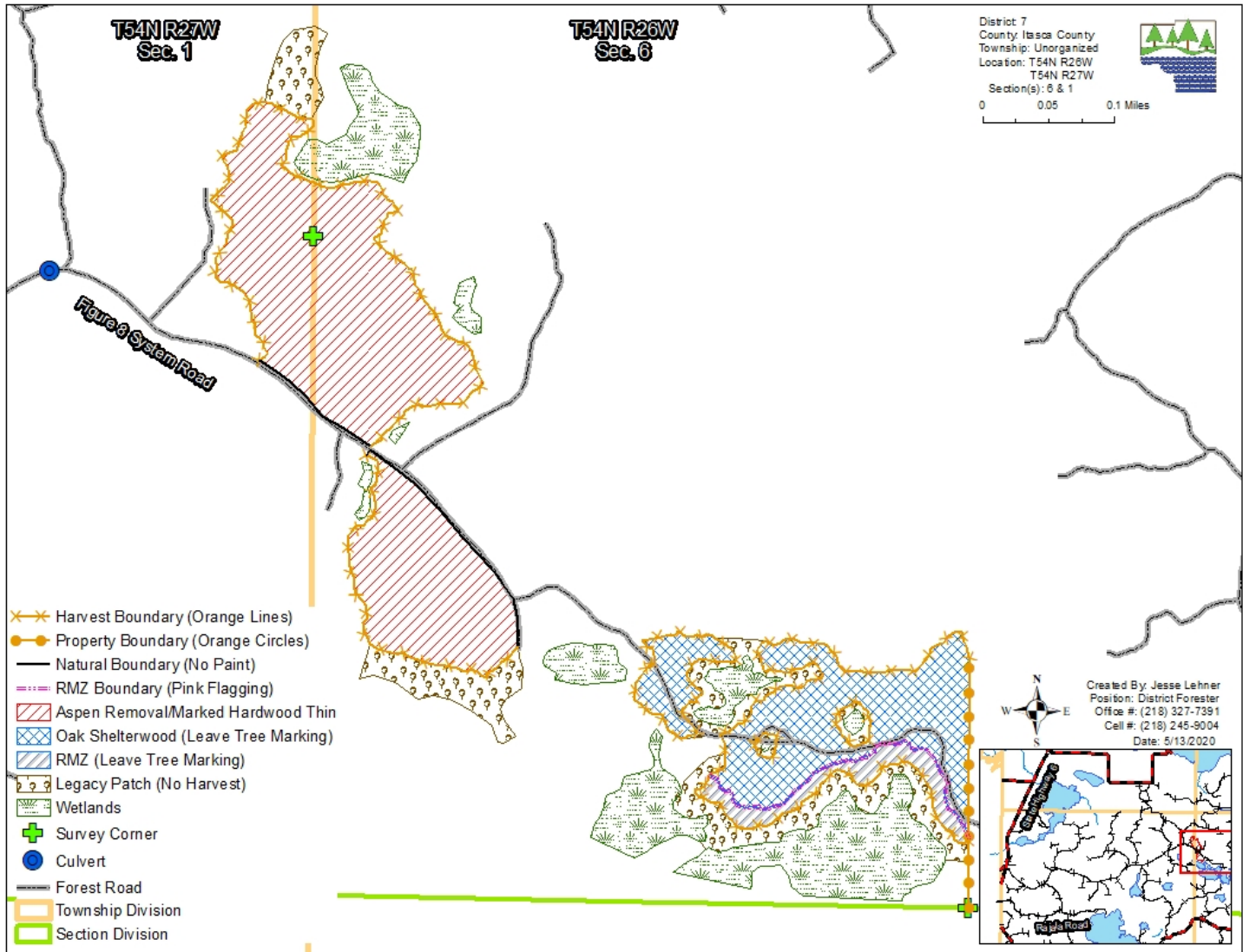

Appraisal examined and approved by \_\_\_\_\_ Forester \_\_\_\_\_ Date \_\_\_\_\_

Appraisal examined and approved by \_\_\_\_\_ Land Department \_\_\_\_\_ Date \_\_\_\_\_