

Itasca County Timber Appraisal Report

Appraised By: Jesse Lehner Appraisal Date: 09/18/2020	Sale Type: INTERMEDIATE AUCTION Auction Date: 12/07/2020	Appraisal Number: 20-07-11 Permit Number: Expiration Date: 03/01/2024 Page: 1 of 3
--	---	---

Legal Description

RE Code	Sec.	Twp.	Rge.	City/Twp	Subd		
14-129-3200	29	55	22	Goodland	NW SW		
14-129-3300	29	55	22	Goodland	SW SW		
14-130-0000	30	55	22	Goodland	ALL SECTION 30		

Block 1 Species	Volume	Units	Unit Price	Value	Comments	Bolt %	Bid
Maple	167	Cords	\$6.00	\$1,002.00	1-6 stick, 6-22 inch Dbh, Fair quality		^
Aspen	115	Cords	\$20.00	\$2,300.00	7-8 stick, 14-24 inch Dbh, Poor quality	5	^
Basswood	93	Cords	\$11.00	\$1,023.00	3-8 Stick, 12-24 inch Dbh, Good quality, 35% saw	20	#
Red Oak	65	Cords	\$19.00	\$1,235.00	2-8 stick, 9-24 inch Dbh, Good quality, 40% saw	15	^
Paper Birch	12	Cords	\$13.00	\$156.00	6-7 stick, 14-20 inch Dbh, Good quality, 45% saw	25	#
				\$5,716.00	Subtotal		
Total Cords =	452	Total MBF: 0		\$5,716.00	Total		

Bid Symbols: ^ = Bid Species; # = Non-Bid Species; + = Sold Area Estimate; * = Sold Area Estimate & Non-Bid Species
 All species woodsrun unless listed otherwise.

Species Scaled: Aspen, Basswood , Maple , Paper Birch , Red Oak

Species SAE:

Operability: Summer Dry: 7/1 - 10/1	Soil Type: Itasca-Goodland silt loams & Nashwauk fine sandy loams
Topography: Level to rolling	Cutting Acres: 37.5

All permits must follow Itasca County Forest Management Guidelines and Specifications (can be found at <http://www.co.itasca.mn.us/DocumentCenter/View/567/Forest-Management-Guidelines-and-Specifications>).

Harvest Specifications

Comments
Harvest type: Marked hardwood thin

Harvest and Reserves
Cut all stems ringed with orange paint. Reserve all non-hazardous snags. Trees marked with "R" are to be reserved for wildlife.

Access
Gate must be locked at all times, except on days when 3 or more loads are hauled.

Landings and Access Roads
Trails and landings need to be rehabilitated to a satisfactory condition, determined by administering forester, before performance bond is returned. Cross country ski trails are located within the permit area. Unless required, operator should avoid use of these roads as landings and with equipment. Roads and landings must be approved by sale administrator. Timber sale administrator shall be notified at least 3 working days prior to completion of hauling and road work. This provides adequate time for permit area inspection and addressing of permit compliance requirements before hauling and road work equipment is removed.

Itasca County Timber Appraisal Report

Appraised By: Jesse Lehner	Sale Type: INTERMEDIATE AUCTION	Appraisal Number: 20-07-11
Appraisal Date: 09/18/2020	Auction Date: 12/07/2020	Permit Number:
		Expiration Date: 03/01/2024
		Page: 2 of 3

Cutting, Felling, and Skidding

Timber must be processed at the stump.
Do not damage unmarked trees, regeneration, or reserve trees.
Sale boundaries painted with orange vertical lines.

Slash Disposal

Slash must be evenly distributed throughout permit area.

Regeneration Plan

Natural Regeneration

Itasca County Timber Appraisal Report

Appraised By: Jesse Lehner	Sale Type: INTERMEDIATE AUCTION	Appraisal Number: 20-07-11
Appraisal Date: 09/18/2020	Auction Date: 12/07/2020	Permit Number:
		Expiration Date: 03/01/2024
		Page: 3 of 3

Site Map:

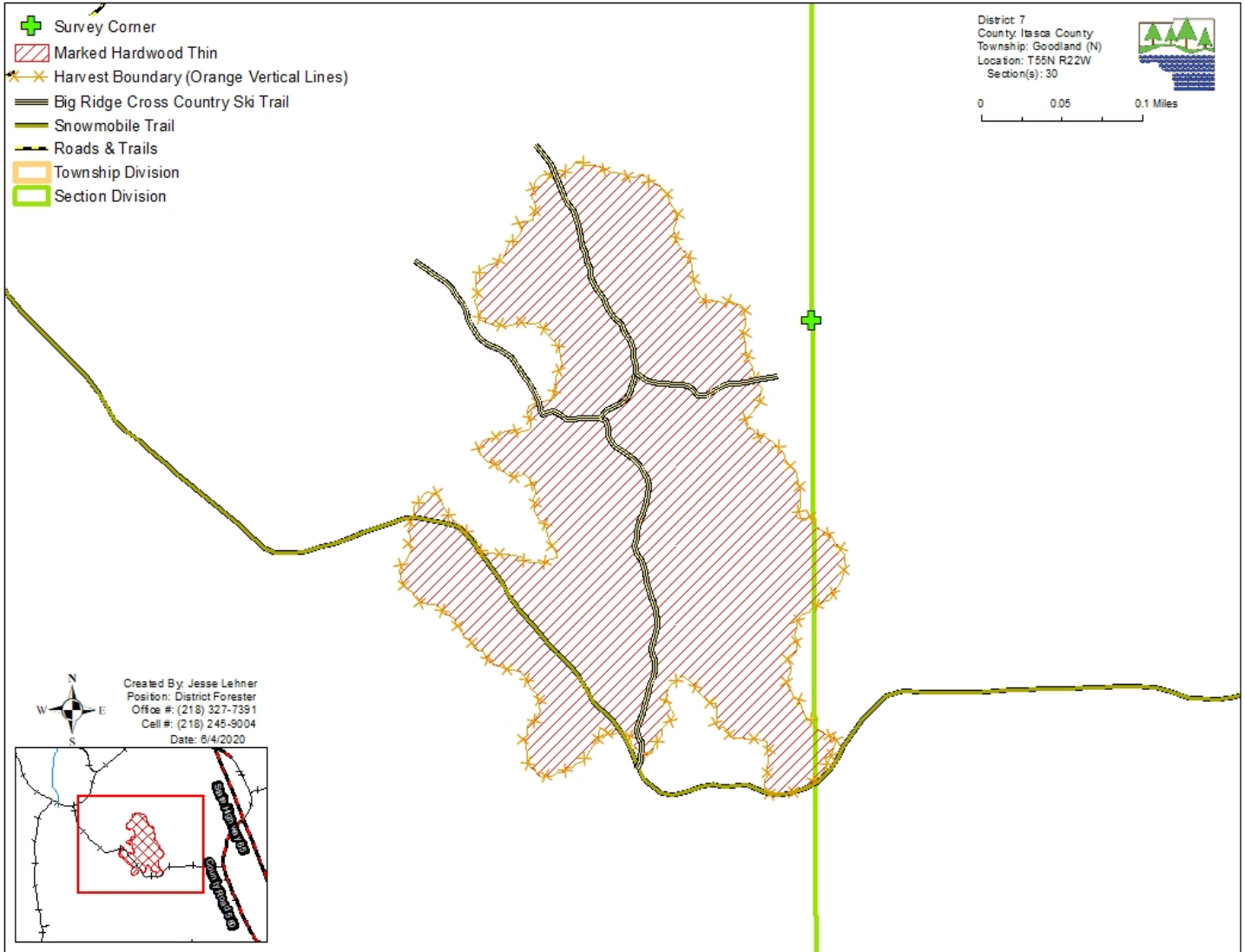

Appraisal examined and approved by _____
 Forester Date

Appraisal examined and approved by _____
 Land Department Date