

Itasca County Timber Appraisal Report

Appraised By: Jesse Lehner Appraisal Date: 10/12/2020	Sale Type: INTERMEDIATE AUCTION Auction Date: 12/07/2020	Appraisal Number: 20-07-15 Permit Number: Expiration Date: 03/01/2024 Page: 1 of 3
--	---	---

Legal Description

<u>RE Code</u>	<u>Sec.</u>	<u>Twp.</u>	<u>Rge.</u>	<u>City/Twp</u>	<u>Subd</u>		
14-110-3000	10	55	22	Goodland	SW 1/4		
14-115-2100	15	55	22	Goodland	NE NW		
<u>Block 1 Species</u>	<u>Volume</u>	<u>Units</u>	<u>Unit Price</u>	<u>Value</u>	<u>Comments</u>	<u>Bolt %</u>	<u>Bid</u>
Maple	130	Cords	\$8.00	\$1,040.00	1-5 stick, 7-20 Dbh, Fair condition		^
Paper Birch	79	Cords	\$17.00	\$1,343.00	2-7 stick, 9-19 Dbh, 30% saw, Fair condition	30	^
Red Oak	67	Cords	\$26.00	\$1,742.00	3-7 stick, 8-23 Dbh, 20% saw, Good condition	50	^
Aspen	38	Cords	\$20.00	\$760.00	8 stick, 22-27 Dbh, Poor condition		#
Basswood	19	Cords	\$14.00	\$266.00	6-8 stick, 14-20 Dbh, 35% saw, Good condition	20	#
				\$5,151.00	Subtotal		
Total Cords =	333	Total MBF: 0		\$5,151.00	Total		

Bid Symbols: ^ = Bid Species; # = Non-Bid Species; + = Sold Area Estimate; * = Sold Area Estimate & Non-Bid Species
 All species woodsrun unless listed otherwise.

Species Scaled: Aspen, Basswood , Maple , Paper Birch , Red Oak

Species SAE:

Operability: Dry summer: 7/1 - 10/1	Soil Type: Menahga-Itasca Complex
Topography: Level to rolling	Cutting Acres: 24.1

All permits must follow Itasca County Forest Management Guidelines and Specifications (can be found at <http://www.co.itasca.mn.us/DocumentCenter/View/567/Forest-Management-Guidelines-and-Specifications>).

Harvest Specifications

Comments
Harvest type: Marked Hardwood Thinning Re-offer

Harvest and Reserves
Cut all stems ringed with orange paint. Also, severe of run over Ironwood regeneration. Reserve all unmarked trees, non-hazardous snags and cavity trees. Trees marked with "R" are to be reserved for wildlife.

Access
Gate must be locked at all times, except on days when 3 or more loads are hauled. Gates must remain locked during hunting season. ATV trail regulations in Itasca County Forest Management Guideline & Specifications apply.

Landings and Access Roads
Location and construction of any new roads/landings must be pre-approved by the sale administrator. Trails and landings need to be rehabilitated to a satisfactory condition, determined by administering forester, before performance bond is returned. Timber sale administrator shall be notified at least 3 working days prior to completion of hauling and road work. This provides adequate time for permit area inspection and addressing of permit compliance requirements before hauling and road work equipment is removed.

Itasca County Timber Appraisal Report

Appraised By: Jesse Lehner Appraisal Date: 10/12/2020	Sale Type: INTERMEDIATE AUCTION Auction Date: 12/07/2020	Appraisal Number: 20-07-15 Permit Number: Expiration Date: 03/01/2024 Page: 2 of 3
--	---	---

Cutting, Felling, and Skidding

Timber must be processed at the stump.
 Do not damage unmarked trees, regeneration, or reserve trees.
 Do not fell timber into wetlands or across sale boundaries.
 Sale boundaries painted with orange vertical lines.

Site, Soil, and Water Protection

Filter strips require <5% soil disturbance within 50' of all wetlands.

Slash Disposal

Slash must be evenly distributed throughout permit area.

Regeneration Plan

Natural Regeneration of current trees species diversity.

Itasca County Timber Appraisal Report

Appraised By: Jesse Lehner Appraisal Date: 10/12/2020	Sale Type: INTERMEDIATE AUCTION Auction Date: 12/07/2020	Appraisal Number: 20-07-15 Permit Number: Expiration Date: 03/01/2024 Page: 3 of 3
--	---	---

Site Map:

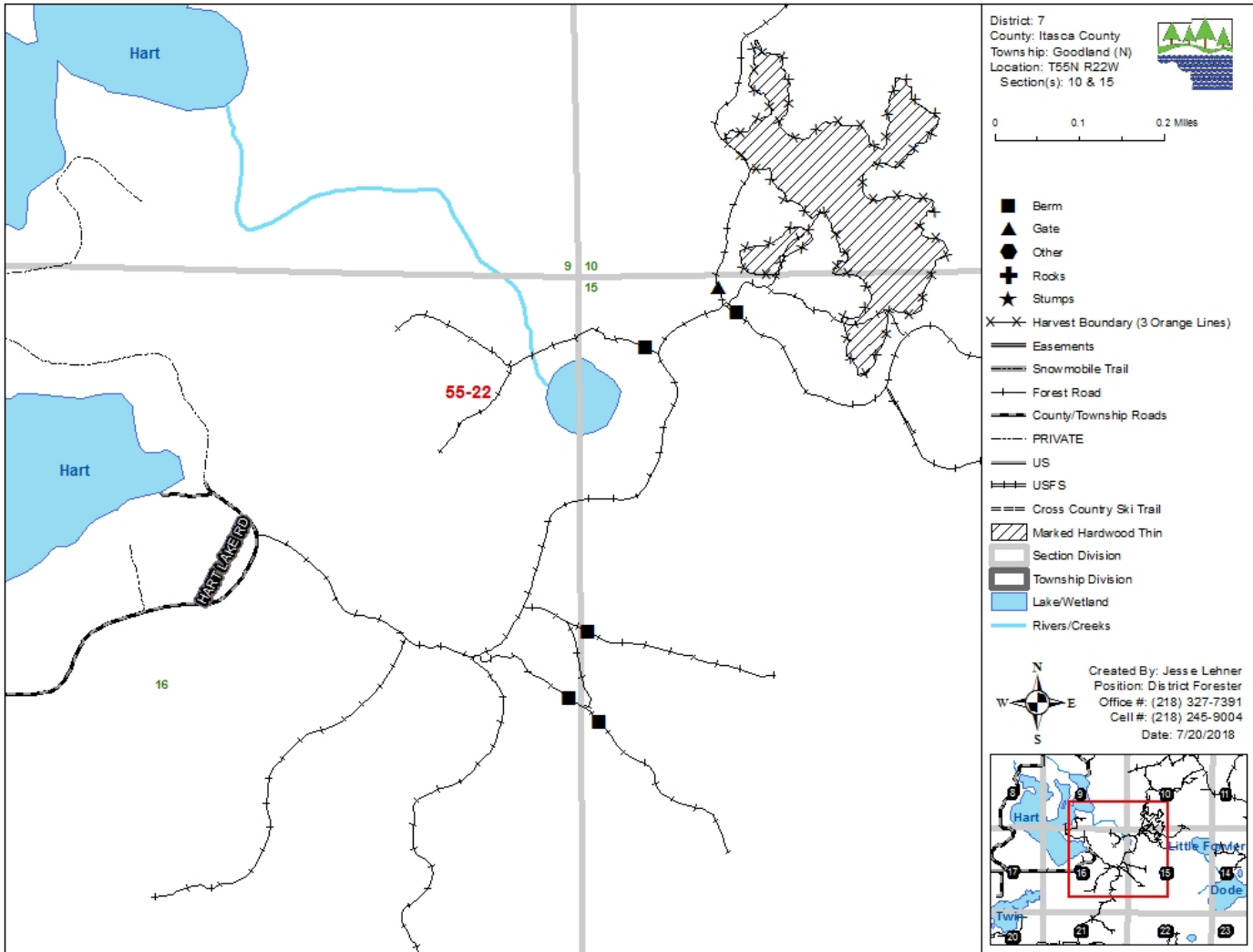

Appraisal examined and approved by _____ Forester _____ Date _____

Appraisal examined and approved by _____ Land Department _____ Date _____