

Itasca County Timber Appraisal Report

Appraised By: Casey Dabrowski	Sale Type: REGULAR AUCTION SALE	Appraisal Number: 21-02-02
Appraisal Date: 01/07/2021	Auction Date: 06/09/2021	Permit Number:
		Expiration Date: 03/01/2024
		Page: 1 of 3

Legal Description

<u>RE Code</u>	<u>Sec.</u>	<u>Twp.</u>	<u>Rge.</u>	<u>City/Twp</u>	<u>Subd</u>		
10-105-3400	5	62	23	Carpenter	SE SW		
10-105-3300	5	62	23	Carpenter	SW SW		
<u>Block 1 Species</u>	<u>Volume</u>	<u>Units</u>	<u>Unit Price</u>	<u>Value</u>	<u>Comments</u>	<u>Bolt %</u>	<u>Bid</u>
Red Pine	1,045	Cords	\$50.00	\$52,250.00	10-28", 5-9 st, 65% saw, Good.	25	^
Paper Birch	151	Cords	\$11.00	\$1,661.00	8-13", 3-6 st, Fair.	5	#
Jack Pine	125	Cords	\$29.00	\$3,625.00	7-12", 4-6 st, Fair.	60	^
White Pine	119	Cords	\$22.00	\$2,618.00	15-25", 4-8 st, 25% saw, Fair.	15	#
Balsam Fir	51	Cords	\$8.00	\$408.00	6-10", 2-5 st, Good.	20	#
Aspen	33	Cords	\$27.00	\$891.00	6-14", 4-6 st, Poor.	0	#
Spruce	12	Cords	\$20.00	\$240.00	7-12", 3-7 st, Good. 10% black spruce.	50	#
				\$61,693.00	Subtotal		
Total Cords =	1,536			Total MBF: 0	\$61,693.00	Total	

Bid Symbols: ^ = Bid Species; # = Non-Bid Species; + = Sold Area Estimate; * = Sold Area Estimate & Non-Bid Species
All species woodsrun unless listed otherwise.

Species Scaled: Aspen, Balsam Fir, Jack Pine, Paper Birch , Red Pine, Spruce , White Pine

Species SAE:

Operability:	Summer - Dry ground conditions: 6/1 - 3/1	Soil Type:	Menahga & Graycalm sands
Topography:	Level to rolling	Cutting Acres:	35.5

All permits must follow Itasca County Forest Management Guidelines and Specifications (can be found at <http://www.co.itasca.mn.us/DocumentCenter/View/567/Forest-Management-Guidelines-and-Specifications>).

Harvest Specifications

Comments
Harvest type: clearcut with reserves.
Northwest boundary grades to peat aspen/cedar and will need to be dry for access; the remainder is sandy.

Harvest and Reserves
Reserve all non-hazardous snags.
Harvest: Cut all non-painted timber.
Reserve: all reserve trees have been painted with orange "R--R" marks.

Access
3.9 miles to public road Co Rd 541.

Landings and Access Roads
Location and construction of any new roads/landings must be pre-approved by the sale administrator.
No skidding or equipment operation will be allowed on either existing roads.
Timber sale administrator shall be notified at least 3 working days prior to completion of hauling and road work. This provides adequate time for permit area inspection and addressing of permit compliance requirements before hauling and road work equipment is removed.

Itasca County Timber Appraisal Report

Appraised By:
Casey Dabrowski
Appraisal Date:
01/07/2021

Sale Type:
REGULAR AUCTION SALE
Auction Date:
06/09/2021

Appraisal Number: 21-02-02
Permit Number:
Expiration Date: 03/01/2024
Page: 2 of 3

Cutting, Felling, and Skidding

Do not damage reserve trees, which have been painted with orange "R--R" marks.

Do not fell timber across sale boundaries.

Do not disturb survey markers, including witness trees, which have been painted orange.

Sale boundaries painted with orange lines (I I I), ownership boundaries painted with orange circles (O O O). Natural boundaries are also used; see sale map.

Slash Disposal

Slash may be evenly spread across harvest area or piled at administrator approved locations. 20% of tops and limbs must be scattered throughout the permit area per Site Level Forest Management Guideline. The 20% is in addition to incidental breakage.

Special Conditions

Logging season may be restricted to August through February during high bark beetle risk. All cut pine must be hauled within 3 weeks during June through August.

Regeneration Plan

Site is to be planted with red pine.

Itasca County Timber Appraisal Report

Appraised By:
Casey Dabrowski
Appraisal Date:
01/07/2021

Sale Type:
REGULAR AUCTION SALE
Auction Date:
06/09/2021

Appraisal Number: 21-02-02
Permit Number:
Expiration Date: 03/01/2024
Page: 3 of 3

Site Map:

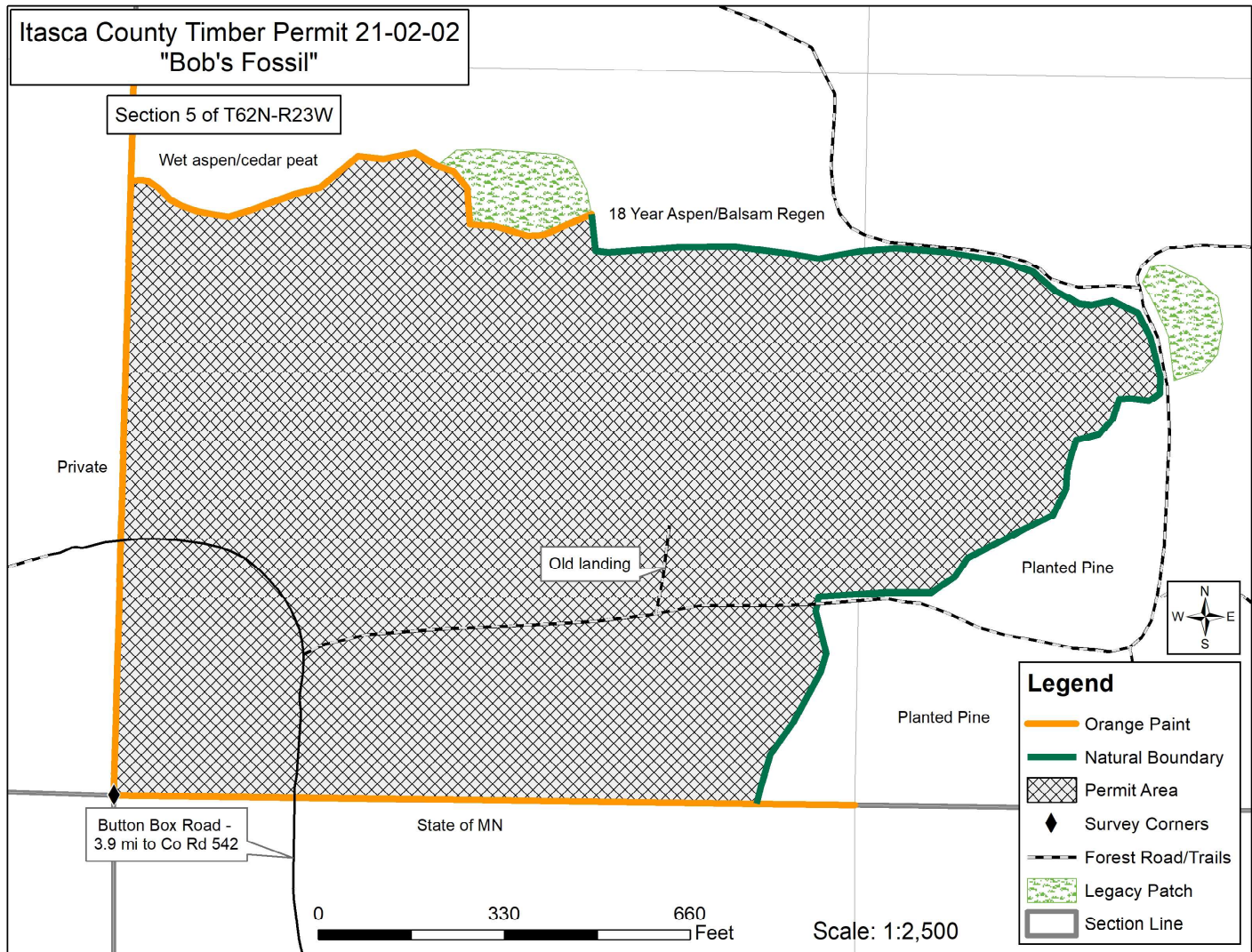

Appraisal examined and approved by _____
Forester Date

Appraisal examined and approved by _____
Land Department Date