

Itasca County Timber Appraisal Report

Appraised By: Casey Dabrowski	Sale Type: REGULAR AUCTION SALE	Appraisal Number: 21-02-03
Appraisal Date: 02/11/2021	Auction Date: 06/09/2021	Permit Number:
		Expiration Date: 03/01/2024
		Page: 1 of 3

Legal Description

<u>RE Code</u>	<u>Sec.</u>	<u>Twp.</u>	<u>Rge.</u>	<u>City/Twp</u>	<u>Subd</u>			
10-022-3100	22	62	22	Carpenter	NE SW			
10-022-3200	22	62	22	Carpenter	NW SW			
10-021-4000	21	62	22	Carpenter	SE 1/4			
10-021-1000	21	62	22	Carpenter	NE 1/4			
10-022-2300	22	62	22	Carpenter	SW NW			
10-022-2400	22	62	22	Carpenter	SE NW			
<u>Block 1 Species</u>	<u>Volume</u>	<u>Units</u>	<u>Unit Price</u>	<u>Value</u>	<u>Comments</u>	<u>Bolt %</u>	<u>Bid</u>	
Aspen	2,031	Cords	\$25.00	\$50,775.00	8-20", 5-8 st, Good.	5	^	
Balm	103	Cords	\$17.00	\$1,751.00	6-12", 3-5 st, Poor.	0	^	
Ash	75	Cords	\$9.00	\$675.00	5-12", 3-5 st, Fair.	0	#	
				\$53,201.00	Subtotal			
Total Cords =	2,209		Total MBF: 0	\$53,201.00	Total			

Bid Symbols: ^ = Bid Species; # = Non-Bid Species; + = Sold Area Estimate; * = Sold Area Estimate & Non-Bid Species
All species woodsrun unless listed otherwise.

Species Scaled: Ash , Aspen, Balm

Species SAE:

Operability:	Winter - Frozen Ground: 12/1 - 3/1	Soil Type:	Effie Loam, Wildwood Muck
Topography:	Level	Cutting Acres:	58.2

All permits must follow Itasca County Forest Management Guidelines and Specifications (can be found at <http://www.co.itasca.mn.us/DocumentCenter/View/567/Forest-Management-Guidelines-and-Specifications>).

Harvest Specifications

<u>Comments</u>
Harvest type: Aspen clearcut with reserves.

<u>Harvest and Reserves</u>
Harvest: Cut all aspen, ash, and balm.
Reserve: Reserve all balsam, elm, spruce, pine, maple, cedar, basswood; and low hardwood advance regeneration in low brush patches.
Trees marked with "R" are to be reserved for wildlife.

<u>Access</u>
2.2 miles to public road Co Rd 541.
Survey pipes exist in the forest road and must be protected during roadwork.
State / Private must be crossed to access timber sale. Logger must obtain permits/permission from land owner/manager.

<u>Landings and Access Roads</u>
Location and construction of any new roads/landings must be pre-approved by the sale administrator.
Trails and landings need to be rehabilitated to a satisfactory condition, determined by administering forester, before performance bond is returned.
Timber sale administrator shall be notified at least 3 working days prior to completion of hauling and road work. This provides adequate time for permit area inspection and addressing of permit compliance requirements before hauling and road work equipment is removed.

Itasca County Timber Appraisal Report

Appraised By:
Casey Dabrowski
Appraisal Date:
02/11/2021

Sale Type:
REGULAR AUCTION SALE
Auction Date:
06/09/2021

Appraisal Number: 21-02-03
Permit Number:
Expiration Date: 03/01/2024
Page: 2 of 3

Cutting, Felling, and Skidding

Do not damage reserve trees.
Do not disturb survey markers, including witness trees, which have been painted orange.
All sale boundaries beyond the road are painted with orange lines (|||).
Skid trails/landings across old field types will be permitted at administrator approved locations.
Avoid skid trails in low brush openings.

Site, Soil, and Water Protection

Filter strips require <5% soil disturbance within 50' of all wetlands.

Slash Disposal

Slash must be evenly distributed throughout permit area.

Regeneration Plan

Natural Regeneration to aspen and mixed hardwoods (red maple, black ash, basswood, spruce, elm).

Itasca County Timber Appraisal Report

Appraised By:
Casey Dabrowski
Appraisal Date:
02/11/2021

Sale Type:
REGULAR AUCTION SALE
Auction Date:
06/09/2021

Appraisal Number: 21-02-03
Permit Number:
Expiration Date: 03/01/2024
Page: 3 of 3

Site Map:

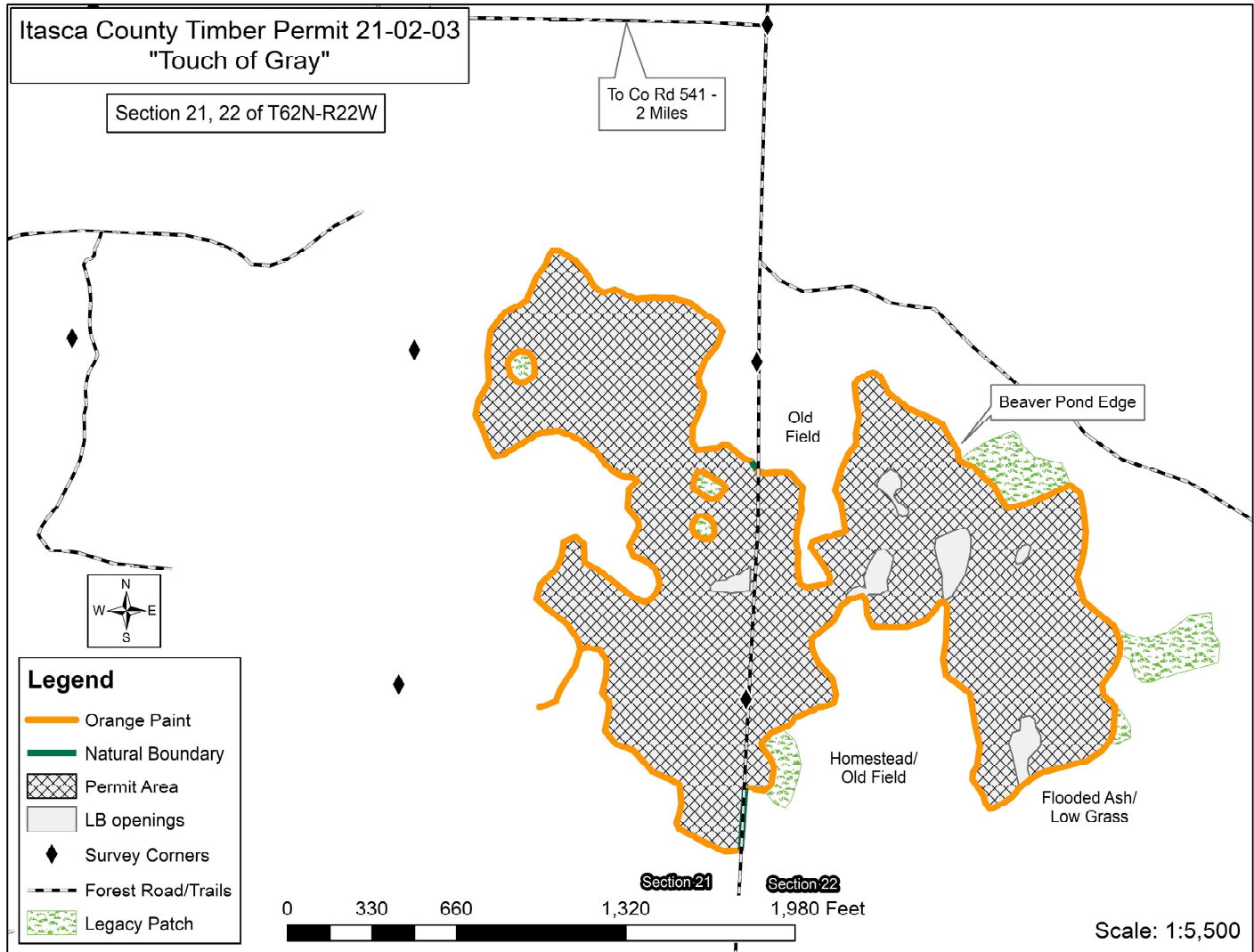

Appraisal examined and approved by _____
Forester Date

Appraisal examined and approved by _____
Land Department Date