

Itasca County Timber Appraisal Report

Appraised By:
Casey Dabrowski
Appraisal Date:
03/11/2021

Sale Type:
INTERMEDIATE AUCTION
Auction Date:
06/09/2021

Appraisal Number: 21-02-05
Permit Number:
Expiration Date: 03/01/2024
Page: 1 of 3

Legal Description

| <u>RE Code</u> | <u>Sec.</u> | <u>Twp.</u> | <u>Rge.</u> | <u>City/Twp</u> | <u>Subd</u> | | |
|------------------------|---------------|--------------|---------------------|-----------------|----------------------|---------------|------------|
| 72-035-2000 | 35 | 62 | 27 | Unorganized | NW 1/4 | | |
| <u>Block 1 Species</u> | <u>Volume</u> | <u>Units</u> | <u>Unit Price</u> | <u>Value</u> | <u>Comments</u> | <u>Bolt %</u> | <u>Bid</u> |
| Aspen | 880 | Cords | \$23.00 | \$20,240.00 | 5-10", 3-6 st, Good. | 0 | ^ |
| Balm | 52 | Cords | \$20.00 | \$1,040.00 | 5-8", 3-5 st, Good. | 0 | # |
| Ash | 15 | Cords | \$9.00 | \$135.00 | 5-10", 3-5 st, Fair. | 0 | # |
| | | | | \$21,415.00 | Subtotal | | |
| Total Cords = | 947 | | Total MBF: 0 | \$21,415.00 | Total | | |

Bid Symbols: ^ = Bid Species; # = Non-Bid Species; + = Sold Area Estimate; * = Sold Area Estimate & Non-Bid Species
All species woodsrun unless listed otherwise.

Species Scaled: Ash , Aspen, Balm

Species SAE:

Operability: Winter - Frozen Ground: 12/1 - 3/1

Soil Type: Effie Loam

Topography: Level

Cutting Acres: 35.1

All permits must follow Itasca County Forest Management Guidelines and Specifications (can be found at <http://www.co.itasca.mn.us/DocumentCenter/View/567/Forest-Management-Guidelines-and-Specifications>).

Harvest Specifications

| Comments |
|---------------------------------------|
| Harvest type: Clearcut with reserves. |

| Harvest and Reserves |
|--|
| Harvest: In aspen types, cut all aspen, balm, and ash. |
| Harvest: In ash/low brush types, cut out only merchantable (3 sticks and greater to 4" top) aspen/ash. |
| Reserve: Reserve all other species, including maple, spruce, cedar, balsam, birch, elm, and pine. Leave patches of aspen/low hardwoods regeneration <5". |
| Trees marked with "R" are to be reserved for wildlife. |
| Reserve all non-hazardous snags. |

| Access |
|--|
| Private/Molpus road must be used to access the timber sale. Access road must be kept in good condition, as determined by administering forester, at all times. Road to east goes through a sold county permit and road use/maintenance may need to be coordinated. It is the permit holder's responsibility to obtain approval from all affected landowners and/or management agencies before gaining access to the permit area. The permit holder shall pay all access fees and road charges. |
| 0.75 or 1.5 miles to public road Hwy 6/Hwy 1. |

| Landings and Access Roads |
|--|
| Location and construction of any new landings must be pre-approved by the sale administrator. |
| Timber sale administrator shall be notified at least 3 working days prior to completion of hauling and road work. This provides adequate time for permit area inspection and addressing of permit compliance requirements before hauling and road work equipment is removed. |
| Road to east crosses beaver dam/pond on high ground but must be frozen before use. |

Itasca County Timber Appraisal Report

Appraised By:
Casey Dabrowski
Appraisal Date:
03/11/2021

Sale Type:
INTERMEDIATE AUCTION
Auction Date:
06/09/2021

Appraisal Number: 21-02-05
Permit Number:
Expiration Date: 03/01/2024
Page: 2 of 3

Cutting, Felling, and Skidding

Do not damage reserve trees.
Do not fell timber into wetlands or across sale boundaries.
Sale boundaries painted with orange lines (I I I).
Avoid locating skid trails through low brush areas.

Site, Soil, and Water Protection

Filter strips require <5% soil disturbance within 50' of all wetlands.

Slash Disposal

Slash must be evenly distributed throughout permit area.

Regeneration Plan

Natural Regeneration to aspen and mixed hardwoods (red maple, black ash, basswood, balsam fir, spruce, birch, and elm).

Itasca County Timber Appraisal Report

Appraised By:
Casey Dabrowski
Appraisal Date:
03/11/2021

Sale Type:
INTERMEDIATE AUCTION
Auction Date:
06/09/2021

Appraisal Number: 21-02-05
Permit Number:
Expiration Date: 03/01/2024
Page: 3 of 3

Site Map:

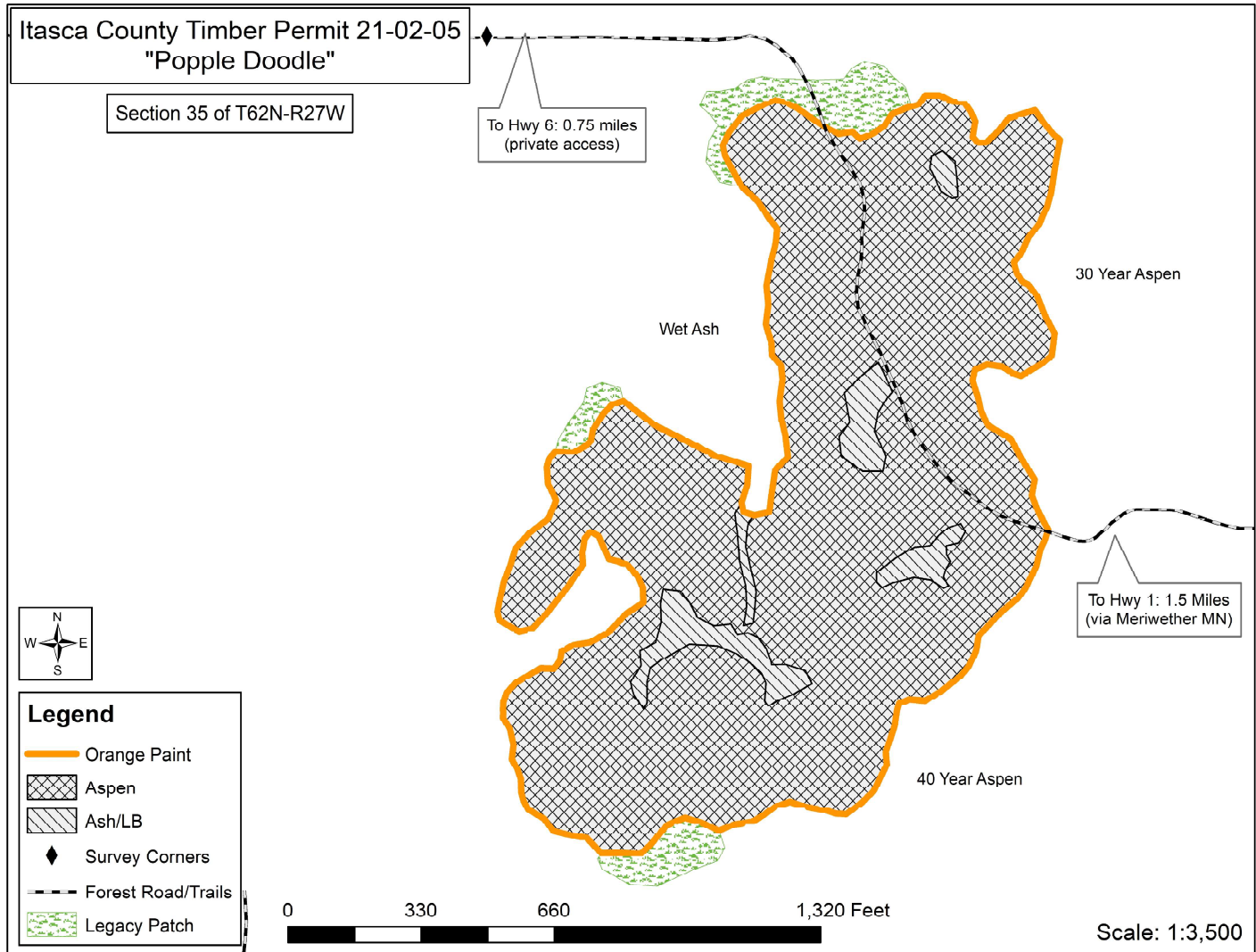

Appraisal examined and approved by _____
Forester Date

Appraisal examined and approved by _____
Land Department Date