

Itasca County Timber Appraisal Report

Appraised By: Casey Dabrowski	Sale Type: INTERMEDIATE AUCTION	Appraisal Number: 21-02-07
Appraisal Date: 03/11/2021	Auction Date: 06/09/2021	Permit Number:
		Expiration Date: 03/01/2024
		Page: 1 of 3

Legal Description

<u>RE Code</u>	<u>Sec.</u>	<u>Twp.</u>	<u>Rge.</u>	<u>City/Twp</u>	<u>Subd</u>			
10-007-2100	7	62	22	Carpenter	NE NW			
10-006-3000	6	62	22	Carpenter	SW 1/4			
10-007-2200	7	62	22	Carpenter	LOT 1			
<u>Block 1 Species</u>	<u>Volume</u>	<u>Units</u>	<u>Unit Price</u>	<u>Value</u>	<u>Comments</u>	<u>Bolt %</u>	<u>Bid</u>	
Spruce	276	Cords	\$12.00	\$3,312.00	5-12", 2-4 st, Fair.	15	^	
Aspen	154	Cords	\$17.00	\$2,618.00	6-12", 3-5 st, Good.	0	^	
Paper Birch	17	Cords	\$8.00	\$136.00	5-7", 3-4 st, Fair.	0	#	
Jack Pine	3	Cords	\$8.00	\$24.00	7-9", 3-5 st, Fair.	0	#	
Balm	3	Cords	\$17.00	\$51.00	5-7", 3-4 st, Fair.	0	#	
				\$6,141.00	Subtotal			
Total Cords =	453		Total MBF: 0	\$6,141.00	Total			

Bid Symbols: ^ = Bid Species; # = Non-Bid Species; + = Sold Area Estimate; * = Sold Area Estimate & Non-Bid Species
All species woodsrun unless listed otherwise.

Species Scaled: Aspen, Balm , Jack Pine, Paper Birch , Spruce

Species SAE:

Operability:	Winter - Frozen Ground: 12/1 - 3/1	Soil Type:	Effie Loam, Suomi Silt Loam
Topography:	Level	Cutting Acres:	52.0

All permits must follow Itasca County Forest Management Guidelines and Specifications (can be found at <http://www.co.itasca.mn.us/DocumentCenter/View/567/Forest-Management-Guidelines-and-Specifications>).

Harvest Specifications

<u>Comments</u>
Harvest type: operator select 1st time white spruce thin. Early freeze opportunity.

<u>Harvest and Reserves</u>
Harvest: Cut 12 ft. access strips reserving 40 ft. in between strips for thinning. Thin stand down to an average of 90 basal area. Favor the removal of smaller diameter/suppressed, poor quality, and damaged trees of all species. In aspen/birch dominated areas with poor spruce establishment, remove only defective spruce or hardwoods crowding good spruce regardless of BA.
Reserve: Good formed white spruce, red pine, jack pine, paper birch, aspen; all hardwoods in windrows not crowding healthy spruce.

<u>Access</u>
System forest road must be used to access the timber sale. Access road must be kept in good condition, as determined by administering forester, at all times.
2.1 miles to public road State Hwy 1.

<u>Landings and Access Roads</u>
Existing roads/landings will be reused. No new roads/landings except turn-arounds will be allowed.
Trails and landings need to be rehabilitated to a satisfactory condition, determined by administering forester, before performance bond is returned.
Timber sale administrator shall be notified at least 3 working days prior to completion of hauling and road work. This provides adequate time for permit area inspection and addressing of permit compliance requirements before hauling and road work equipment is removed.

Itasca County Timber Appraisal Report

Appraised By:
Casey Dabrowski
Appraisal Date:
03/11/2021

Sale Type:
INTERMEDIATE AUCTION
Auction Date:
06/09/2021

Appraisal Number: 21-02-07
Permit Number:
Expiration Date: 03/01/2024
Page: 2 of 3

Cutting, Felling, and Skidding

Timber must be processed at the stump.
Do not damage crop/reserved trees.
Ownership boundaries painted with orange circles (O O O). All other boundaries are unpainted; see map.
Avoid locating skid trails through low brush areas.
Along power lines, only fell timber away from the power lines/corridor.

Site, Soil, and Water Protection

Filter strips require <5% soil disturbance within 50' of all wetlands.

Regeneration Plan

Due to nature of managed species and type of harvest little to no tree regeneration is expected to occur after harvest.

Itasca County Timber Appraisal Report

Appraised By:
Casey Dabrowski
Appraisal Date:
03/11/2021

Sale Type:
INTERMEDIATE AUCTION
Auction Date:
06/09/2021

Appraisal Number: 21-02-07
Permit Number:
Expiration Date: 03/01/2024
Page: 3 of 3

Site Map:

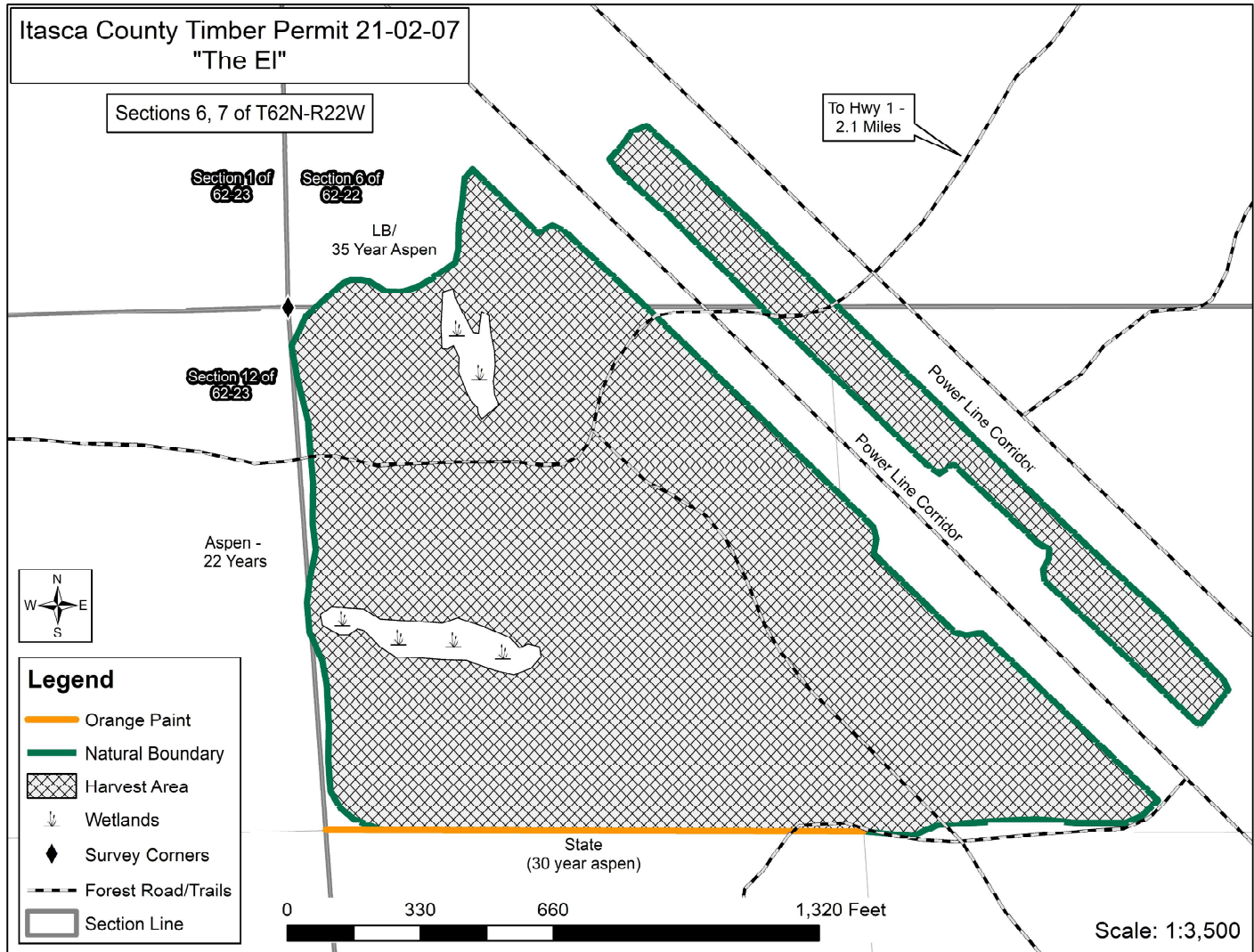

Appraisal examined and approved by _____
Forester Date

Appraisal examined and approved by _____
Land Department Date