

Itasca County Timber Appraisal Report

Appraised By: Casey Dabrowski	Sale Type: REGULAR AUCTION SALE	Appraisal Number: 21-02-09
Appraisal Date: 03/31/2021	Auction Date: 06/09/2021	Permit Number:
		Expiration Date: 03/01/2024
		Page: 1 of 3

Legal Description

<u>RE Code</u>	<u>Sec.</u>	<u>Twp.</u>	<u>Rge.</u>	<u>City/Twp</u>	<u>Subd</u>			
10-211-2100	11	62	24	Carpenter	NE NW			
10-210-1000	10	62	24	Carpenter	NE 1/4			
10-211-2400	11	62	24	Carpenter	SE NW			
10-211-2200	11	62	24	Carpenter	NW NW			
<u>Block 1 Species</u>	<u>Volume</u>	<u>Units</u>	<u>Unit Price</u>	<u>Value</u>	<u>Comments</u>	<u>Bolt %</u>	<u>Bid</u>	
Aspen	1,622	Cords	\$25.00	\$40,550.00	6-14", 5-7 st, Good.	10	^	
Paper Birch	52	Cords	\$9.00	\$468.00	7-15", 3-6 st, Poor.	0	#	
Balm	30	Cords	\$20.00	\$600.00	10-18", 3-6 st, Poor.	0	#	
Ash	12	Cords	\$9.00	\$108.00	5-12", 3-5 st, Fair.	0	#	
Spruce	1	Cords	\$26.00	\$26.00	For operational trees only.	0	#	
Maple	1	Cords	\$9.00	\$9.00	For operational trees only.	0	#	
				\$41,761.00	Subtotal			
Total Cords =	1,718		Total MBF: 0	\$41,761.00	Total			

Bid Symbols: ^ = Bid Species; # = Non-Bid Species; + = Sold Area Estimate; * = Sold Area Estimate & Non-Bid Species
All species woodsrun unless listed otherwise.

Species Scaled: Ash , Aspen, Balm , Maple , Paper Birch , Spruce

Species SAE:

Operability:	Winter - Frozen Ground: 12/1 - 3/1	Soil Type:	Effie Loam, Suomi Silt Loam
Topography:	Level	Cutting Acres:	40.0

All permits must follow Itasca County Forest Management Guidelines and Specifications (can be found at <http://www.co.itasca.mn.us/DocumentCenter/View/567/Forest-Management-Guidelines-and-Specifications>).

Harvest Specifications

<u>Comments</u>
Harvest type: Clearcut with reserves.
<u>Harvest and Reserves</u>
Harvest: birch over 6" and all aspen, balm, and ash.
Reserve: birch under 6" and all maple, spruce, balsam, elm, pine, oak, basswood, and trees marked with orange "R".
Reserve all non-hazardous snags, including unmerchantable hollow/rotten live balm.
<u>Access</u>
System forest road must be used to access the timber sale. Access road must be kept in good condition, as determined by administering forester, at all times.
Wilderness Willie snowmobile trail route also uses Horseshoe Trail. If used for access, snowmobile trail regulations in Itasca County Forest Management Guideline & Specifications apply. A minimum of two inches of compacted snow must remain on the trail as a running surface. Otherwise, harvest is adjacent to trail and will need to be protected from slash and debris.
1.4 miles to County Road 523 via Monument Road.
3.2 miles to County Road 533 via Horseshoe Trail/M&O Road.
3.5 miles to County Road 525 via Horseshoe Trail/Lofgren forest road.
6.6 miles to County Road 542 via Horseshoe Trail/Button Box forest road.

Itasca County Timber Appraisal Report

Appraised By:
Casey Dabrowski
Appraisal Date:
03/31/2021

Sale Type:
REGULAR AUCTION SALE
Auction Date:
06/09/2021

Appraisal Number: 21-02-09
Permit Number:
Expiration Date: 03/01/2024
Page: 2 of 3

Landings and Access Roads

Existing roads will be used. Location and construction of landings must be pre-approved by the sale administrator.
Trails and landings need to be rehabilitated to a satisfactory condition, determined by administering forester, before performance bond is returned.
Reserve all non-merchantable timber within 15ft of Horseshoe Trail.
Landing areas must be kept back at least 100' from Horseshoe Trail. No landing directly on Horseshoe Trail.
Timber sale administrator shall be notified at least 3 working days prior to completion of hauling and road work. This provides adequate time for permit area inspection and addressing of permit compliance requirements before hauling and road work equipment is removed.

Cutting, Felling, and Skidding

Do not fell timber into wetlands or across sale boundaries.
Do not damage reserve trees.
Sale boundaries painted with orange lines (I I I). Natural boundary is also used; see sale map.

Site, Soil, and Water Protection

Filter strips require <5% soil disturbance within 50' of all wetlands.
Do not skid through unpainted wetlands, which are characterized by an open, brush free depression.

Slash Disposal

Slash must be evenly distributed throughout permit area.
Slash height must not exceed 3 ft. within view of road.

Regeneration Plan

Natural Regeneration to aspen and mixed hardwoods (red maple, spruce, balsam, birch, basswood, elm)

Itasca County Timber Appraisal Report

Appraised By:
Casey Dabrowski
Appraisal Date:
03/31/2021

Sale Type:
REGULAR AUCTION SALE
Auction Date:
06/09/2021

Appraisal Number: 21-02-09
Permit Number:
Expiration Date: 03/01/2024
Page: 3 of 3

Site Map:

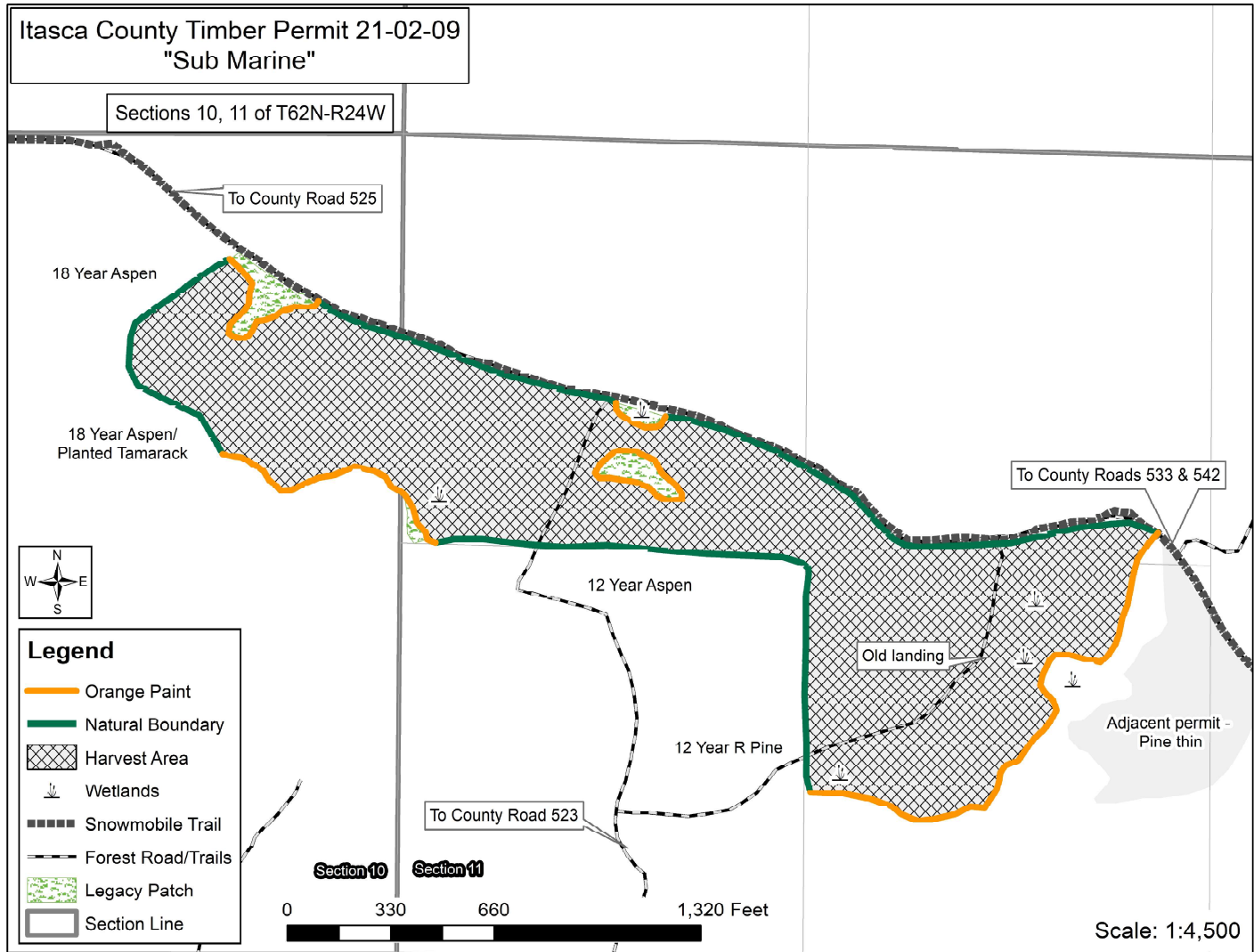

Appraisal examined and approved by _____
Forester Date

Appraisal examined and approved by _____
Land Department Date