

Itasca County Timber Appraisal Report

Appraised By:
Casey Dabrowski
Appraisal Date:
09/27/2021

Sale Type:
REGULAR AUCTION SALE
Auction Date:
12/14/2021

Appraisal Number: 21-02-10
Permit Number:
Expiration Date: 03/01/2024
Page: 1 of 3

Legal Description

<u>RE Code</u>	<u>Sec.</u>	<u>Twp.</u>	<u>Rge.</u>	<u>City/Twp</u>	<u>Subd</u>		
10-204-0000	4	62	24	Carpenter	ALL SECTION 4		
<u>Block 1 Species</u>	<u>Volume</u>	<u>Units</u>	<u>Unit Price</u>	<u>Value</u>	<u>Comments</u>	<u>Bolt %</u>	<u>Bid</u>
Aspen	350	Cords	\$20.00	\$7,000.00	8-16", 5-8 st, 2 aged, Good/Poor.	10	^
Paper Birch	55	Cords	\$7.00	\$385.00	9-13", 3-6 st, Fair/Poor	20	#
Maple	39	Cords	\$7.00	\$273.00	6-15", 3-6 st, Poor.	0	#
Basswood	26	Cords	\$7.00	\$182.00	8-18", 3-6 st, Poor. Pulp optional.	5	#
Burr Oak	8	Cords	\$7.00	\$56.00	8-14", 3-6 st, Fair/Poor.	20	#
Balsam Fir	3	Cords	\$7.00	\$21.00	Understory. Optional.	0	#
Red Oak	3	Cords	\$7.00	\$21.00	15-20", 5-7 st, Fair.	10	#
Spruce	2	Cords	\$7.00	\$14.00	Understory. Optional.	0	#
				\$7,952.00	Subtotal		
Total Cords =	486	Total MBF: 0		\$7,952.00	Total		

Bid Symbols: ^ = Bid Species; # = Non-Bid Species; + = Sold Area Estimate; * = Sold Area Estimate & Non-Bid Species
All species woodsrun unless listed otherwise.

Species Scaled: Aspen, Balsam Fir, Basswood, Burr Oak, Maple, Paper Birch, Red Oak, Spruce

Species SAE:

Operability: Summer - Dry soil conditions: 7/1 - 9/1,
Winter - Frozen ground conditions: 12/1 - 3/1

Soil Type: Suomi silt loam, Effie Loam

Topography: Level

Cutting Acres: 29.3

All permits must follow Itasca County Forest Management Guidelines and Specifications (can be found at <http://www.co.itasca.mn.us/DocumentCenter/View/567/Forest-Management-Guidelines-and-Specifications>).

Harvest Specifications

<u>Comments</u>
Harvest type: marked hardwood thin.

<u>Harvest and Reserves</u>
Harvest: cut all aspen not marked with orange R (R--R); cut all other species only when marked with orange slash (/ /)
Reserve: reserve all trees marked with orange R (R--R), all unmarked non-aspen species, and existing hardwood regeneration.
Reserve all non-hazardous snags.

<u>Access</u>
If cut during snowmobile season, snowmobile trail regulations in Itasca County Forest Management Guideline & Specifications apply. A minimum of two inches of compacted snow must remain on the trail as a running surface.
1.6 miles to public road County Road 525.

<u>Landings and Access Roads</u>
Location and construction of any new roads/landings must be pre-approved by the sale administrator.
Trails and landings need to be rehabilitated to a satisfactory condition, determined by administering forester, before performance bond is returned.
Timber sale administrator shall be notified at least 3 working days prior to completion of hauling and road work. This provides adequate time for permit area inspection and addressing of permit compliance requirements before hauling and road work equipment is removed.

Itasca County forestlands are Forest Stewardship Council (FSC) Certified by NEPCo, NC-FM/COC-001709; FSC 100%

Itasca County Timber Appraisal Report

Appraised By: Casey Dabrowski	Sale Type: REGULAR AUCTION SALE	Appraisal Number: 21-02-10
Appraisal Date: 09/27/2021	Auction Date: 12/14/2021	Permit Number:
		Expiration Date: 03/01/2024
		Page: 2 of 3

Cutting, Felling, and Skidding

Timber must be processed at the stump.

Sale boundaries painted with orange lines (I I I). Natural boundaries are also used, including ownership boundary to north; see sale map.

Lop and scatter unmerchantable stems marked for removal.

Unless cut during frozen ground conditions, equipment used must complete work in west half before moving to east half.

Species of same price may be mixed and scaled on landing.

Trees discovered with embedded metal from deer stand platforms have been painted heavily with orange. Watch for others!

Slash Disposal

Slash must be evenly distributed throughout permit area.

Regeneration Plan

Natural regeneration to mixed hardwoods and aspen

Itasca County Timber Appraisal Report

Appraised By:
Casey Dabrowski
Appraisal Date:
09/27/2021

Sale Type:
REGULAR AUCTION SALE
Auction Date:
12/14/2021

Appraisal Number: 21-02-10
Permit Number:
Expiration Date: 03/01/2024
Page: 3 of 3

Site Map:

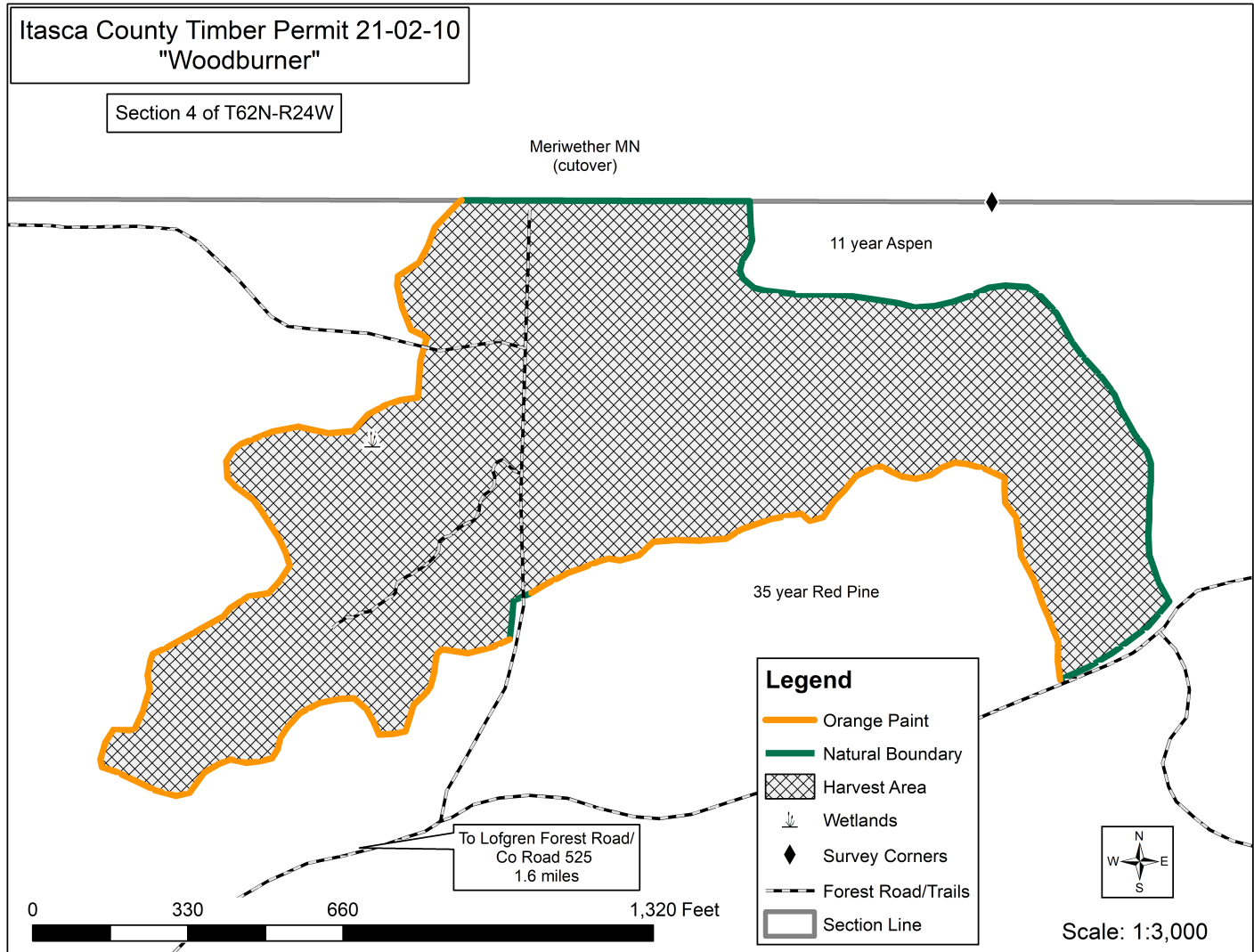

Appraisal examined and approved by _____
Forester Date

Appraisal examined and approved by _____
Land Department Date