

Itasca County Timber Appraisal Report

Appraised By: Casey Dabrowski	Sale Type: INTERMEDIATE AUCTION	Appraisal Number: 21-02-14
Appraisal Date: 10/18/2021	Auction Date: 12/14/2021	Permit Number:
		Expiration Date: 03/01/2024
		Page: 1 of 3

Legal Description

<u>RE Code</u>	<u>Sec.</u>	<u>Twp.</u>	<u>Rge.</u>	<u>City/Twp</u>	<u>Subd</u>			
10-229-2101	29	62	24	Carpenter	NE NW LESS W 750FT LYG N OF HWY			
10-229-2300	29	62	24	Carpenter	SW NW			
10-229-2400	29	62	24	Carpenter	SE NW			
<u>Block 1 Species</u>	<u>Volume</u>	<u>Units</u>	<u>Unit Price</u>	<u>Value</u>	<u>Comments</u>	<u>Bolt %</u>	<u>Bid</u>	
Jack Pine	287	Cords	\$19.00	\$5,453.00	6-14", 4-7 st, Fair.	45	^	
Red Pine	129	Cords	\$19.00	\$2,451.00	6-14", 3-7 st, Good.	45	^	
Aspen	1	Cords	\$19.00	\$19.00	Poor.	0	#	
				\$7,923.00	Subtotal			
Total Cords =	417		Total MBF: 0	\$7,923.00	Total			

Bid Symbols: ^ = Bid Species; # = Non-Bid Species; + = Sold Area Estimate; * = Sold Area Estimate & Non-Bid Species
All species woodsrun unless listed otherwise.

Species Scaled: Aspen, Jack Pine, Red Pine

Species SAE:

Operability:	Summer: 3/1 - 2/28	Soil Type:	Menahga & Graycalm sands
Topography:	Level	Cutting Acres:	13.3

All permits must follow Itasca County Forest Management Guidelines and Specifications (can be found at <http://www.co.itasca.mn.us/DocumentCenter/View/567/Forest-Management-Guidelines-and-Specifications>).

Harvest Specifications

<u>Comments</u>
Harvest Type: Operator select second thin and jack pine removal.

<u>Harvest and Reserves</u>
Harvest: remove all jack pine and aspen. Thin remaining red pine from below, targeting removal of suppressed and defective trees. Target BA is 100; approximately 12-15' spacing.
Reserve all other species, including birch, white pine, white/black spruce.
Reserve all non-hazardous snags.

<u>Access</u>
0.25 miles to Hwy 1.
Re-place boulder berm at Hwy 1 when sale is completed.

<u>Landings and Access Roads</u>
No new roads/landings will be permitted.
Trails and landings need to be rehabilitated to a satisfactory condition, determined by administering forester, before performance bond is returned.
Timber sale administrator shall be notified at least 3 working days prior to completion of hauling and road work. This provides adequate time for permit area inspection and addressing of permit compliance requirements before hauling and road work equipment is removed.

Itasca County Timber Appraisal Report

Appraised By: Casey Dabrowski	Sale Type: INTERMEDIATE AUCTION	Appraisal Number: 21-02-14
Appraisal Date: 10/18/2021	Auction Date: 12/14/2021	Permit Number:
		Expiration Date: 03/01/2024
		Page: 2 of 3

Cutting, Felling, and Skidding

Timber must be processed at the stump.
Do not damage reserve trees.
All sale boundaries are unpainted; see sale map.

Slash Disposal

Slash must be evenly distributed throughout permit area.

Regeneration Plan

Natural regeneration: larger openings will regrow with balsam fir and aspen.

Itasca County Timber Appraisal Report

Appraised By:
Casey Dabrowski
Appraisal Date:
10/18/2021

Sale Type:
INTERMEDIATE AUCTION
Auction Date:
12/14/2021

Appraisal Number: 21-02-14
Permit Number:
Expiration Date: 03/01/2024
Page: 3 of 3

Site Map:

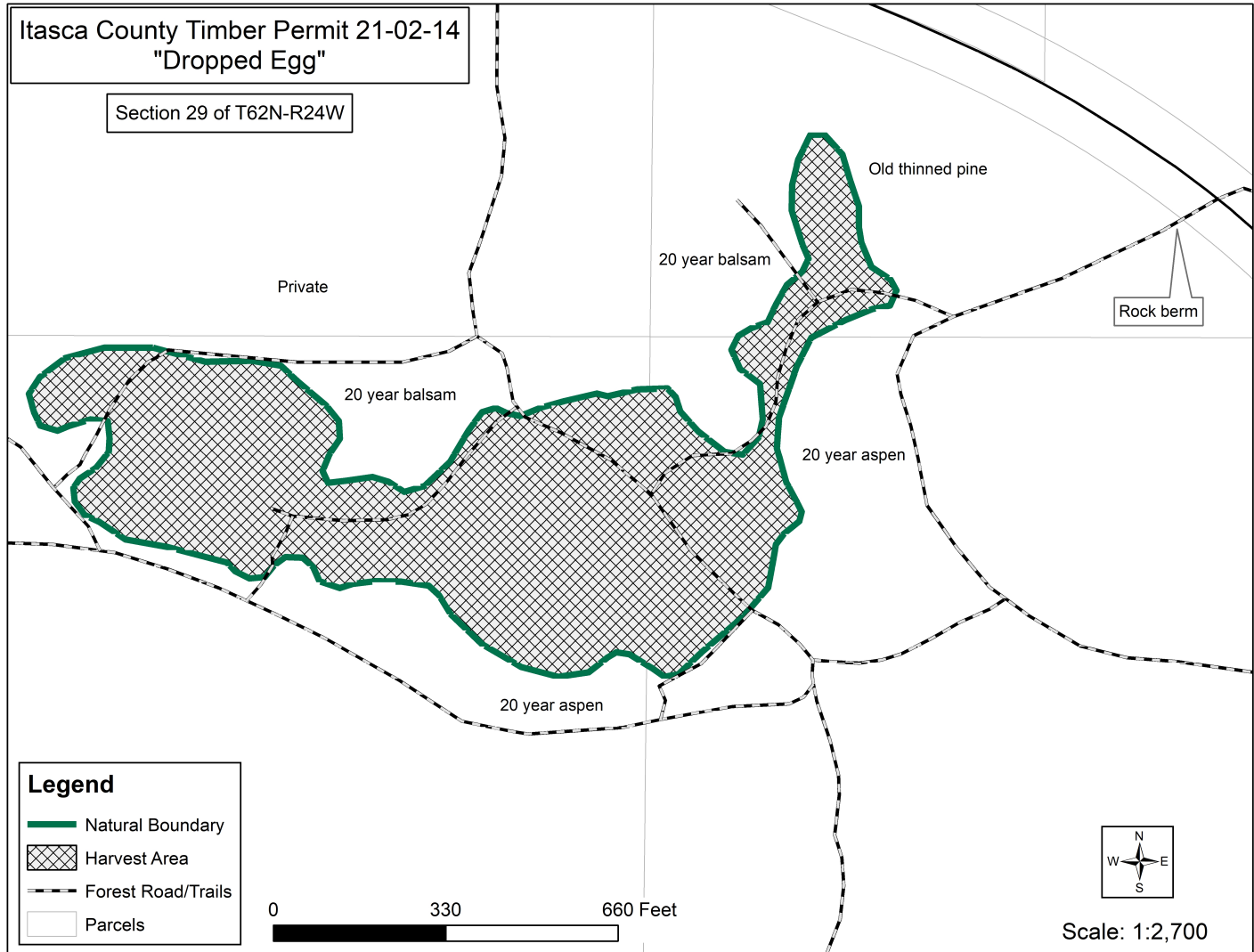

Appraisal examined and approved by _____
Forester Date

Appraisal examined and approved by _____
Land Department Date