

# Itasca County Timber Appraisal Report

**Appraised By:**  
Casey Dabrowski  
**Appraisal Date:**  
10/18/2021

**Sale Type:**  
INTERMEDIATE AUCTION  
**Auction Date:**  
12/14/2021

**Appraisal Number:** 21-02-15  
**Permit Number:**  
**Expiration Date:** 03/01/2024  
**Page:** 1 of 3

## Legal Description

RE Code	Sec.	Twp.	Rge.	City/Twp	Subd
10-126-3401	26	62	23	Carpenter	SE SW LESS N 300' OF S 400' OF E 660' & LESS

Block 1 Species	Volume	Units	Unit Price	Value	Comments	Bolt %	Bid
Red Pine	113	Cords	\$23.00	\$2,599.00	6-12", 2-6 st, Good. Some trees 15"+	60	^
Jack Pine	41	Cords	\$13.00	\$533.00	6-10", 3-6 st, Fair.	25	^
Paper Birch	5	Cords	\$8.00	\$40.00	8-13", Poor.	0	#
Balsam Fir	4	Cords	\$5.00	\$20.00	5-14", Poor.	0	#
White Pine	3	Cords	\$8.00	\$24.00	10-15", Poor.	0	#
Spruce	2	Cords	\$13.00	\$26.00	8-12", Poor.	0	#
				\$3,242.00	<b>Subtotal</b>		
<b>Total Cords =</b>	168	<b>Total MBF: 0</b>		\$3,242.00	<b>Total</b>		

Bid Symbols: ^ = Bid Species; # = Non-Bid Species; + = Sold Area Estimate; \* = Sold Area Estimate & Non-Bid Species  
All species woodsrun unless listed otherwise.

**Species Scaled:** Balsam Fir, Jack Pine, Paper Birch , Red Pine, Spruce , White Pine

**Species SAE:**

<b>Operability:</b>	Summer: 3/1 - 2/28	<b>Soil Type:</b>	Menahga & Graycalm sands
<b>Topography:</b>	Level	<b>Cutting Acres:</b>	10.7

All permits must follow Itasca County Forest Management Guidelines and Specifications (can be found at <http://www.co.itasca.mn.us/DocumentCenter/View/567/Forest-Management-Guidelines-and-Specifications> ).

## Harvest Specifications

Comments
Harvest Type: Operator select second time pine thin.

Harvest and Reserves
Harvest: In east block, use existing cut strips to thin timber. Western 2 blocks don't have existing strips; cut 12' access strips every 40' and thin between. In all blocks, focus removal of suppressed and defective trees of all species to a target of 100 BA. Cut older pines if younger crop trees will be released.
Reserve all non-hazardous snags.

Access
0.1 miles to County Road 550.
Access and landing trail is also Thistledew ATV trail; ATV regulations in Itasca County Forest Management Guideline & Specifications apply.
State must be crossed to access timber sale. Logger must obtain permits/permission from land manager.

Landings and Access Roads
No construction of any new roads/landings will be permitted. Do not skid on ATV trail.
Trails and landings need to be rehabilitated to a satisfactory condition, determined by administering forester, before performance bond is returned.
Reserve all non-merchantable timber within 15ft of ATV trails.
Timber sale administrator shall be notified at least 3 working days prior to completion of hauling and road work. This provides adequate time for permit area inspection and addressing of permit compliance requirements before hauling and road work equipment is removed.

**Itasca County Timber Appraisal Report**

**Appraised By:**  
Casey Dabrowski  
**Appraisal Date:**  
10/18/2021

**Sale Type:**  
INTERMEDIATE AUCTION  
**Auction Date:**  
12/14/2021

**Appraisal Number:** 21-02-15  
**Permit Number:**  
**Expiration Date:** 03/01/2024  
**Page:** 2 of 3

**Cutting, Felling, and Skidding**

Timber must be processed at the stump.

Do not fell timber across sale/ownership boundaries.

Ownership boundaries painted with orange circles (O O O). Sale boundaries are unmarked; see sale map.

**Regeneration Plan**

Due to nature of managed species and type of harvest little to no tree regeneration is expected to occur after harvest.

# Itasca County Timber Appraisal Report

**Appraised By:**  
Casey Dabrowski  
**Appraisal Date:**  
10/18/2021

**Sale Type:**  
INTERMEDIATE AUCTION  
**Auction Date:**  
12/14/2021

**Appraisal Number:** 21-02-15  
**Permit Number:**  
**Expiration Date:** 03/01/2024  
**Page:** 3 of 3

## Site Map:

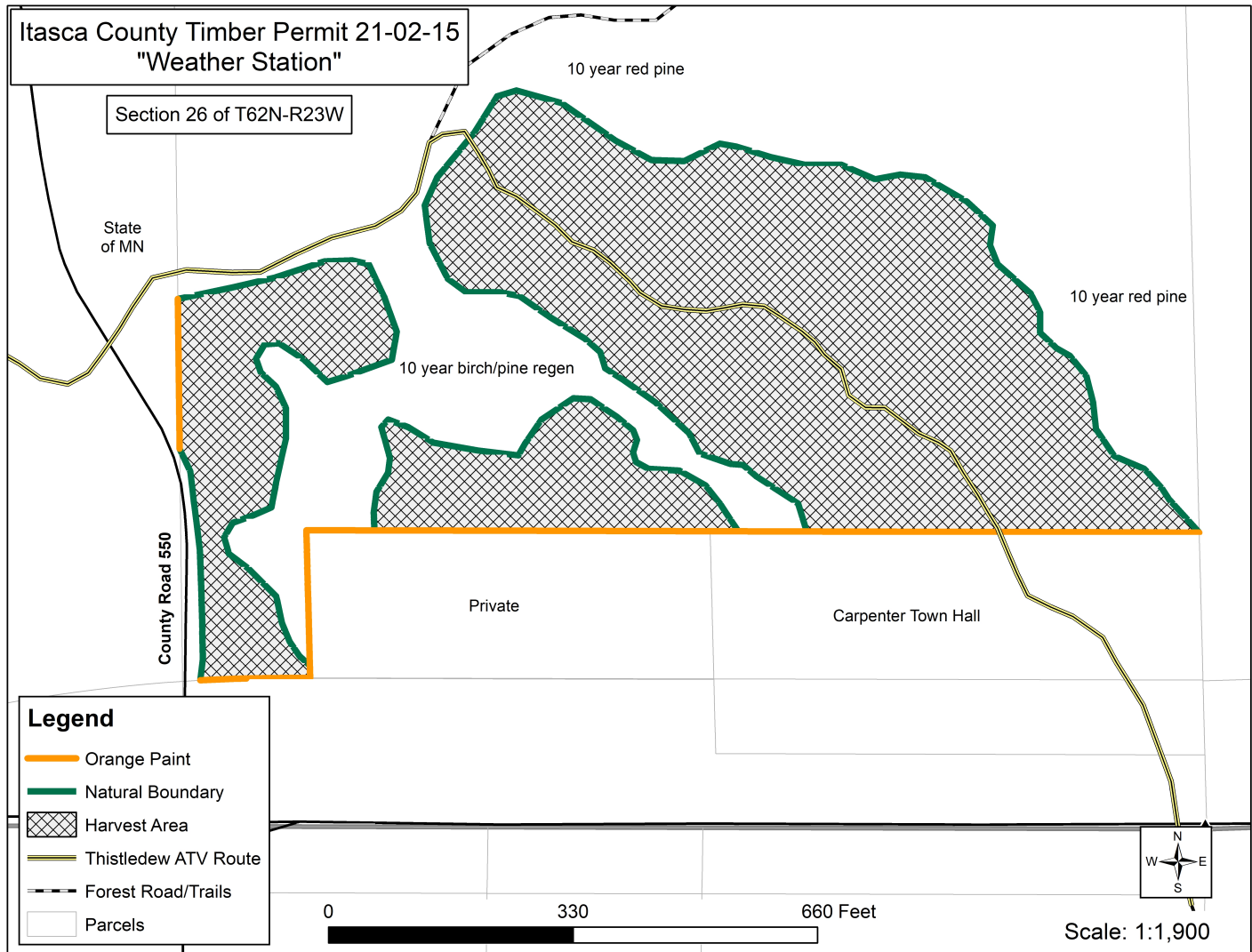

Appraisal examined and approved by \_\_\_\_\_  
Forester Date

Appraisal examined and approved by \_\_\_\_\_  
Land Department Date