

## Itasca County Timber Appraisal Report

**Appraised By:**

Perry Leone

**Appraisal Date:**

10/13/2021

**Sale Type:**

INTERMEDIATE AUCTION

**Auction Date:**

12/14/2021

**Appraisal Number:** 21-03-09**Permit Number:****Expiration Date:** 03/01/2024**Page:** 1 of 3**Legal Description**

<b>RE Code</b>	<b>Sec.</b>	<b>Twp.</b>	<b>Rge.</b>	<b>City/Twp</b>	<b>Subd</b>			
55-031-3100	31	59	24	Unorganized	NE SW			
55-031-1000	31	59	24	Unorganized	NE 1/4			
55-031-2300	31	59	24	Unorganized	LOT 2			
55-031-3200	31	59	24	Unorganized	LOT 3			
<b>Block 1 Species</b>	<b>Volume</b>	<b>Units</b>	<b>Unit Price</b>	<b>Value</b>	<b>Comments</b>	<b>Bolt %</b>	<b>Bid</b>	
Red Pine	810	Cords	\$21.00	\$17,010.00	4 stick avg. 6"-10" dia. First thin. 7-8 stick 8"-18" dia. clear-cut-5% SAW. Good Condition	55	^	
Balsam Fir	50	Cords	\$8.00	\$400.00	2-4 stick, 6"-10" dia. Fair Condition	20	#	
Aspen	100	Cords	\$22.00	\$2,200.00	3-7 stick, 6"-15" dia. Fair Condition	10	^	
White Pine	10	Cords	\$28.00	\$280.00	50% SAW, 6-7 stick, 12"-18" dia. Good Condition	40	#	
Paper Birch	10	Cords	\$8.00	\$80.00	2-4 stick, 6"-12" dia. Fair Condition	10	#	
Maple	5	Cords	\$8.00	\$40.00	2-4 stick, 6"-10" dia. Fair Condition	10	#	
Spruce	10	Cords	\$26.00	\$260.00	25% Saw-White Spruce, White Spruce 6-8 stick, 10"-20" dia., Black Spruce 3-5 stick, 5"-10" dia. Good Condition	20	#	
				\$20,270.00	<b>Subtotal</b>			
<b>Total Cords =</b>	995		<b>Total MBF: 0</b>	\$20,270.00	<b>Total</b>			

Bid Symbols: ^ = Bid Species; # = Non-Bid Species; + = Sold Area Estimate; \* = Sold Area Estimate & Non-Bid Species  
All species woodsrun unless listed otherwise.

**Species Scaled:** Aspen, Balsam Fir, Maple, Paper Birch, Red Pine, Spruce, White Pine

**Species SAE:**

**Operability:** Dry summer/early freeze: 7-1 - 3-1

**Soil Type:** Menahga & Graycalm soils

**Topography:** Level/rolling; some steep

**Cutting Acres:** 68.0

All permits must follow Itasca County Forest Management Guidelines and Specifications (can be found at <http://www.co.itasca.mn.us/DocumentCenter/View/567/Forest-Management-Guidelines-and-Specifications> ).

**Harvest Specifications**

<b>Comments</b>
HARVEST TYPE= FIRST TIME OPERATOR SELECT RED PINE THIN (60 ACRES), RED PINE/BALSAM CLEARCUT (8 ACRES)
<b>Harvest and Reserves</b>
Reserve: red oaks, ash, and white pine marked with "R" are to be reserved for wildlife & seed source.
<b>Access</b>
0.75 miles to County Road 339. Easement road must be used to access the timber sale. Access road must be kept in good condition, as determined by administering forester, at all times. Gates must remain locked during hunting season.

# Itasca County Timber Appraisal Report

<b>Appraised By:</b> Perry Leone	<b>Sale Type:</b> INTERMEDIATE AUCTION	<b>Appraisal Number:</b> 21-03-09
<b>Appraisal Date:</b> 10/13/2021	<b>Auction Date:</b> 12/14/2021	<b>Permit Number:</b>
		<b>Expiration Date:</b> 03/01/2024
		<b>Page:</b> 2 of 3

## Landings and Access Roads

Landings must be kept back at least 100' from Barwise Lake Road.

Trails and landings need to be rehabilitated to a satisfactory condition, determined by administering forester, before performance bond is returned.

## Cutting, Felling, and Skidding

Do not damage reserve crop trees.

Do not fell timber into wetlands or across sale boundaries.

Cut 12 ft. access strips reserving 40 ft. in between strips for thinning. Thin stand down to an average of 90-100 basal area. Favor the removal of smaller diameter, poor quality, and damaged trees.

Sale boundaries painted in Orange & Natural Boundaries.

Do not disturb survey markers, including witness trees. Corner painted/flagged in SW corner of west block of sale.

## Site, Soil, and Water Protection

Filter strips require <5% soil disturbance within 50' of all wetlands.

## Slash Disposal

Slash must be evenly distributed throughout permit area.

A 10 ft. wide slash free zone must be maintained along roads and trails.

## Special Conditions

Logging season may be restricted to August through February during high bark beetle risk. All cut pine must be hauled within 3 weeks during June through August.

Utilize all trees with at least 2 sticks up to a 3" top.

## Regeneration Plan

Plant- 3 clear-cut blocks to red pine(8 acres).

# Itasca County Timber Appraisal Report

**Appraised By:**

Perry Leone

**Appraisal Date:**

10/13/2021

**Sale Type:**

INTERMEDIATE AUCTION

**Auction Date:**

12/14/2021

**Appraisal Number:** 21-03-09

**Permit Number:**

**Expiration Date:** 03/01/2024

**Page:** 3 of 3

## Site Map:

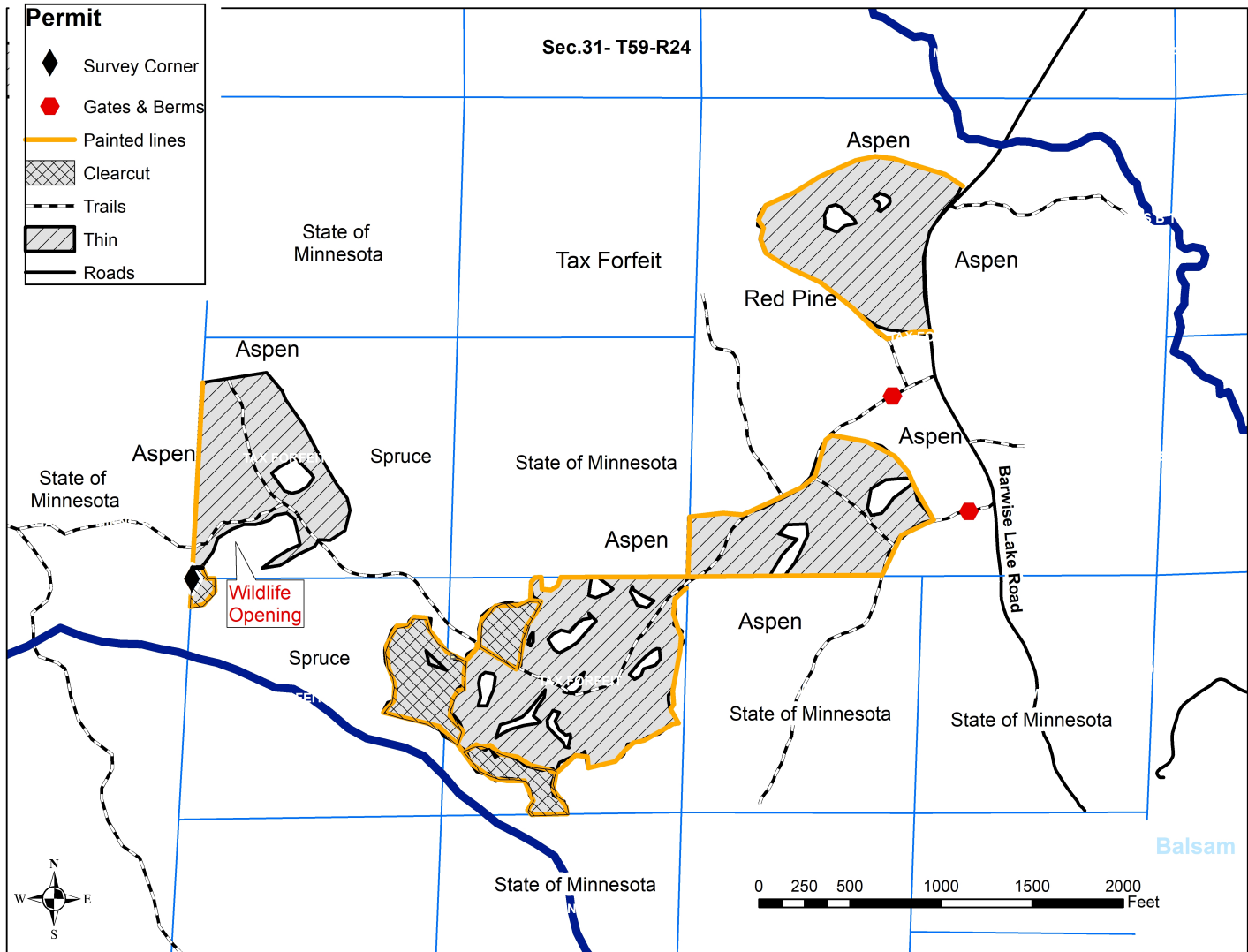

Appraisal examined and approved by \_\_\_\_\_

Forester

\_\_\_\_\_ Date

Appraisal examined and approved by \_\_\_\_\_

Land Department

\_\_\_\_\_ Date