

Itasca County Timber Appraisal Report

Appraised By: Perry Leone Appraisal Date: 10/14/2021	Sale Type: REGULAR AUCTION SALE Auction Date: 12/14/2021	Appraisal Number: 21-03-12 Permit Number: Expiration Date: 03/01/2025 Page: 1 of 3
---	---	---

Legal Description

RE Code	Sec.	Twp.	Rge.	City/Twp	Subd
60-028-4000	28	60	25	Unorganized	SE 1/4
60-034-2000	34	60	25	Unorganized	NW 1/4
60-027-3000	27	60	25	Unorganized	SW 1/4

Block 1 Species	Volume	Units	Unit Price	Value	Comments	Bolt %	Bid
Red Pine	1,437	Cords	\$52.00	\$74,724.00	5-8 sticks, 55% sawlogs, 7% of trees are cabin logs or poles. 84-121 yrs. old.	35	^
Jack Pine	605	Cords	\$35.00	\$21,175.00	6-7 sticks, 71 yrs. old.	70	^
Aspen	400	Cords	\$29.00	\$11,600.00	5-7 sticks, 46-84 yrs. old.	25	^
White Pine	70	Cords	\$30.00	\$2,100.00	5-7 sticks, 15% sawlogs.	50	#
Balsam Fir	59	Cords	\$7.00	\$413.00	3-6 sticks.	10	#
Spruce	44	Cords	\$25.00	\$1,100.00	3-7 sticks. 90% white spruce.	40	#
Paper Birch	44	Cords	\$10.00	\$440.00	3-5 sticks.	10	#
Maple	4	Cords	\$8.00	\$32.00	3-4 sticks.	0	#

\$111,584.00 **Subtotal**

Total Cords = 2,663 **Total MBF: 0** \$111,584.00 **Total**

Bid Symbols: ^ = Bid Species; # = Non-Bid Species; + = Sold Area Estimate; * = Sold Area Estimate & Non-Bid Species
 All species woodsrun unless listed otherwise.

Species Scaled: Aspen, Balsam Fir, Jack Pine, Maple , Paper Birch , Red Pine, Spruce , White Pine

Species SAE:

Operability: Summer chance: 5/1 - 3/1 **Soil Type:** Menahga & Graycalm sands
Topography: Level **Cutting Acres:** 49.0

All permits must follow Itasca County Forest Management Guidelines and Specifications (can be found at <http://www.co.itasca.mn.us/DocumentCenter/View/567/Forest-Management-Guidelines-and-Specifications>).

Harvest Specifications

Comments
HARVEST TYPE = RED PINE, JACK PINE & ASPEN CLEARCUT WITH RESERVES

Harvest and Reserves
Reserve all oak, non-hazardous snags, and a 12-16" DBH fully crowned white pine every 100' in the red pine and aspen types.

Access
Snowmobile trail regulations in Itasca County Forest Management Guideline & Specifications apply. A minimum of two inches of compacted snow must remain on the trail as a running surface. Gates must remain locked during hunting season. ATV trail regulations in Itasca County Forest Management Guideline & Specifications apply. 0 - .25 miles to County Road 347.

Itasca County Timber Appraisal Report

Appraised By: Perry Leone Appraisal Date: 10/14/2021	Sale Type: REGULAR AUCTION SALE Auction Date: 12/14/2021	Appraisal Number: 21-03-12 Permit Number: Expiration Date: 03/01/2025 Page: 2 of 3
---	---	---

Landings and Access Roads

Reserve all non-merchantable timber within 15ft of County Road 347.
 Berm(s) must be installed after sale is completed.
 Landings must be kept back at least 100' from County Road 347.

Cutting, Felling, and Skidding

Full tree/whole tree skidding required across harvest area. Slash is to be tightly piled at least 50' from standing timber and road/trails. 30% of tops and limbs are to remain across the sites including breakage.
 Do not damage reserve trees.
 Sale boundaries are painted in blue or are natural boundaries.

Site, Soil, and Water Protection

Filter strips require <5% soil disturbance within 50' of all wetlands.
 Reserve all non-merchantable timber within 15ft of all wetlands.

Slash Disposal

A 10 ft. wide slash free zone must be maintained along roads and trails.
 Slash height must not exceed 3 ft. within view of road.

Special Conditions

Logging season may be restricted to August through February during high bark beetle risk. All cut pine must be hauled within 3 weeks during June through August.

Regeneration Plan

Plant 30 acres to red pine and 19 acres to jack pine.

Itasca County Timber Appraisal Report

Appraised By: Perry Leone	Sale Type: REGULAR AUCTION SALE	Appraisal Number: 21-03-12
Appraisal Date: 10/14/2021	Auction Date: 12/14/2021	Permit Number:
		Expiration Date: 03/01/2025
		Page: 3 of 3

Site Map:

Sec. 27, 28, 34, Twp. 60, Rng. 25

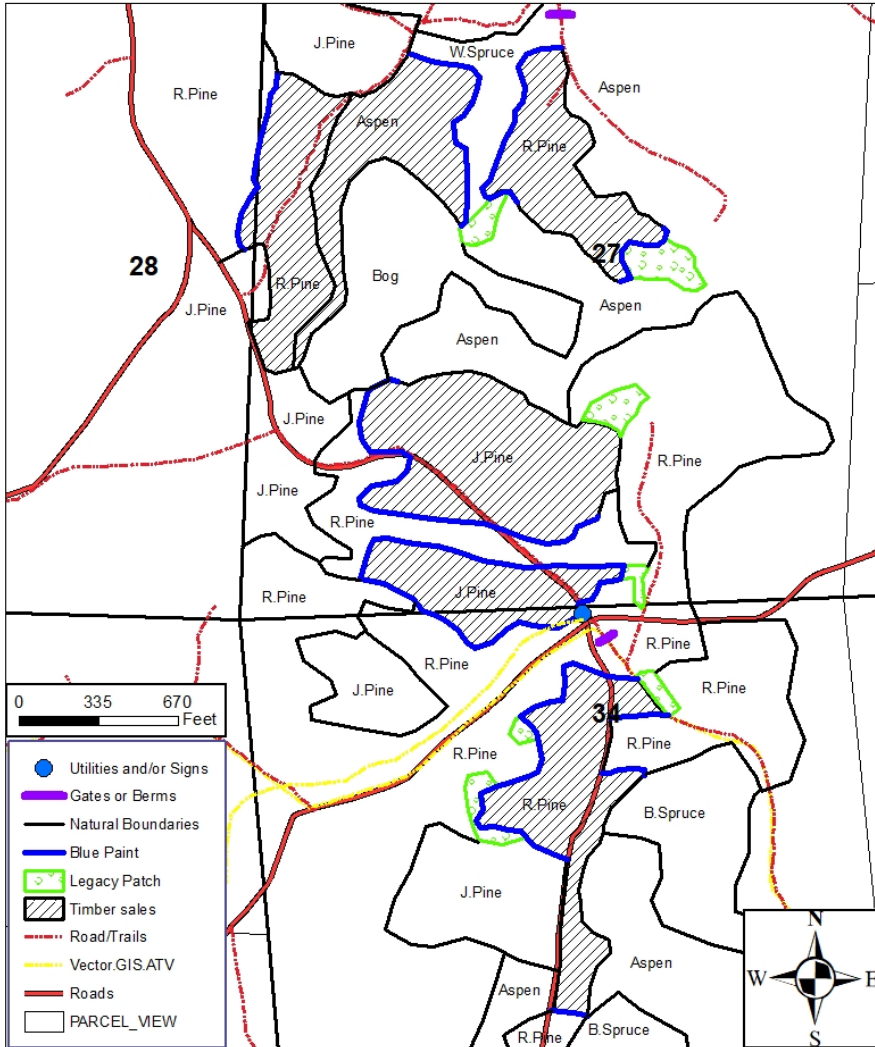

Appraisal examined and approved by _____
Forester
Date

Appraisal examined and approved by _____
Land Department
Date