

# Itasca County Timber Appraisal Report

**Appraised By:**

Ryan Newman

**Appraisal Date:**

04/01/2021

**Sale Type:**

INTERMEDIATE AUCTION

**Auction Date:**

06/09/2021

**Appraisal Number:** 21-05-05**Permit Number:****Expiration Date:** 03/01/2024**Page:** 1 of 3**Legal Description**

<u>RE Code</u>	<u>Sec.</u>	<u>Twp.</u>	<u>Rge.</u>	<u>City/Twp</u>	<u>Subd</u>		
53-009-3000	9	60	23	Unorganized	SW 1/4		
53-009-2000	9	60	23	Unorganized	NW 1/4		
<u>Block 1 Species</u>	<u>Volume</u>	<u>Units</u>	<u>Unit Price</u>	<u>Value</u>	<u>Comments</u>	<u>Bolt %</u>	<u>Bid</u>
Red Pine	208	Cords	\$25.00	\$5,200.00	11" avg. DBH/ 7 stick avg./ 7% saw	60	^
Jack Pine	54	Cords	\$20.00	\$1,080.00	10" avg. DBH/ 7 stick avg.	45	^
Aspen	52	Cords	\$25.00	\$1,300.00	8" avg. DBH/ 5 stick avg.	5	^
Balsam Fir	7	Cords	\$8.00	\$56.00		20	#
Spruce	2	Cords	\$15.00	\$30.00			#
				\$7,666.00	<b>Subtotal</b>		
<b>Total Cords =</b>	323		<b>Total MBF: 0</b>	\$7,666.00	<b>Total</b>		

Bid Symbols: ^ = Bid Species; # = Non-Bid Species; + = Sold Area Estimate; \* = Sold Area Estimate & Non-Bid Species  
All species woodsrun unless listed otherwise.

**Species Scaled:** Aspen, Balsam Fir, Jack Pine, Red Pine, Spruce

**Species SAE:**

**Operability:** Dry Summer: 7/1 - 10/1

**Soil Type:** Menahga-Graycalm

**Topography:** Flat

**Cutting Acres:** 10.7

All permits must follow Itasca County Forest Management Guidelines and Specifications (can be found at <http://www.co.itasca.mn.us/DocumentCenter/View/567/Forest-Management-Guidelines-and-Specifications> ).

**Harvest Specifications**

<u>Comments</u>
Harvest Type: First Time Red Pine Thin (8.6 acres) & Aspen CC (2 acres)

<u>Harvest and Reserves</u>
Pine Thin: Thin from below to reach a target BA of 110. Favor the removal of Jack Pine and Aspen first. Favor crop trees with quality form and healthy crowns. Aspen Block: Clearcut with Reserves. Reserve all non-hazardous snags.

<u>Access</u>
0.65 miles to Co Rd 52.

<u>Landings and Access Roads</u>
Roads and landings must be approved by sale administrator. Berm must be installed after sale is completed.

<u>Cutting, Felling, and Skidding</u>
Timber must be processed at the stump. Do not damage reserve trees. Sale boundaries painted blue around the aspen block, natural boundaries around the red pine thin. Cut 12 ft. access strips reserving 40 ft. in between strips for thinning.

# Itasca County Timber Appraisal Report

<b>Appraised By:</b> Ryan Newman	<b>Sale Type:</b> INTERMEDIATE AUCTION	<b>Appraisal Number:</b> 21-05-05
<b>Appraisal Date:</b> 04/01/2021	<b>Auction Date:</b> 06/09/2021	<b>Permit Number:</b> <b>Expiration Date:</b> 03/01/2024
		<b>Page:</b> 2 of 3

## Slash Disposal

Slash height must not exceed 3 ft. within view of road.

Slash must be evenly distributed throughout permit area.

## Special Conditions

Logging season may be restricted to August through February during high bark beetle risk. All cut pine must be hauled within 3 weeks during June through August.

## Regeneration Plan

Aspen Block: Natural Regeneration

# Itasca County Timber Appraisal Report

**Appraised By:**

Ryan Newman

**Appraisal Date:**

04/01/2021

**Sale Type:**

INTERMEDIATE AUCTION

**Auction Date:**

06/09/2021

**Appraisal Number:** 21-05-05

**Permit Number:**

**Expiration Date:** 03/01/2024

**Page:** 3 of 3

## Site Map:

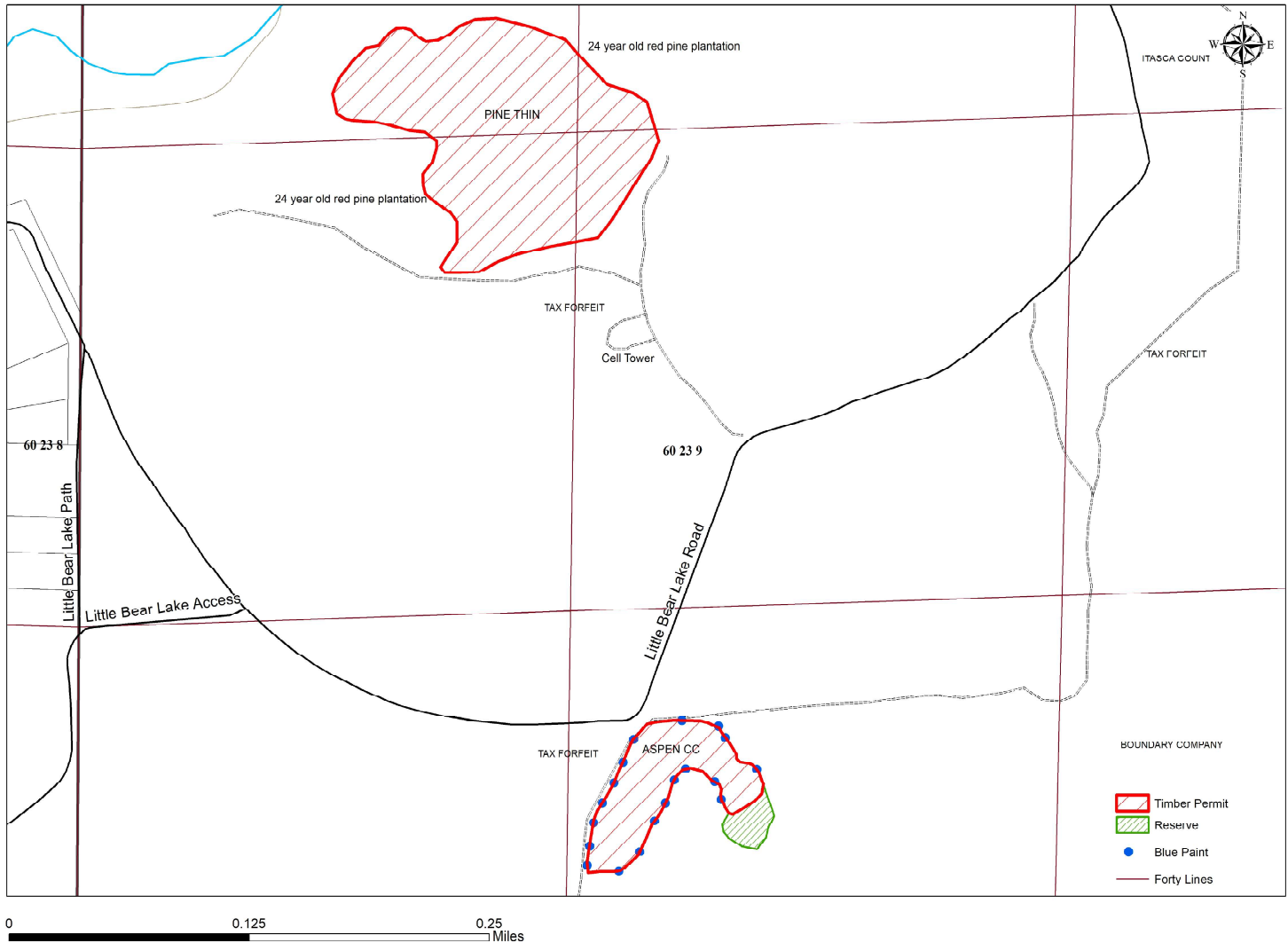

Appraisal examined and approved by \_\_\_\_\_

Forester

\_\_\_\_\_ Date

Appraisal examined and approved by \_\_\_\_\_

Land Department

\_\_\_\_\_ Date