

Itasca County Timber Appraisal Report

Appraised By: Jesse Lehner Appraisal Date: 06/28/2021	Sale Type: INTERMEDIATE AUCTION Auction Date: 12/14/2021	Appraisal Number: 21-07-10 Permit Number: Expiration Date: 03/01/2024 Page: 1 of 3
--	---	---

Legal Description

<u>RE Code</u>	<u>Sec.</u>	<u>Twp.</u>	<u>Rge.</u>	<u>City/Twp</u>	<u>Subd</u>		
23-006-2000	6	57	24	Lawrence	NW 1/4		
<u>Block 1 Species</u>	<u>Volume</u>	<u>Units</u>	<u>Unit Price</u>	<u>Value</u>	<u>Comments</u>	<u>Bolt %</u>	<u>Bid</u>
Aspen	631	Cords	\$24.00	\$15,144.00	4-7 sticks, 6-15 inch Dbh, Good quality	20	^
				\$15,144.00	Subtotal		
Total Cords =		631	Total MBF: 0		\$15,144.00	Total	

Bid Symbols: ^ = Bid Species; # = Non-Bid Species; + = Sold Area Estimate; * = Sold Area Estimate & Non-Bid Species
 All species woodsrun unless listed otherwise.

Species Scaled: Aspen

Species SAE:

Operability: Winter Frozen: 12/1 - 3/1	Soil Type: Cutaway loamy sand, Menahga-Graycalm loamy sand
Topography: Level/ Slight Roll	Cutting Acres: 20.5

All permits must follow Itasca County Forest Management Guidelines and Specifications (can be found at <http://www.co.itasca.mn.us/DocumentCenter/View/567/Forest-Management-Guidelines-and-Specifications>).

Harvest Specifications

Comments
Harvest Type: Clearcut w/reserves

Harvest and Reserves
Reserve all non-hazardous snags. Reserve all species not listed in "Block 1 Species" Trees marked with "R" are to be reserved for wildlife.

Access
Blandin property roads must be used to access the timber sale. Access road must be kept in good condition, as determined by administering forester, at all times. Snowmobile trail regulations in Itasca County Forest Management Guideline & Specifications apply. A minimum of two inches of compacted snow must remain on the trail as a running surface. Gate must be locked at all times, except on days when 3 or more loads are hauled.

Landings and Access Roads
Location and construction of any new roads/landings must be pre-approved by the sale administrator. Trails and landings need to be rehabilitated to a satisfactory condition, determined by administering forester, before performance bond is returned. Timber sale administrator shall be notified at least 3 working days prior to completion of hauling and road work. This provides adequate time for permit area inspection and addressing of permit compliance requirements before hauling and road work equipment is removed.

Cutting, Felling, and Skidding
Do not damage reserve trees. Do not fell timber into wetlands or across sale boundaries. Do not disturb survey markers, including witness trees. Sale boundaries painted with orange paint.

Itasca County Timber Appraisal Report

Appraised By: Jesse Lehner Appraisal Date: 06/28/2021	Sale Type: INTERMEDIATE AUCTION Auction Date: 12/14/2021	Appraisal Number: 21-07-10 Permit Number: Expiration Date: 03/01/2024 Page: 2 of 3
--	---	---

Site, Soil, and Water Protection

Filter strips require <5% soil disturbance within 50' of all wetlands.

Roads and skid trails must be stabilized. This may involve installing water bars, strike outs, and/or mulching and seeding.

Reserve all non-merchantable timber within 15ft of all wetlands.

Slash Disposal

Slash must be evenly distributed throughout permit area.

Regeneration Plan

Natural regeneration by way of seed and aspen coppice.

Itasca County Timber Appraisal Report

Appraised By: Jesse Lehner	Sale Type: INTERMEDIATE AUCTION	Appraisal Number: 21-07-10
Appraisal Date: 06/28/2021	Auction Date: 12/14/2021	Permit Number:
		Expiration Date: 03/01/2024
		Page: 3 of 3

Site Map:

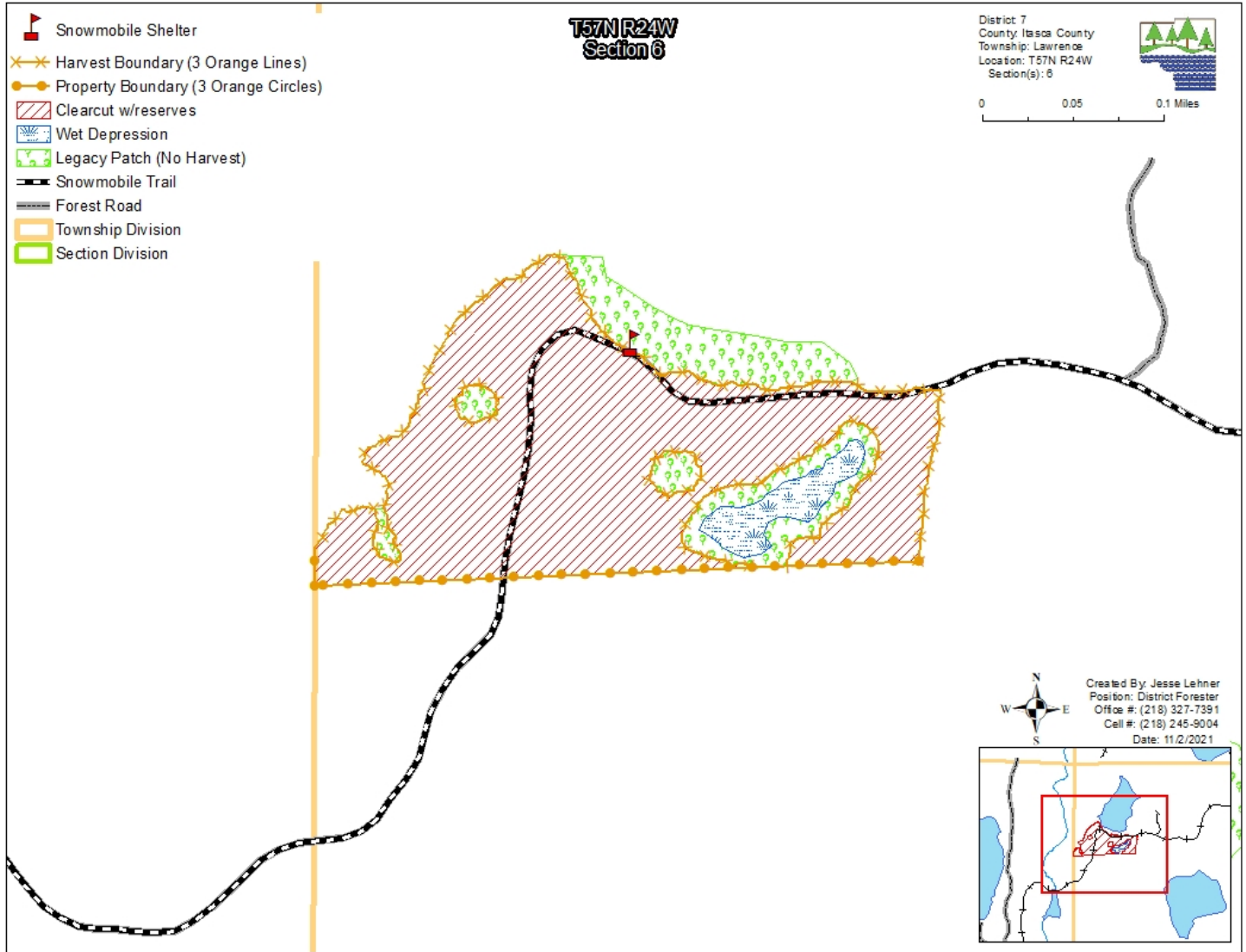

Appraisal examined and approved by _____
Forester
Date

Appraisal examined and approved by _____
Land Department
Date