

Itasca County Timber Appraisal Report

Appraised By:

Jesse Lehner

Appraisal Date:

03/24/2021

Sale Type:

REGULAR AUCTION SALE

Auction Date:

06/09/2021

Appraisal Number: 21-07-12**Permit Number:****Expiration Date:** 03/01/2024**Page:** 1 of 3**Legal Description**

<u>RE Code</u>	<u>Sec.</u>	<u>Twp.</u>	<u>Rge.</u>	<u>City/Twp</u>	<u>Subd</u>			
63-007-1400	7	54	26	Unorganized	SE NE			
68-012-1100	12	54	27	Unorganized	NE NE			
63-007-3000	7	54	26	Unorganized	SW 1/4			
63-007-2000	7	54	26	Unorganized	NW 1/4			
<u>Block 1 Species</u>	<u>Volume</u>	<u>Units</u>	<u>Unit Price</u>	<u>Value</u>	<u>Comments</u>	<u>Bolt %</u>	<u>Bid</u>	
Red Oak	116	Cords	\$20.00	\$2,320.00	4-7 stick, 10-24 inch Dbh, Fair-Good quality, 25% saw	15	^	
Basswood	113	Cords	\$14.00	\$1,582.00	1-8 stick, 6-18 inch Dbh, Fair-Good quality, 30% saw	20	^	
Maple	78	Cords	\$9.00	\$702.00	1-5 stick, 6-14 inch Dbh, Poor-Good quality	0	^	
Aspen	14	Cords	\$22.00	\$308.00	4-9 sticks, 9-22 inch Dbh, Fair quality	10	#	
Ash	11	Cords	\$7.00	\$77.00	2-7 stick, 8-12 inch Dbh, Fair quality	0	#	
				\$4,989.00	Subtotal			
Total Cords =	332		Total MBF: 0	\$4,989.00	Total			

Bid Symbols: ^ = Bid Species; # = Non-Bid Species; + = Sold Area Estimate; * = Sold Area Estimate & Non-Bid Species
All species woodsrun unless listed otherwise.

Species Scaled: Ash , Aspen, Basswood , Maple , Red Oak

Species SAE:

Operability: Summer Dry: 7/1 - 10/1

Soil Type: Itasca-Goodland silt loams

Topography: Level to rolling

Cutting Acres: 19.1

All permits must follow Itasca County Forest Management Guidelines and Specifications (can be found at <http://www.co.itasca.mn.us/DocumentCenter/View/567/Forest-Management-Guidelines-and-Specifications>).

Harvest Specifications

Comments
Harvest type: Marked Hardwood thin & Oak Shelterwood Two Townships

Harvest and Reserves
Marked Hardwood thin: Cut all stems ringed with orange paint. Oak Shelterwood: Cut all stems NOT ringed with blue paint. Reserve all non-hazardous snags and blue ringed trees. Trees marked with "R" are to be reserved for wildlife.

Access
Gate must be locked at all times, except on days when 3 or more loads are hauled. Gates must remain locked during hunting season.

Itasca County Timber Appraisal Report

Appraised By:

Jesse Lehner

Appraisal Date:

03/24/2021

Sale Type:

REGULAR AUCTION SALE

Auction Date:

06/09/2021

Appraisal Number: 21-07-12**Permit Number:****Expiration Date:** 03/01/2024**Page:** 2 of 3

Landings and Access Roads

Location and construction of any new roads/landings must be pre-approved by the sale administrator.

Trails and landings need to be rehabilitated to a satisfactory condition, determined by administering forester, before performance bond is returned.

Timber sale administrator shall be notified at least 3 working days prior to completion of hauling and road work. This provides adequate time for permit area inspection and addressing of permit compliance requirements before hauling and road work equipment is removed.

Cutting, Felling, and Skidding

Timber must be processed at the stump.

Do not damage reserve trees.

Do not fell timber into wetlands or across sale boundaries.

Do not damage regeneration, or reserve trees. Marked Hardwood reserves include all unmarked tree. Marked oak leave tree reserves include all stem ringed with blue paint.

Timber must be processed at the stump.

Site, Soil, and Water Protection

Filter strips require <5% soil disturbance within 50' of all wetlands.

Roads and skid trails must be stabilized. This may involve installing water bars, strike outs, and/or mulching and seeding.

Restricted cutting is allowed within the RMZ. Refer to sale administrator for specific basal area or species specific requirements.

Slash Disposal

Slash must be evenly distributed throughout permit area.

Regeneration Plan

Natural regeneration from seed and stump/root sprouting is expected.

Itasca County Timber Appraisal Report

Appraised By:

Jesse Lehner

Appraisal Date:

03/24/2021

Sale Type:

REGULAR AUCTION SALE

Auction Date:

06/09/2021

Appraisal Number: 21-07-12

Permit Number:

Expiration Date: 03/01/2024

Page: 3 of 3

Site Map:

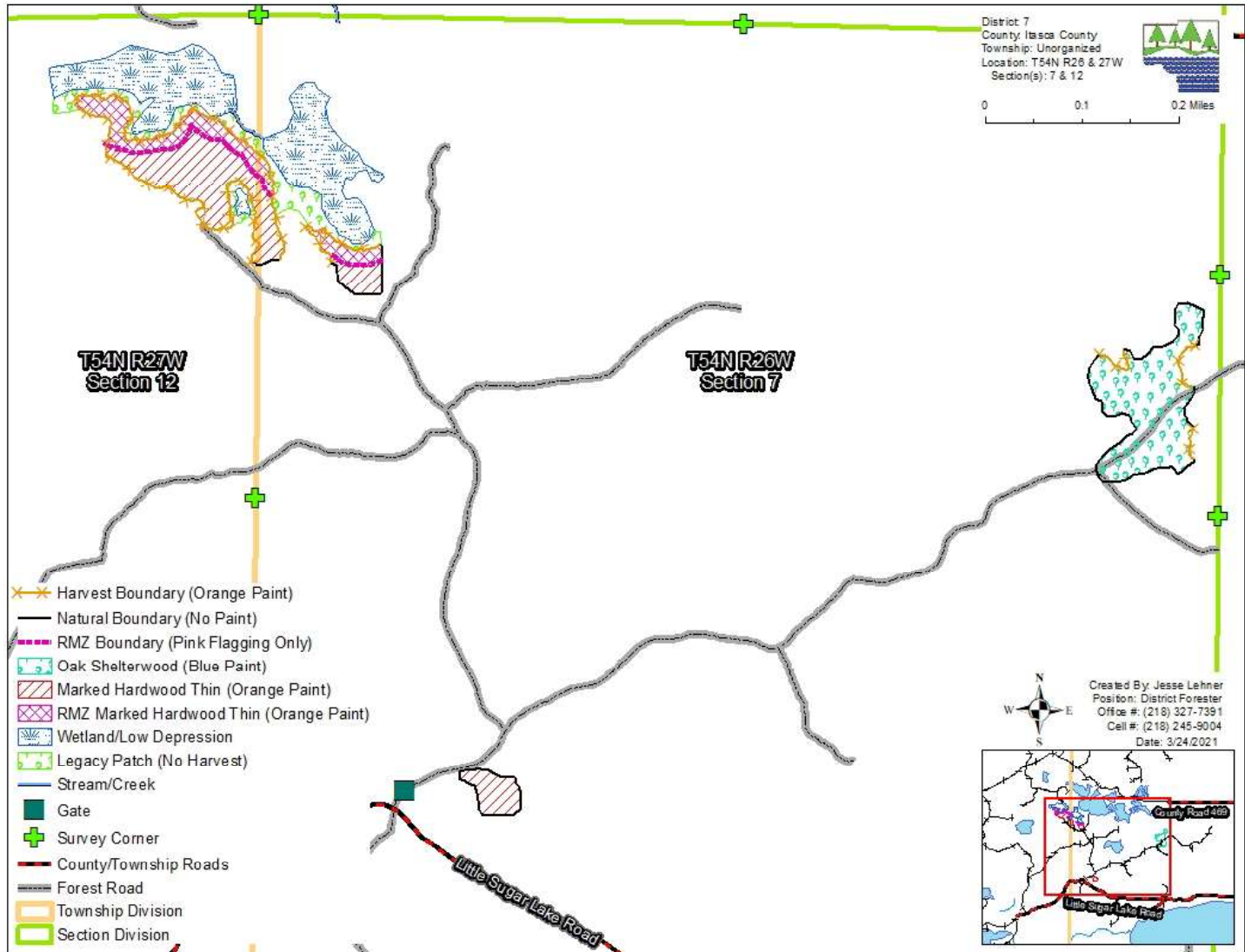

Appraisal examined and approved by _____

Forester

_____ Date

Appraisal examined and approved by _____

Land Department

_____ Date