

Itasca County Timber Appraisal Report

Appraised By: Jesse Lehner Appraisal Date: 04/07/2021	Sale Type: INTERMEDIATE AUCTION Auction Date: 12/14/2021	Appraisal Number: 21-07-14 Permit Number: Expiration Date: 03/01/2024 Page: 1 of 3
--	---	---

Legal Description

<u>RE Code</u>	<u>Sec.</u>	<u>Twp.</u>	<u>Rge.</u>	<u>City/Twp</u>	<u>Subd</u>
14-131-0000	31	55	22	Goodland	ALL SECTION 31
14-006-2000	6	54	22	Goodland	NW 1/4

<u>Block 1 Species</u>	<u>Volume</u>	<u>Units</u>	<u>Unit Price</u>	<u>Value</u>	<u>Comments</u>	<u>Bolt %</u>	<u>Bid</u>
Spruce	317	Cords	\$19.00	\$6,023.00	3-6 stick, 6-10 inch Dbh, Good quality, 100% black spruce	35	^
Tamarack	279	Cords	\$5.00	\$1,395.00	3-7 stick, 6-12 inch Dbh, Good quality		^
				\$7,418.00	Subtotal		
Total Cords =	596	Total MBF: 0		\$7,418.00	Total		

Bid Symbols: ^ = Bid Species; # = Non-Bid Species; + = Sold Area Estimate; * = Sold Area Estimate & Non-Bid Species
 All species woodsrun unless listed otherwise.

Species Scaled: Spruce , Tamarack

Species SAE:

Operability: Winter Frozen: 12/1 - 3/1	Soil Type: Mooselake and Lupton mucky peats & Greenwood peat
Topography: Flat	Cutting Acres: 22.4

All permits must follow Itasca County Forest Management Guidelines and Specifications (can be found at <http://www.co.itasca.mn.us/DocumentCenter/View/567/Forest-Management-Guidelines-and-Specifications>).

Harvest Specifications

Comments
Harvest Type: Clearcut w/reserves
Harvest and Reserves
Reserve all non-hazardous snags. Reserve all species not listed in "Block 1 Species" Trees marked with "R" are to be reserved for wildlife.
Access
Snowmobile trail regulations in Itasca County Forest Management Guideline & Specifications apply. A minimum of two inches of compacted snow must remain on the trail as a running surface. Gate must be locked at all times, except on days when 3 or more loads are hauled.
Landings and Access Roads
Location and construction of any new roads/landings must be pre-approved by the sale administrator. Trails and landings need to be rehabilitated to a satisfactory condition, determined by administering forester, before performance bond is returned. Timber sale administrator shall be notified at least 3 working days prior to completion of hauling and road work. This provides adequate time for permit area inspection and addressing of permit compliance requirements before hauling and road work equipment is removed.
Cutting, Felling, and Skidding
Do not damage reserve trees.
Slash Disposal
Slash must be evenly distributed throughout permit area.

Itasca County Timber Appraisal Report

Appraised By: Jesse Lehner	Sale Type: INTERMEDIATE AUCTION	Appraisal Number: 21-07-14
Appraisal Date: 04/07/2021	Auction Date: 12/14/2021	Permit Number:
		Expiration Date: 03/01/2024
		Page: 2 of 3

Special Conditions

All Black Spruce stems greater than 5ft. must be severed. Mistle Toe prevention

Regeneration Plan

Aerial seeding will be used to reestablish the permit area.

Itasca County Timber Appraisal Report

Appraised By: Jesse Lehner	Sale Type: INTERMEDIATE AUCTION	Appraisal Number: 21-07-14
Appraisal Date: 04/07/2021	Auction Date: 12/14/2021	Permit Number:
		Expiration Date: 03/01/2024
		Page: 3 of 3

Site Map:

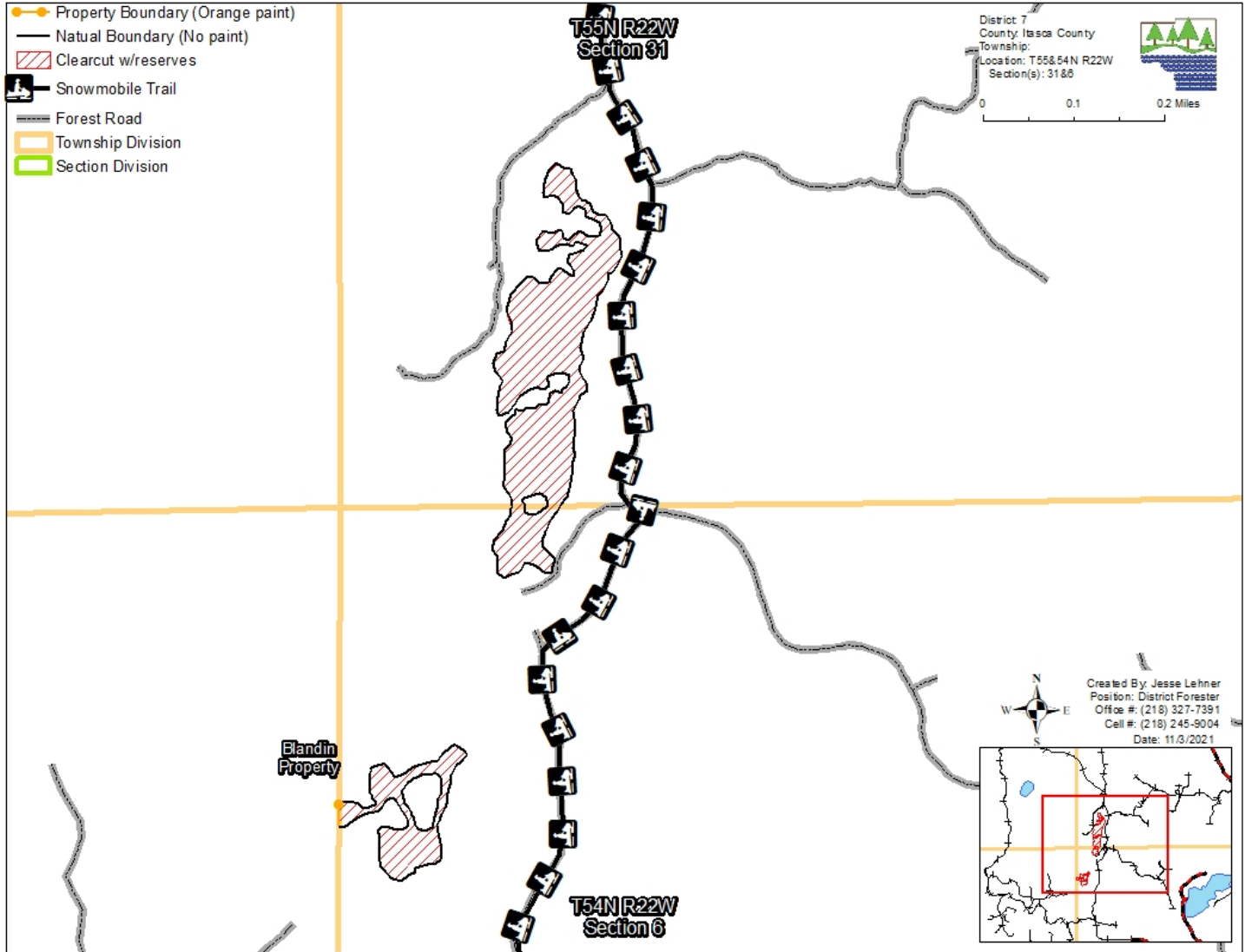

Appraisal examined and approved by _____
Forester Date

Appraisal examined and approved by _____
Land Department Date