

Itasca County Timber Appraisal Report

Appraised By:

Bob Rother

Appraisal Date:

04/13/2022

Sale Type:

REGULAR AUCTION SALE

Auction Date:

12/11/2024

Appraisal Number: 22-01-08**Permit Number:****Expiration Date:** 03/01/2027**Page:** 1 of 3**Legal Description**

RE Code	Sec.	Twp.	Rge.	City/Twp	Subd
42-026-2200	26	53	22	Wawina	NW NW
42-026-2300	26	53	22	Wawina	SW NW
42-022-3400	22	53	22	Wawina	SE SW
42-022-4300	22	53	22	Wawina	SW SE
42-023-3000	23	53	22	Wawina	SW 1/4
42-027-1300	27	53	22	Wawina	SW NE
42-027-1400	27	53	22	Wawina	SE NE
42-022-4400	22	53	22	Wawina	SE SE
42-027-1100	27	53	22	Wawina	NE NE

Block 1 Species	Volume	Units	Unit Price	Value	Comments	Bolt %	Bid
Tamarack	1,575	Cords	\$3.00	\$4,725.00	2-6 Sticks, 5-14" DBH, Fair-Good Condition, 35% Mortality	10	^
Ash	60	Cords	\$12.00	\$720.00	3-5 Sticks, 7-14" DBH, Fair-Good Condition	40	#
Spruce	40	Cords	\$14.00	\$560.00	2-5 Sticks, 5-9" DBH, Fair Condition, All Black Spruce	0	#
Aspen	35	Cords	\$16.00	\$560.00	4-7 Sticks, 7-15" DBH, Fair Condition	0	#
Maple	25	Cords	\$6.00	\$150.00	2-5 Sticks, 7-12" DBH, Fair Condition	0	#
Paper Birch	10	Cords	\$6.00	\$60.00	2-5 Sticks, 7-12" DBH, Fair Condition	0	#
Balsam Fir	10	Cords	\$9.00	\$90.00	2-5 Sticks, 5-12" DBH, Fair Condition	0	#

\$6,865.00 **Subtotal****Total Cords =** 1,755 **Total MBF: 0** **\$6,865.00** **Total**

Bid Symbols: ^ = Bid Species; # = Non-Bid Species; + = Sold Area Estimate; * = Sold Area Estimate & Non-Bid Species
 All species woodsrun unless listed otherwise.

Species Scaled: Ash , Aspen, Balsam Fir, Maple , Paper Birch , Spruce , Tamarack**Species SAE:**

Operability:	Winter Chance - Frozen Ground: 12/15 - 3/1	Soil Type:	Greenwood Peat & Cowhorn loamy very fine sand
Topography:	Level	Cutting Acres:	109.9

All permits must follow Itasca County Forest Management Guidelines and Specifications (can be found at <http://www.co.itasca.mn.us/DocumentCenter/View/567/Forest-Management-Guidelines-and-Specifications>).

Harvest Specifications

Harvest Type
Harvest Type = Tamarack Clearcut with Reserves

Reserve Guidelines
Tamarack types - Where possible reserve one healthy, full-crowned Tamarack seed tree every 60-70 feet. Do not reserve Tamarack that have been recently affected by larch beetles. Within Lowland Hardwood/Ash cover types: reserve balsam fir, yellow birch, elm, & cedar; maintain 30 BA reserve timber which may include reserving ash. Remove largest diameter ash first.

Itasca County Timber Appraisal Report

Appraised By: Bob Rother	Sale Type: REGULAR AUCTION SALE	Appraisal Number: 22-01-08
Appraisal Date: 04/13/2022	Auction Date: 12/11/2024	Permit Number:
		Expiration Date: 03/01/2027
		Page: 2 of 3

Cutting, Felling, and Skidding

Do not damage reserve trees.

Sale boundaries painted Orange slashes (III) and natural. Property boundaries painted Orange circles (oOo).

Access

Private/Easement road may be used to access the timber sale. Access road must be kept in good condition, as determined by administering forester, at all times.

It is the permit holder's responsibility to obtain approval from all affected landowners and/or management agencies before gaining access to the permit area. The permit holder shall pay all access fees and road charges.

0.7 miles to public road County Road 25 in Wawina.

If accessing through Private from the west Enbridge Pipeline must be crossed. This may require timber mats or fill at location of crossing. It is the responsibility of permit holder to contact Enbridge and meet all Enbridge pipeline crossing requirements.

Access from the north does not cross Enbridge Pipeline. This access is across Private land on an Itasca County Management Easement.

Landings and Access Roads

Location and construction of any new roads/landings must be pre-approved by the sale administrator.

Trails and landings need to be rehabilitated to a satisfactory condition, determined by administering forester, before performance bond is returned.

Slash Disposal

Slash must be evenly distributed throughout permit area.

A 10 ft. wide slash free zone must be maintained along roads and trails.

Regeneration Plan

Natural Regeneration to all harvested sale species. Tamarack and Spruce harvest sites may be aerial seeded.

Itasca County Timber Appraisal Report

Appraised By:

Bob Rother

Appraisal Date:

04/13/2022

Sale Type:

REGULAR AUCTION SALE

Auction Date:

12/11/2024

Appraisal Number: 22-01-08

Permit Number:

Expiration Date: 03/01/2027

Page: 3 of 3

Site Map:

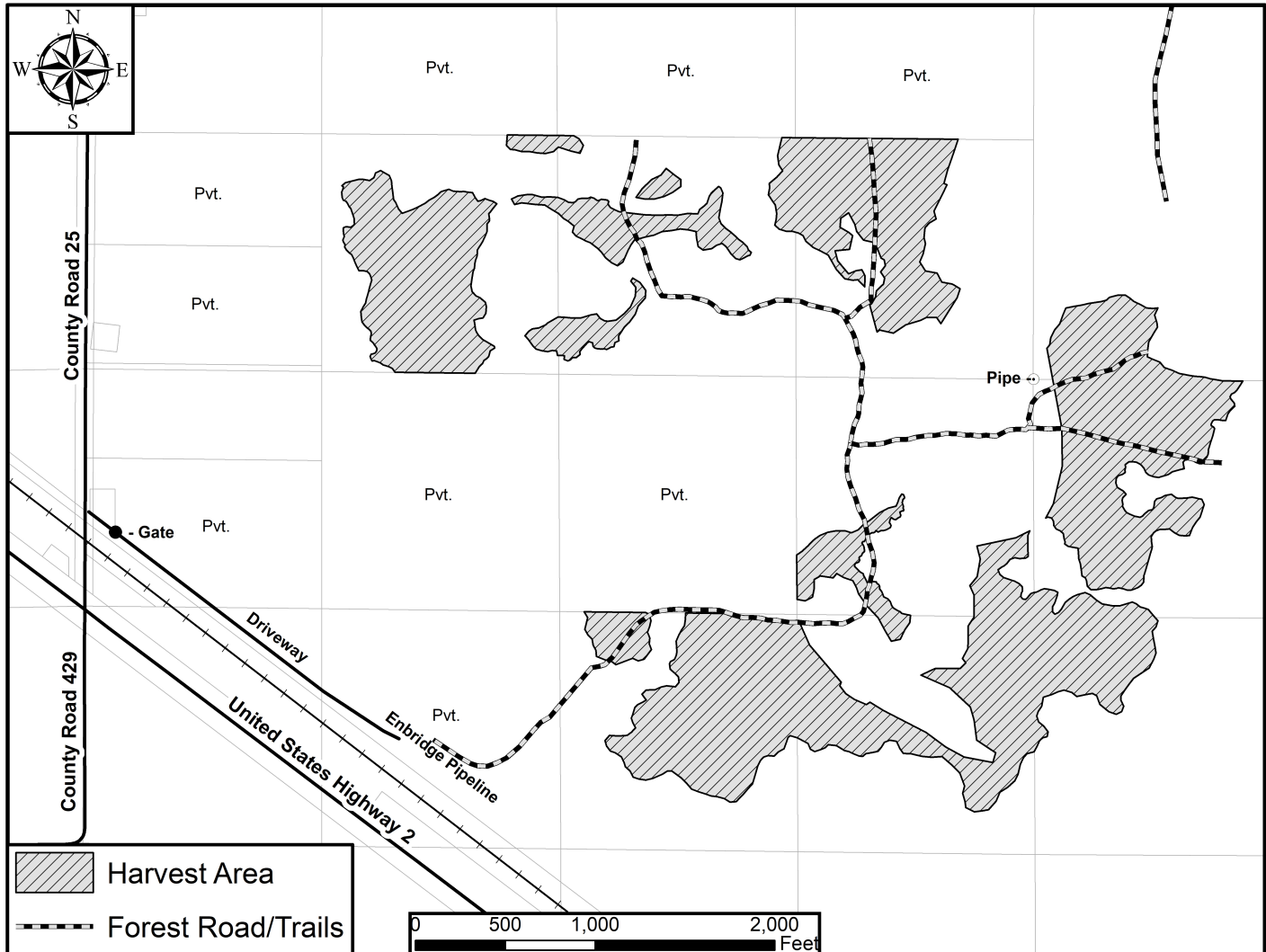

Appraisal examined and approved by

Forester

Date

Appraisal examined and approved by

Land Department

Date