

Itasca County Timber Appraisal Report

Appraised By:

Bob Rother

Appraisal Date:

05/12/2022

Sale Type:

REGULAR AUCTION SALE

Auction Date:

06/05/2024

Appraisal Number: 22-01-12**Permit Number:****Expiration Date:** 03/01/2027**Page:** 1 of 3**Legal Description**

<u>RE Code</u>	<u>Sec.</u>	<u>Twp.</u>	<u>Rge.</u>	<u>City/Twp</u>	<u>Subd</u>		
42-017-1000	17	53	22	Wawina	NE 1/4		
42-016-2400	16	53	22	Wawina	SE NW		
42-017-4000	17	53	22	Wawina	SE 1/4		
42-016-2300	16	53	22	Wawina	SW NW		
<u>Block 1 Species</u>	<u>Volume</u>	<u>Units</u>	<u>Unit Price</u>	<u>Value</u>	<u>Comments</u>	<u>Bolt %</u>	<u>Bid</u>
Ash	480	Cords	\$10.00	\$4,800.00	7"-14" DBH, 4-5 stick avg. Good quality.	50	^
Spruce	415	Cords	\$19.00	\$7,885.00	6"-10" DBH, 4-5 stick avg. Good quality. 100% Black Spruce	30	^
Tamarack	10	Cords	\$4.00	\$40.00	8"-15" DBH, 4-5 stick avg. Poor quality.	10	*
Aspen	80	Cords	\$21.00	\$1,680.00	10"-18" DBH, 5-7 stick avg. Fair quality.	10	#
Balsam Fir	50	Cords	\$8.00	\$400.00	6"-10" DBH, 3-5 stick avg. Fair quality.	15	#
Basswood	10	Cords	\$9.00	\$90.00	10"-15" DBH, 5-7 stick avg. Fair quality.	40	#
Maple	10	Cords	\$7.00	\$70.00	6"-12" DBH, 3-5 stick avg. Fair quality.	5	#
Paper Birch	35	Cords	\$8.00	\$280.00	6"-12" DBH, 3-5 stick avg. Fair quality.	10	#
Balm	12	Cords	\$16.00	\$192.00	8"-14" DBH, 5-6 stick avg. Fair quality.	15	#
				\$15,437.00	Subtotal		
Total Cords =	1,102		Total MBF: 0	\$15,437.00	Total		

Bid Symbols: ^ = Bid Species; # = Non-Bid Species; + = Sold Area Estimate; * = Sold Area Estimate & Non-Bid Species
All species woodsrun unless listed otherwise.

Species Scaled: Ash , Aspen, Balm , Balsam Fir, Basswood , Maple , Paper Birch , Spruce

Species SAE: Tamarack

Operability: Frozen Ground : 12-1 - 3-1

Soil Type: Greenwood Peat & Cowhorn loamy very fine sand. Moose Lake & Iupion peat..

Topography: Level

Cutting Acres: 43.2

All permits must follow Itasca County Forest Management Guidelines and Specifications (can be found at <http://www.co.itasca.mn.us/DocumentCenter/View/567/Forest-Management-Guidelines-and-Specifications>).

Harvest Specifications

Harvest Type
Harvest Type: Operator select black ash thinning from above down to 50 basal area (14.6 acres). Lowland hardwoods clearcut with reserves & black spruce clearcut (28.6 acres)
Reserve Guidelines
Reserve all non-hazardous snags.
Reserve: Elm, Yellow birch, Oaks, Cedar, and conifers, basswood under 3 sticks in ash & lowland hardwood types..

Itasca County Timber Appraisal Report

Appraised By: Bob Rother	Sale Type: REGULAR AUCTION SALE	Appraisal Number: 22-01-12
Appraisal Date: 05/12/2022	Auction Date: 06/05/2024	Permit Number:
		Expiration Date: 03/01/2027
		Page: 2 of 3

Cutting, Felling, and Skidding

Do not damage reserve trees.

Cut 12 ft. access strips in black ash lowlands reserving 40 ft. in between strips for thinning. Thin black ash lowland stands from above down to an average of 50 basal area. Favor the removal of larger diameter, poor quality, unhealthy, and damaged trees.

Do not disturb survey markers, including witness trees painted in orange & marked with pink ribbon..

Sale boundaries painted in orange-Property lines(000), internal boundaries(III).

Access

0.4 mile to public road Wawina D.

Landings and Access Roads

Location and construction of any new roads/landings must be pre-approved by the sale administrator.

Site, Soil, and Water Protection

Filter strips require <5% soil disturbance within 50' of all wetlands.

Can cross intermittent creek / drainage in 1 location. All slash must be pulled from the creek and banks rehabilitated upon sale completion.

Slash Disposal

Slash must be evenly distributed throughout permit area.

Special Conditions

All Black Spruce stems greater than 5ft. must be severed. Mistle Toe prevention

Regeneration Plan

Natural regeneration- Ash, lowland hardwoods. Black spruce type- aerial seed 1 oz./ acre black spruce.

Itasca County Timber Appraisal Report

Appraised By:

Bob Rother

Appraisal Date:

05/12/2022

Sale Type:

REGULAR AUCTION SALE

Auction Date:

06/05/2024

Appraisal Number: 22-01-12

Permit Number:

Expiration Date: 03/01/2027

Page: 3 of 3

Site Map:

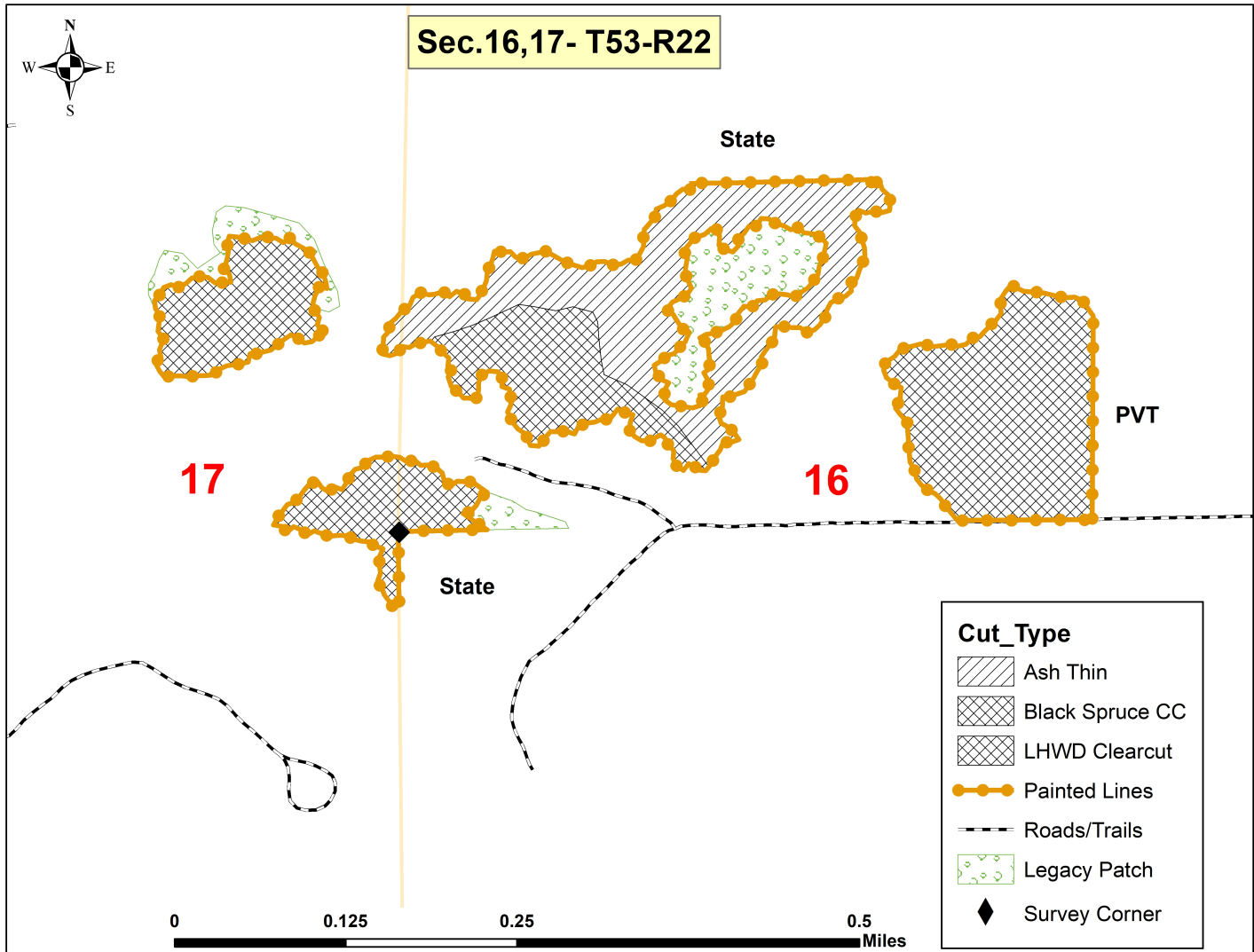

Appraisal examined and approved by

Forester

Date

Appraisal examined and approved by

Land Department

Date