

Itasca County Timber Appraisal Report

Appraised By: Bob Rother	Sale Type: REGULAR AUCTION SALE	Appraisal Number: 22-01-15
Appraisal Date: 08/22/2022	Auction Date: 12/08/2022	Permit Number:
		Expiration Date: 03/01/2025
		Page: 1 of 3

Legal Description

<u>RE Code</u>	<u>Sec.</u>	<u>Twp.</u>	<u>Rge.</u>	<u>City/Twp</u>	<u>Subd</u>		
37-015-2000	15	53	24	Splithand	NW 1/4		
37-010-3200	10	53	24	Splithand	NW SW		
<u>Block 1 Species</u>	<u>Volume</u>	<u>Units</u>	<u>Unit Price</u>	<u>Value</u>	<u>Comments</u>	<u>Bolt %</u>	<u>Bid</u>
Aspen	800	Cords	\$20.00	\$16,000.00	3-6 Sticks, 5-12" DBH, Fair-Good Condition	15	^
Red Pine	50	Cords	\$42.00	\$2,100.00	4-7 Sticks, 8-16" DBH, Fair-Good Condition	50	#
Maple	25	Cords	\$8.00	\$200.00	2-4 Sticks, 5-12" DBH, Fair Condition	0	*
Spruce	10	Cords	\$22.00	\$220.00	3-7 Sticks, 7-15" DBH, Fair-Good Condition, 50% White Spruce	70	*
Balsam Fir	5	Cords	\$11.00	\$55.00	4-6 Sticks, 7-12" DBH, Fair-Good Condition	40	*
Paper Birch	5	Cords	\$8.00	\$40.00	2-4 Sticks, 7-12" DBH, Fair Condition	0	*
Ash	1	Cords	\$8.00	\$8.00	2-4 Sticks, 5-9" DBH, Fair Condition	0	*
				\$18,623.00	Subtotal		
Total Cords =	896			Total MBF: 0	Total		

Bid Symbols: ^ = Bid Species; # = Non-Bid Species; + = Sold Area Estimate; * = Sold Area Estimate & Non-Bid Species
 All species woodsrun unless listed otherwise.

Species Scaled: Aspen, Red Pine
Species SAE: Ash , Balsam Fir, Maple , Paper Birch , Spruce

Operability: Winter Chance - Frozen Ground: 12/1 - 3/1 **Soil Type:** Meehan loamy sand, Menahga and Graycalm soils
Topography: Level **Cutting Acres:** 28.0

All permits must follow Itasca County Forest Management Guidelines and Specifications (can be found at <http://www.co.itasca.mn.us/DocumentCenter/View/567/Forest-Management-Guidelines-and-Specifications>).

Harvest Specifications

Comments
Harvest Type = Aspen Clearcut with Reserves

Harvest and Reserves
Reserve Oak, White Pine, hardwood regeneration patches, 'R' painted trees, and all non-hazardous snags.

Access
Best road access to the sale is through County, State, and private property from the northeast. Access road must be kept in good condition, as determined by administering forester, at all times. It is the permit holder's responsibility to obtain approval from all affected landowners and/or management agencies before gaining access to the permit area. The permit holder shall pay all access fees and road charges. 2.5 miles to public road CR 72.

Landings and Access Roads
Location and construction of any new roads/landings must be pre-approved by the sale administrator. Trails and landings need to be rehabilitated to a satisfactory condition, determined by administering forester, before performance bond is returned.

Itasca County Timber Appraisal Report

Appraised By: Bob Rother Appraisal Date: 08/22/2022	Sale Type: REGULAR AUCTION SALE Auction Date: 12/08/2022	Appraisal Number: 22-01-15 Permit Number: Expiration Date: 03/01/2025 Page: 2 of 3
--	---	---

Cutting, Felling, and Skidding

Do not damage reserve trees.

Sale boundaries painted Orange Slashes (III) and Natural. Property boundaries painted Orange Circles (oOo)

Site, Soil, and Water Protection

Filter strips require <5% soil disturbance within 50' of all wetlands.

Slash Disposal

Slash must be evenly distributed throughout permit area.

Regeneration Plan

Natural Regeneration to Aspen.

Itasca County Timber Appraisal Report

Appraised By: Bob Rother	Sale Type: REGULAR AUCTION SALE	Appraisal Number: 22-01-15
Appraisal Date: 08/22/2022	Auction Date: 12/08/2022	Permit Number:
		Expiration Date: 03/01/2025
		Page: 3 of 3

Site Map:

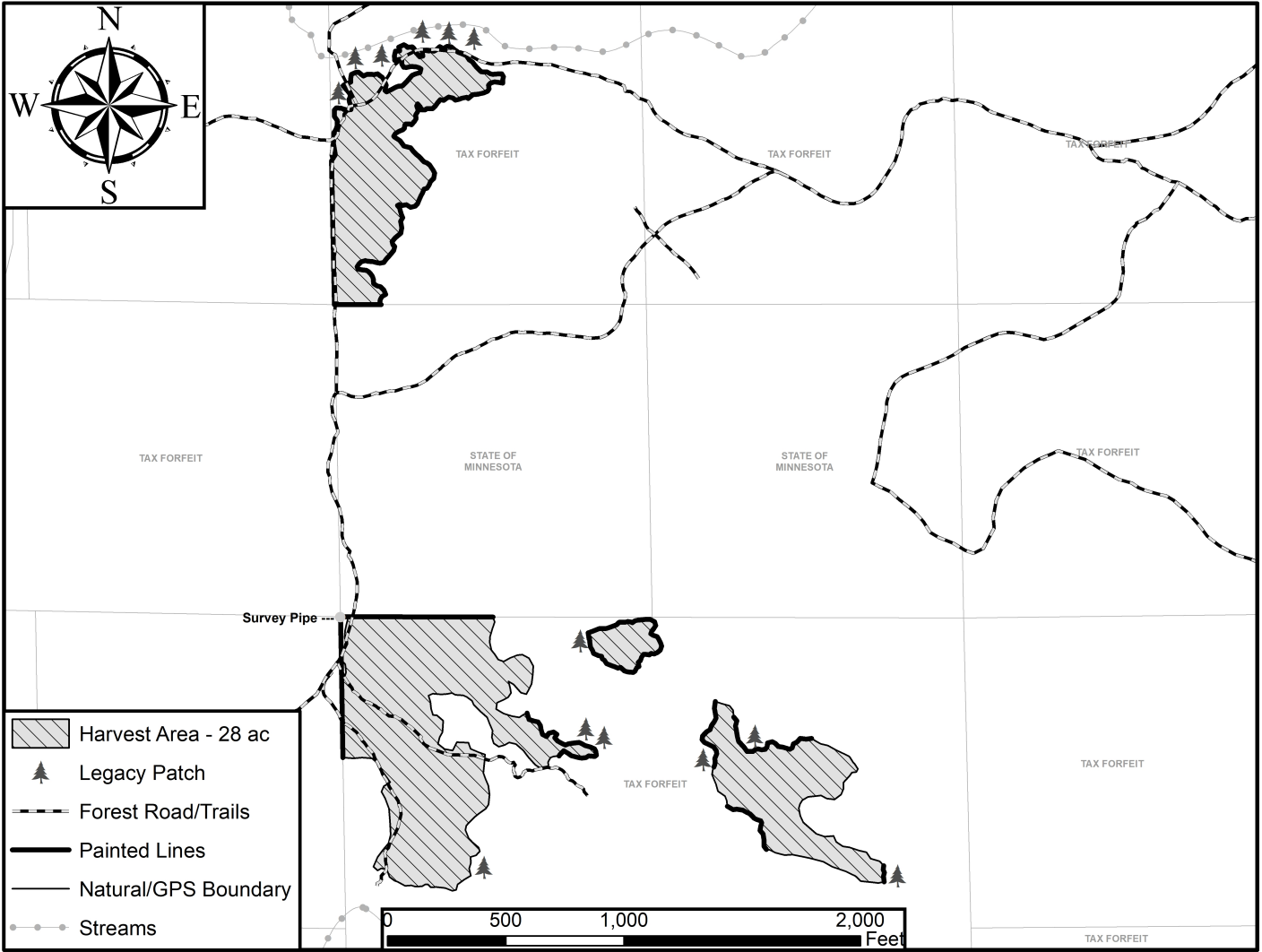

Appraisal examined and approved by _____
Forester
Date

Appraisal examined and approved by _____
Land Department
Date