

# Itasca County Timber Appraisal Report

<b>Appraised By:</b> Bob Rother  <b>Appraisal Date:</b> 10/13/2022	<b>Sale Type:</b> REGULAR AUCTION SALE  <b>Auction Date:</b> 12/14/2023	<b>Appraisal Number:</b> 22-01-19 <b>Permit Number:</b> <b>Expiration Date:</b> 03/01/2026 <b>Page:</b> 1 of 3
--	---	---

**Legal Description**

<u>RE Code</u>	<u>Sec.</u>	<u>Twp.</u>	<u>Rge.</u>	<u>City/Twp</u>	<u>Subd</u>		
14-031-2200	31	54	22	Goodland	LOT 1		
<u>Block 1 Species</u>	<u>Volume</u>	<u>Units</u>	<u>Unit Price</u>	<u>Value</u>	<u>Comments</u>	<u>Bolt %</u>	<u>Bid</u>
Basswood	100	Cords	\$15.00	\$1,500.00	4-7 Sticks, 8-19" DBH, Fair-Good Condition, 15% Saw	50	^
Aspen	10	Cords	\$18.00	\$180.00	5-6 Sticks, 9-15" DBH, Fair-Good Condition	30	+
Maple	3	Cords	\$6.00	\$18.00	3-4 Sticks, 5-9" DBH, Fair Condition	0	+
Paper Birch	3	Cords	\$6.00	\$18.00	4-5 Sticks, 9-12" DBH, Fair Condition	50	+
Balsam Fir	3	Cords	\$7.00	\$21.00	2-4 Sticks, 5-9" DBH, Fair Condition	0	+
				\$1,737.00	<b>Subtotal</b>		
<b>Total Cords =</b>	119	<b>Total MBF: 0</b>		\$1,737.00	<b>Total</b>		

Bid Symbols: ^ = Bid Species; # = Non-Bid Species; + = Sold Area Estimate; \* = Sold Area Estimate & Non-Bid Species  
 All species woodsrun unless listed otherwise.

**Species Scaled:** Basswood  
**Species SAE:** Aspen, Balsam Fir, Maple , Paper Birch

**Operability:** Winter Chance - Frozen Ground: 12/1 - 3/1      **Soil Type:** Itasca-Goodland silt loams  
**Topography:** Level to rolling      **Cutting Acres:** 10.0

All permits must follow Itasca County Forest Management Guidelines and Specifications (can be found at <http://www.co.itasca.mn.us/DocumentCenter/View/567/Forest-Management-Guidelines-and-Specifications> ).

**Harvest Specifications**

Harvest Type
Harvest Type = Marked Hardwood Thin

Cutting, Felling, and Skidding
NO full tree/whole tree skidding across harvest area. Cut trees marked with orange paint. Cut as much ironwood as possible. Sale boundaries painted Orange Slashes (   ) or Natural, and property boundaries painted Orange Circles (oOo). Do not damage unmarked trees, regeneration, or reserve trees.

Access
Sale is located on public road County Road 74. A temporary approach needs to be constructed.

Landings and Access Roads
Location and construction of any new roads/landings must be pre-approved by the sale administrator. Trails and landings need to be rehabilitated to a satisfactory condition, determined by administering forester, before performance bond is returned. Landings must be kept back at least 100 feet from CR 74.

Slash Disposal
Slash must be evenly distributed throughout permit area. Slash height must not exceed 3 feet within view of road.

**Itasca County Timber Appraisal Report**

<b>Appraised By:</b> Bob Rother	<b>Sale Type:</b> REGULAR AUCTION SALE	<b>Appraisal Number:</b> 22-01-19
<b>Appraisal Date:</b> 10/13/2022	<b>Auction Date:</b> 12/14/2023	<b>Permit Number:</b>
		<b>Expiration Date:</b> 03/01/2026
		<b>Page:</b> 2 of 3

**Regeneration Plan**

Due to nature of managed species and type of harvest little to no tree regeneration is expected to occur after harvest.

# Itasca County Timber Appraisal Report

<b>Appraised By:</b> Bob Rother	<b>Sale Type:</b> REGULAR AUCTION SALE	<b>Appraisal Number:</b> 22-01-19
<b>Appraisal Date:</b> 10/13/2022	<b>Auction Date:</b> 12/14/2023	<b>Permit Number:</b>
		<b>Expiration Date:</b> 03/01/2026
		<b>Page:</b> 3 of 3

**Site Map:**

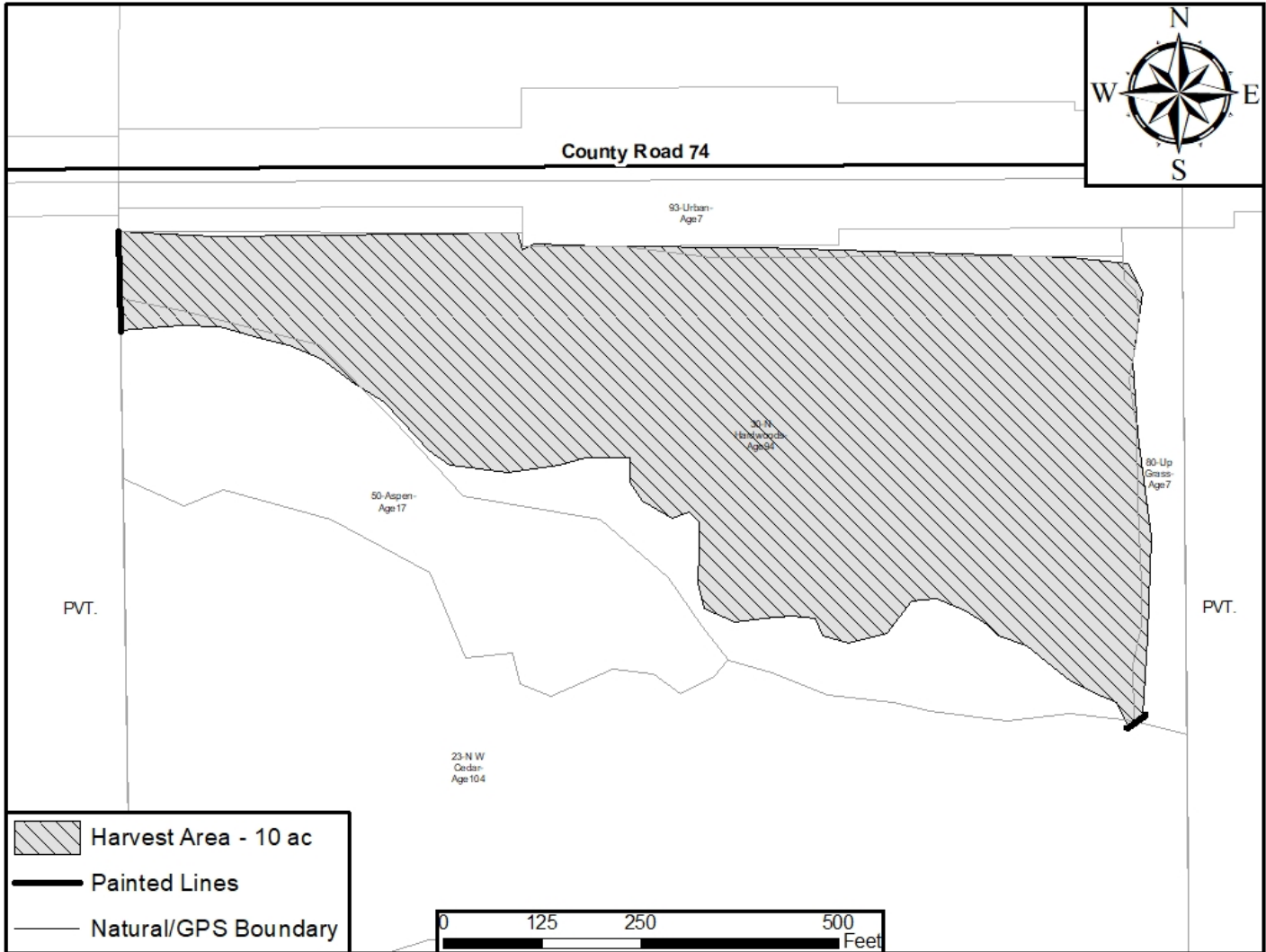

Appraisal examined and approved by \_\_\_\_\_  
Forester Date

Appraisal examined and approved by \_\_\_\_\_  
Land Department Date