

Itasca County Timber Appraisal Report

Appraised By: Casey Dabrowski Appraisal Date: 01/28/2022	Sale Type: REGULAR AUCTION SALE Auction Date: 06/08/2022	Appraisal Number: 22-02-02 Permit Number: Expiration Date: 03/01/2025 Page: 1 of 3
---	---	---

Legal Description

<u>RE Code</u>	<u>Sec.</u>	<u>Twp.</u>	<u>Rge.</u>	<u>City/Twp</u>	<u>Subd</u>
10-122-3300	22	62	23	Carpenter	SW SW
10-121-4400	21	62	23	Carpenter	SE SE
10-121-4100	21	62	23	Carpenter	NE SE
10-121-4200	21	62	23	Carpenter	NW SE

<u>Block 1 Species</u>	<u>Volume</u>	<u>Units</u>	<u>Unit Price</u>	<u>Value</u>	<u>Comments</u>	<u>Bolt %</u>	<u>Bid</u>
Red Pine	590	Cords	\$25.00	\$14,750.00	6-20", 4-9 st, 25% saw. Good.	55	^
Paper Birch	115	Cords	\$8.00	\$920.00	7-12", 4-6 st, Fair/poor.	5	#
White Pine	65	Cords	\$11.00	\$715.00	6-15", 3-7 st, Poor.	10	#
Balsam Fir	24	Cords	\$5.00	\$120.00	5-10", 2-5 st, Fair.	0	#
Aspen	20	Cords	\$18.00	\$360.00	6-15", 3-7 st, Fair/poor.	0	#
Jack Pine	12	Cords	\$8.00	\$96.00	6-8", 3-4 st, Poor.	0	#

\$16,961.00 **Subtotal**

Total Cords = 826 **Total MBF: 0** \$16,961.00 **Total**

Bid Symbols: ^ = Bid Species; # = Non-Bid Species; + = Sold Area Estimate; * = Sold Area Estimate & Non-Bid Species
 All species woodsrun unless listed otherwise.

Species Scaled: Aspen, Balsam Fir, Jack Pine, Paper Birch , Red Pine, White Pine

Species SAE:

Operability: Summer: 5/1 - 3/1	Soil Type: Cutaway loamy sand, Menahga-Graycalm loamy sand
Topography: Level to rolling	Cutting Acres: 37.6

All permits must follow Itasca County Forest Management Guidelines and Specifications (can be found at <http://www.co.itasca.mn.us/DocumentCenter/View/567/Forest-Management-Guidelines-and-Specifications>).

Harvest Specifications

Comments
Harvest type: operator select pine thin. Stands range in age from 35-110 years. Most areas were thinned previously.

Itasca County Timber Appraisal Report

Appraised By: Casey Dabrowski Appraisal Date: 01/28/2022	Sale Type: REGULAR AUCTION SALE Auction Date: 06/08/2022	Appraisal Number: 22-02-02 Permit Number: Expiration Date: 03/01/2025 Page: 2 of 3
---	---	---

Harvest and Reserves

Use existing access strips or gaps between timber where available. Otherwise, cut 12 ft. access strips reserving 40 ft. in between strips for thinning.

Remove all mature paper birch 3 sticks and greater.

Target removal of mature pine when doing so will release well-formed young timber, including white pine, red pine, spruce, and hardwoods.

Target removal of diseased white pine with deformed crowns.

Favor the removal of declining, suppressed, poor quality, and damaged trees.

Thin mature pine until remaining well-formed crop trees are free to grow on 3 sides, which will result in variable stocking but average 100 BA across the site.

Thin younger planted pine types to 110 BA average.

A one acre example patch shown on map has been marked to demonstrate the thinning being prescribed in the mature pine types.

Favor retention of healthy and high quality white pine over red pine.

Reserve all non-hazardous snags.

Trees marked with "R" are to be reserved for wildlife.

Reserve all species with no appraised volume, including maple, oak, spruce.

Access

Main access road is a part of the Thistledeew ATV trail. Trail must be cleared of debris and reopened for use following harvest activities. ATV trail closure and/or signage will be administered by the county.

0 miles to public road County Road 542.

Landings and Access Roads

Location and construction of any new roads/landings must be pre-approved by the sale administrator.

Trails and landings need to be rehabilitated to a satisfactory condition, determined by administering forester, before performance bond is returned.

Landings must be kept back at least 100' from county road.

Timber sale administrator shall be notified at least 3 working days prior to completion of hauling and road work. This provides adequate time for permit area inspection and addressing of permit compliance requirements before hauling and road work equipment is removed.

Cutting, Felling, and Skidding

Timber must be processed at the stump.

Do not damage reserve trees.

Do not fell timber into wetlands or across sale boundaries.

Do not disturb survey markers, including witness trees, which have been painted orange.

Sale boundaries painted with orange lines (I I I). Ownership boundaries painted with orange circles (O O O).

Site, Soil, and Water Protection

Filter strips require <5% soil disturbance within 50' of all wetlands.

Reserve all non-merchantable timber within 15ft of all wetlands.

Slash Disposal

A 10 ft. wide slash free zone must be maintained along roads and trails.

Regeneration Plan

Intermediate treatment; little to no regeneration expected.

Itasca County Timber Appraisal Report

Appraised By: Casey Dabrowski Appraisal Date: 01/28/2022	Sale Type: REGULAR AUCTION SALE Auction Date: 06/08/2022	Appraisal Number: 22-02-02 Permit Number: Expiration Date: 03/01/2025 Page: 3 of 3
---	---	---

Site Map:

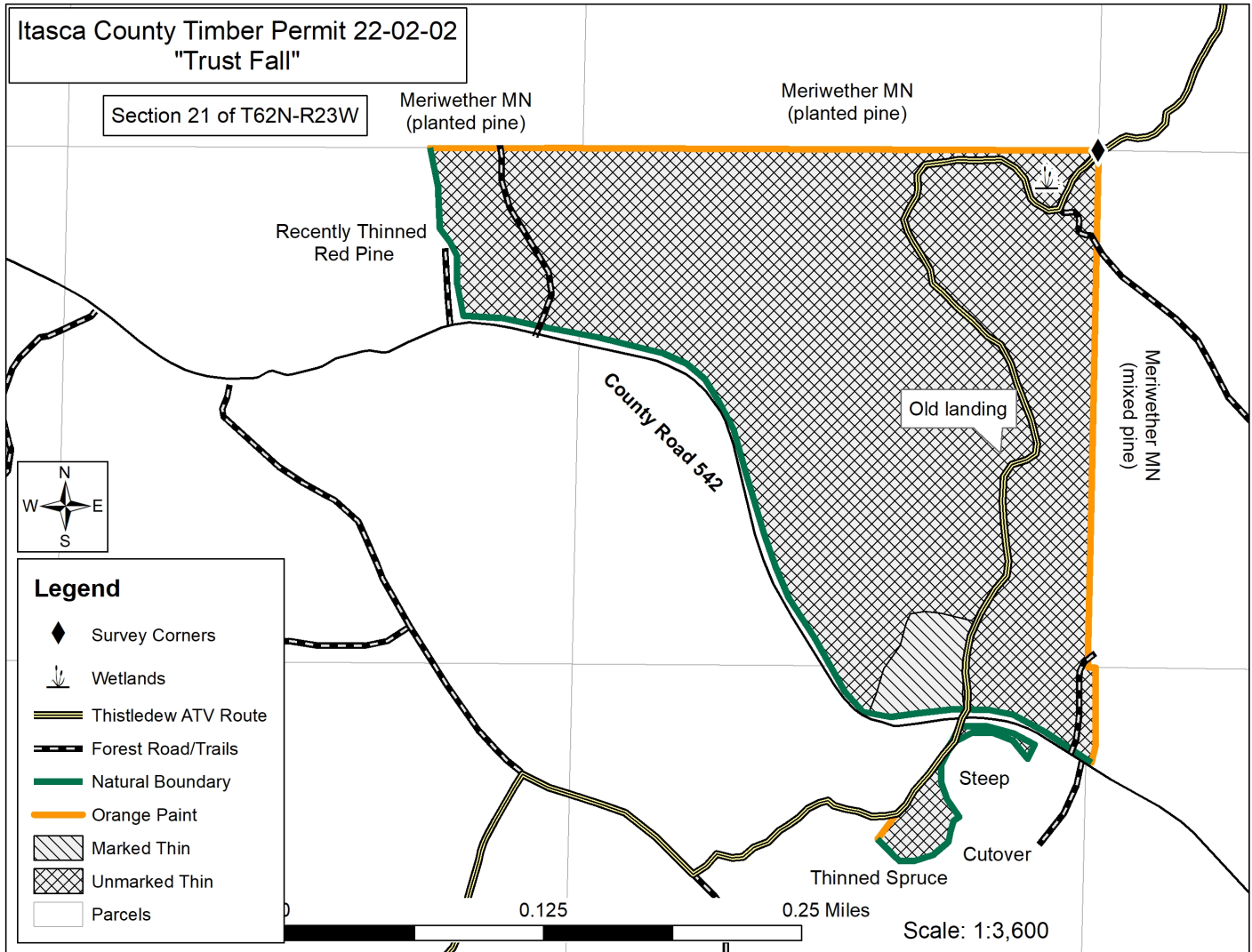

Appraisal examined and approved by _____
Forester Date

Appraisal examined and approved by _____
Land Department Date