

Itasca County Timber Appraisal Report

Appraised By: Casey Dabrowski Appraisal Date: 03/16/2022	Sale Type: REGULAR AUCTION SALE Auction Date: 06/08/2022	Appraisal Number: 22-02-07 Permit Number: Expiration Date: 03/01/2025 Page: 1 of 3
---	---	---

Legal Description

<u>RE Code</u>	<u>Sec.</u>	<u>Twp.</u>	<u>Rge.</u>	<u>City/Twp</u>	<u>Subd</u>		
67-019-4300	19	62	26	Unorganized	SW SE		
67-019-3000	19	62	26	Unorganized	SW 1/4		
<u>Block 1 Species</u>	<u>Volume</u>	<u>Units</u>	<u>Unit Price</u>	<u>Value</u>	<u>Comments</u>	<u>Bolt %</u>	<u>Bid</u>
Aspen	995	Cords	\$24.00	\$23,880.00	5-8", 3-5 st, Good.	0	^
Balm	55	Cords	\$24.00	\$1,320.00	5-8", 3-5 st, Good.	0	#
				\$25,200.00	Subtotal		
Total Cords =		1,050	Total MBF: 0		\$25,200.00	Total	

Bid Symbols: ^ = Bid Species; # = Non-Bid Species; + = Sold Area Estimate; * = Sold Area Estimate & Non-Bid Species
 All species woodsrun unless listed otherwise.

Species Scaled: Aspen, Balm

Species SAE:

Operability: Winter - Frozen Ground: 12/1 - 3/1	Soil Type: Effie Loam, Wildwood Muck
Topography: Level	Cutting Acres: 34.0

All permits must follow Itasca County Forest Management Guidelines and Specifications (can be found at <http://www.co.itasca.mn.us/DocumentCenter/View/567/Forest-Management-Guidelines-and-Specifications>).

Harvest Specifications

Comments
Harvest Type: clearcut with reserves.

Harvest and Reserves
Harvest all aspen and balm. Reserve all other species, including maple, ash, elm, birch, balsam, spruce, basswood. Reserve patches of advance regeneration basswood and maple. Reserve all non-hazardous snags. Trees marked with "R" are to be reserved for wildlife.

Access
0.1 miles to public road State Highway 1.

Landings and Access Roads
Location and construction of any new landings must be pre-approved by the sale administrator. No new road construction will be permitted. Trails and landings need to be rehabilitated to a satisfactory condition, determined by administering forester, before performance bond is returned. Timber sale administrator shall be notified at least 3 working days prior to completion of hauling and road work. This provides adequate time for permit area inspection and addressing of permit compliance requirements before hauling and road work equipment is removed.

Cutting, Felling, and Skidding
Do not damage regeneration or reserve trees. Do not fell timber into wetlands or across sale boundaries. Sale boundaries painted with orange lines (I I I). Ownership boundaries painted with orange circles (O O O). Natural boundary is also used; see sale map.

Itasca County Timber Appraisal Report

Appraised By: Casey Dabrowski	Sale Type: REGULAR AUCTION SALE	Appraisal Number: 22-02-07
Appraisal Date: 03/16/2022	Auction Date: 06/08/2022	Permit Number:
		Expiration Date: 03/01/2025
		Page: 2 of 3

Site, Soil, and Water Protection

Filter strips require <5% soil disturbance within 50' of all wetlands.
Reserve all non-merchantable timber within 15ft of all wetlands.

Slash Disposal

Slash must be evenly distributed throughout permit area.

Regeneration Plan

Natural regeneration to aspen and mixed hardwoods.

Itasca County Timber Appraisal Report

Appraised By: Casey Dabrowski	Sale Type: REGULAR AUCTION SALE	Appraisal Number: 22-02-07
Appraisal Date: 03/16/2022	Auction Date: 06/08/2022	Permit Number:
		Expiration Date: 03/01/2025
		Page: 3 of 3

Site Map:

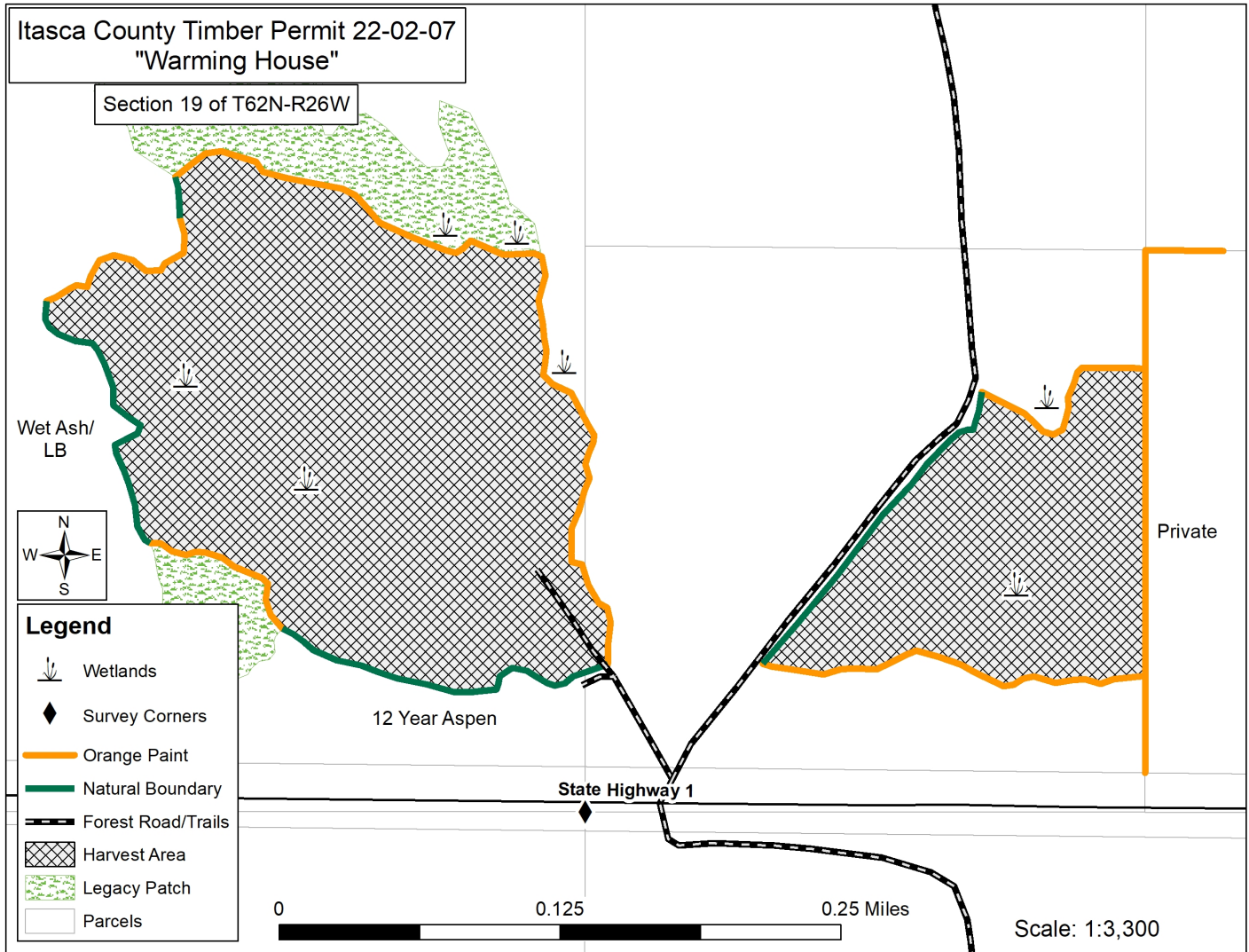

Appraisal examined and approved by _____
Forester Date

Appraisal examined and approved by _____
Land Department Date