

# Itasca County Timber Appraisal Report

<b>Appraised By:</b> Casey Dabrowski  <b>Appraisal Date:</b> 04/15/2022	<b>Sale Type:</b> INTERMEDIATE AUCTION  <b>Auction Date:</b> 06/08/2022	<b>Appraisal Number:</b> 22-02-09 <b>Permit Number:</b> <b>Expiration Date:</b> 03/01/2025 <b>Page:</b> 1 of 3
---	---	---

**Legal Description**

<u>RE Code</u>	<u>Sec.</u>	<u>Twp.</u>	<u>Rge.</u>	<u>City/Twp</u>	<u>Subd</u>		
10-128-4000	28	62	23	Carpenter	SE 1/4		
<u>Block 1 Species</u>	<u>Volume</u>	<u>Units</u>	<u>Unit Price</u>	<u>Value</u>	<u>Comments</u>	<u>Bolt %</u>	<u>Bid</u>
Aspen	215	Cords	\$24.00	\$5,160.00	8-13", 5-7 st, Good.	5	^
Balsam Fir	65	Cords	\$8.00	\$520.00	6-10", 3-5 st, Fair.	10	#
Paper Birch	55	Cords	\$8.00	\$440.00	7-12", 3-5 st, Fair.	0	#
				\$6,120.00	<b>Subtotal</b>		
<b>Total Cords =</b>		335	<b>Total MBF: 0</b>		\$6,120.00	<b>Total</b>	

Bid Symbols: ^ = Bid Species; # = Non-Bid Species; + = Sold Area Estimate; \* = Sold Area Estimate & Non-Bid Species  
 All species woodsrun unless listed otherwise.

**Species Scaled:** Aspen, Balsam Fir, Paper Birch

**Species SAE:**

<b>Operability:</b> Summer - Dry soil conditions: 6/1 - 10/1, Winter - Frozen soil conditions: 12/1 - 3/1	<b>Soil Type:</b> Baudette silt loam
<b>Topography:</b> Level to rolling	<b>Cutting Acres:</b> 10.8

All permits must follow Itasca County Forest Management Guidelines and Specifications (can be found at <http://www.co.itasca.mn.us/DocumentCenter/View/567/Forest-Management-Guidelines-and-Specifications> ).

**Harvest Specifications**

Comments
Harvest Type: Clearcut with reserves.

Harvest and Reserves
Harvest all aspen; harvest birch and balsam 3 sticks and greater. Reserve all spruce, maple, oak, cedar, pine, basswood; reserve birch/balsam under 3 sticks and patches of advance regeneration. Everywhere will be 30 BA or less except in single pine clump. Reserve all non-hazardous snags. Trees marked with "R" are to be reserved for wildlife.

Access
Easiest access is through private land. Access via tax forfeit-only is available but will require new construction. State is offering timber to west on a future auction and may allow extension of existing road. It is the permit holder's responsibility to obtain approval from all affected landowners and/or management agencies before gaining access to the permit area. The permit holder shall pay all access fees and road charges. If private or state road is used to access the timber sale, access road must be kept in good condition, as determined by administering forester, at all times. 0.25 miles to public road County Road 562.

Landings and Access Roads
Location and construction of any new roads/landings must be pre-approved by the sale administrator. Trails and landings need to be rehabilitated to a satisfactory condition, determined by administering forester, before performance bond is returned. Timber sale administrator shall be notified at least 3 working days prior to completion of hauling and road work. This provides adequate time for permit area inspection and addressing of permit compliance requirements before hauling and road work equipment is removed.

## Itasca County Timber Appraisal Report

<b>Appraised By:</b> Casey Dabrowski <b>Appraisal Date:</b> 04/15/2022	<b>Sale Type:</b> INTERMEDIATE AUCTION <b>Auction Date:</b> 06/08/2022	<b>Appraisal Number:</b> 22-02-09 <b>Permit Number:</b> <b>Expiration Date:</b> 03/01/2025 <b>Page:</b> 2 of 3
---	---	---

### Cutting, Felling, and Skidding

Do not fell timber into wetlands or across sale boundaries.

If harvested whole tree, concentrated skidding will be required to minimize damage to reserves.

Sale boundaries painted with orange lines (I I I). Ownership boundaries painted with orange circles (O O O). Natural boundaries are also used; see sale map.

### Site, Soil, and Water Protection

Filter strips require <5% soil disturbance within 50' of all wetlands.

Reserve all non-merchantable timber within 15ft of all wetlands.

### Slash Disposal

Slash must be evenly distributed throughout permit area.

### Regeneration Plan

Natural regeneration to aspen, birch, and mixed conifer/hardwoods.

# Itasca County Timber Appraisal Report

<b>Appraised By:</b> Casey Dabrowski	<b>Sale Type:</b> INTERMEDIATE AUCTION	<b>Appraisal Number:</b> 22-02-09
<b>Appraisal Date:</b> 04/15/2022	<b>Auction Date:</b> 06/08/2022	<b>Permit Number:</b>
		<b>Expiration Date:</b> 03/01/2025
		<b>Page:</b> 3 of 3

**Site Map:**

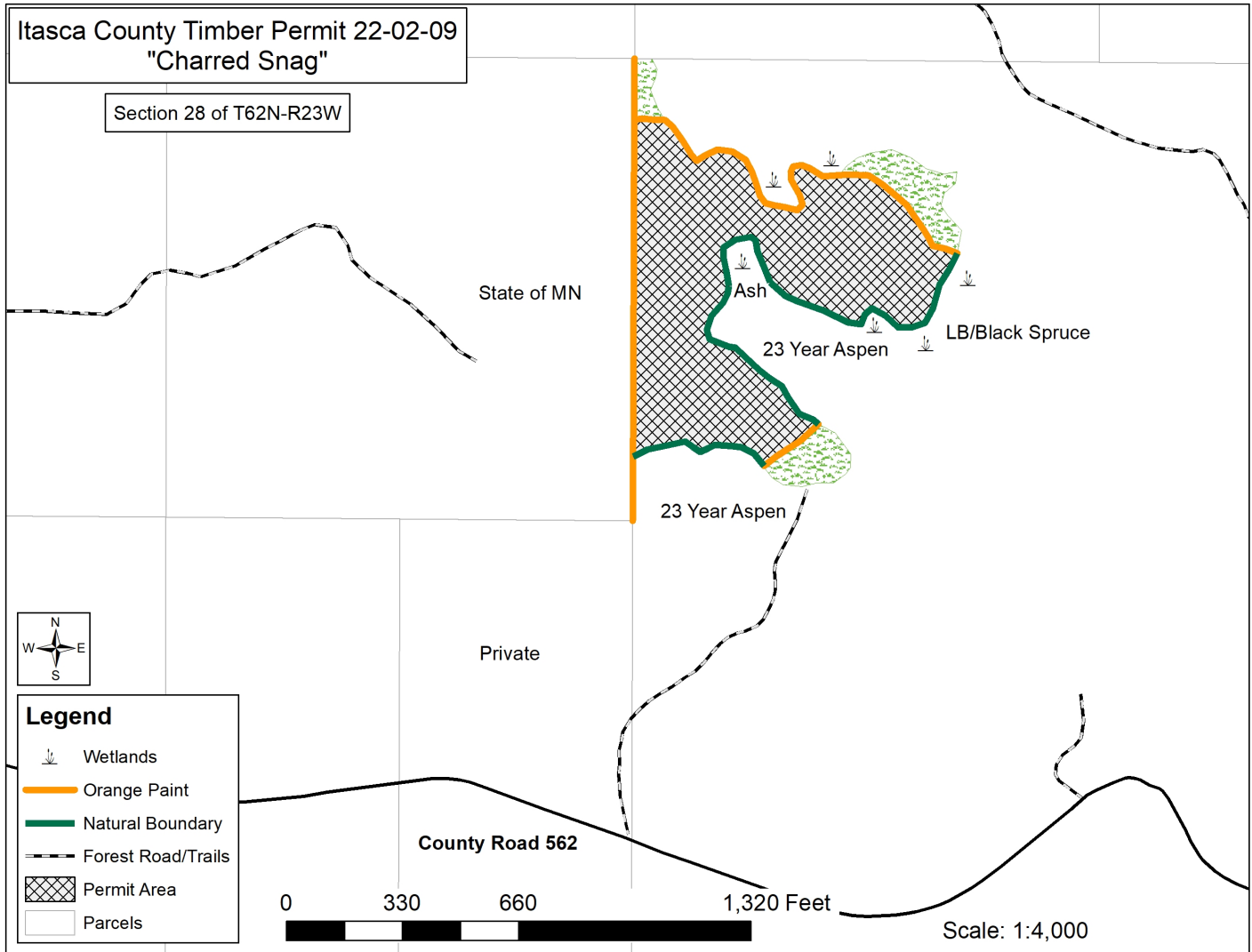

Appraisal examined and approved by \_\_\_\_\_  
Forester Date

Appraisal examined and approved by \_\_\_\_\_  
Land Department Date