

Itasca County Timber Appraisal Report

Appraised By: Nick Schreiber Appraisal Date: 01/19/2022	Sale Type: REGULAR AUCTION SALE Auction Date: 06/08/2022	Appraisal Number: 22-03-02 Permit Number: Expiration Date: 03/01/2025 Page: 1 of 3
--	---	---

Legal Description

<u>RE Code</u>	<u>Sec.</u>	<u>Twp.</u>	<u>Rge.</u>	<u>City/Twp</u>	<u>Subd</u>
55-003-1200	3	59	24	Unorganized	LOT 2
56-033-4400	33	60	24	Unorganized	SE SE
55-004-1400	4	59	24	Unorganized	SE NE
55-003-1100	3	59	24	Unorganized	LOT 1
55-003-2100	3	59	24	Unorganized	LOT 3
56-034-3300	34	60	24	Unorganized	SW SW
55-004-1100	4	59	24	Unorganized	LOT 1

<u>Block 1 Species</u>	<u>Volume</u>	<u>Units</u>	<u>Unit Price</u>	<u>Value</u>	<u>Comments</u>	<u>Bolt %</u>	<u>Bid</u>
Aspen	2,445	Cords	\$29.00	\$70,905.00	4-7 sticks, 45-61 yrs. old.	30	^
Red Pine	122	Cords	\$48.00	\$5,856.00	7-8 sticks, 65% sawlogs.	25	#
Maple	51	Cords	\$9.00	\$459.00	3-5 sticks, wolfy.	0	#
Paper Birch	43	Cords	\$13.00	\$559.00	4-6 sticks.	30	#
Spruce	34	Cords	\$20.00	\$680.00	4-7 sticks, all white spruce.	60	#
Balsam Fir	25	Cords	\$9.00	\$225.00	3-6 sticks.	10	#
Jack Pine	20	Cords	\$25.00	\$500.00	6-7 sticks.	60	#

\$79,184.00 **Subtotal**

Total Cords = 2,740 **Total MBF: 0** \$79,184.00 **Total**

Bid Symbols: ^ = Bid Species; # = Non-Bid Species; + = Sold Area Estimate; * = Sold Area Estimate & Non-Bid Species
 All species woodsrun unless listed otherwise.

Species Scaled: Aspen, Balsam Fir, Jack Pine, Maple , Paper Birch , Red Pine, Spruce

Species SAE:

Operability: Summer Chance: 7/1 - 3/1 **Soil Type:** 620B Cutaway loamy sand. 622B Nashwauk fine sandy loam. 867B Menahga and Graycalm.

Topography: Level/rolling; some steep **Cutting Acres:** 78.0

All permits must follow Itasca County Forest Management Guidelines and Specifications (can be found at <http://www.co.itasca.mn.us/DocumentCenter/View/567/Forest-Management-Guidelines-and-Specifications>).

Harvest Specifications

Comments
Harvest Type: aspen clearcut with reserves.

Harvest and Reserves
Reserve all red pine on western blocks and red pine <12" on eastern blocks. Also reserve white pine, oak, non-merchantable birch, maple, and balsam along with non-hazardous snags.

Itasca County Timber Appraisal Report

Appraised By: Nick Schreiber Appraisal Date: 01/19/2022	Sale Type: REGULAR AUCTION SALE Auction Date: 06/08/2022	Appraisal Number: 22-03-02 Permit Number: Expiration Date: 03/01/2025 Page: 2 of 3
--	---	---

Access

Snowmobile trail regulations in Itasca County Forest Management Guideline & Specifications apply. A minimum of two inches of compacted snow must remain on the trail as a running surface.
 Gates must remain locked during hunting season.
 State land may be crossed to access timber sale. Logger must obtain permission from land manager.
 0 - .6 miles to County Road 52 or 310.
 Easement road must be used to access the timber sale. Access road must be kept in good condition, as determined by administering forester, at all times.

Landings and Access Roads

Reserve all non-merchantable timber within 15ft of county roads.
 Landings must be kept back at least 100' from Co. Rd 52 and 310.

Cutting, Felling, and Skidding

Do not damage reserve trees.
 Do not disturb survey markers, including witness trees.
 Sale boundaries are painted in blue or are natural boundaries.

Site, Soil, and Water Protection

Filter strips require <5% soil disturbance within 60' of all wetlands.
 Reserve all non-merchantable timber within 15ft of all wetlands.

Slash Disposal

Slash must be evenly distributed throughout permit area.
 A 10 ft. wide slash free zone must be maintained along roads and trails.
 Slash height must not exceed 3 ft. within view of Co. Rd. 52 and 310.

Regeneration Plan

Natural Regeneration

Itasca County Timber Appraisal Report

Appraised By: Nick Schreiber	Sale Type: REGULAR AUCTION SALE	Appraisal Number: 22-03-02
Appraisal Date: 01/19/2022	Auction Date: 06/08/2022	Permit Number:
		Expiration Date: 03/01/2025
		Page: 3 of 3

Site Map:

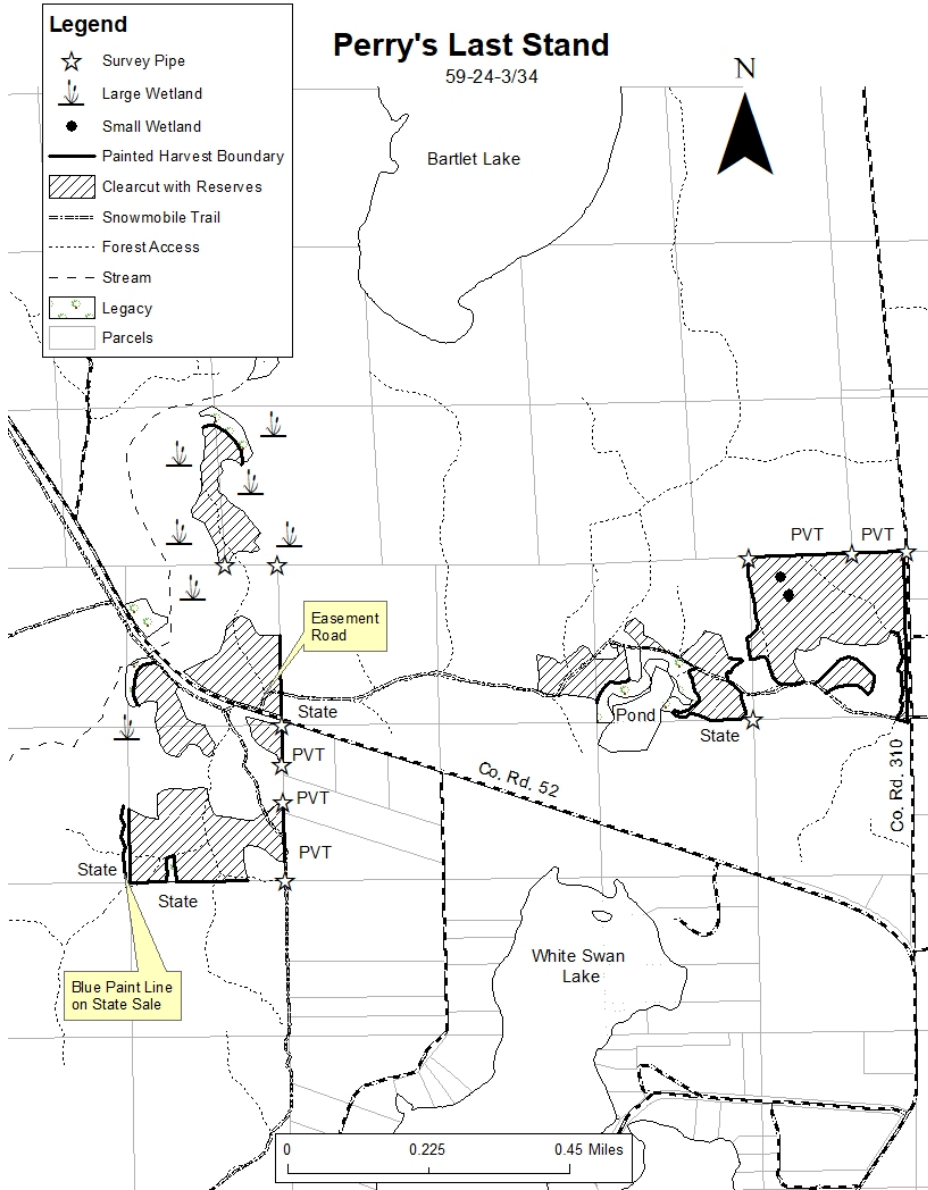

Appraisal examined and approved by _____ Forester _____ Date

Appraisal examined and approved by _____ Land Department _____ Date