

Itasca County Timber Appraisal Report

Appraised By:
Nick Schreiber
Appraisal Date:
02/03/2022

Sale Type:
INTERMEDIATE AUCTION
Auction Date:
06/08/2022

Appraisal Number: 22-03-03
Permit Number:
Expiration Date: 03/01/2025
Page: 1 of 3

Legal Description

<u>RE Code</u>	<u>Sec.</u>	<u>Twp.</u>	<u>Rge.</u>	<u>City/Twp</u>	<u>Subd</u>			
55-009-1300	9	59	24	Unorganized	SW NE			
55-009-1400	9	59	24	Unorganized	SE NE			
<u>Block 1 Species</u>	<u>Volume</u>	<u>Units</u>	<u>Unit Price</u>	<u>Value</u>	<u>Comments</u>	<u>Bolt %</u>	<u>Bid</u>	
Aspen	329	Cords	\$28.00	\$9,212.00	6-10" DBH, 4-6 sticks, good quality	30	^	
Paper Birch	26	Cords	\$11.00	\$286.00	6-10" DBH, 3-5 sticks, good quality	10	#	
Balsam Fir	22	Cords	\$10.00	\$220.00	6-9" DBH, 3-5 sticks, good quality	40	#	
Tamarack	4	Cords	\$5.00	\$20.00	7-12" DBH, 3-6 sticks, good quality	40	#	
Ash	3	Cords	\$14.00	\$42.00	6-9" DBH, 2-4 sticks, good quality	30	#	
				\$9,780.00	Subtotal			
Total Cords =	384		Total MBF: 0	\$9,780.00	Total			

Bid Symbols: ^ = Bid Species; # = Non-Bid Species; + = Sold Area Estimate; * = Sold Area Estimate & Non-Bid Species
All species woodsrun unless listed otherwise.

Species Scaled: Ash , Aspen, Balsam Fir, Paper Birch , Tamarack

Species SAE:

Operability: Dry Summer: 7/1 - 3/1
Topography: Level to rolling
Soil Type: Nashwauk-Menahga Complex
Cutting Acres: 11.0

All permits must follow Itasca County Forest Management Guidelines and Specifications (can be found at <http://www.co.itasca.mn.us/DocumentCenter/View/567/Forest-Management-Guidelines-and-Specifications>).

Harvest Specifications

Comments
Harvest Type: aspen clearcut with reserves.

Harvest and Reserves
Aspen clear-cut, cut all stems >2", reserve all non-hazardous snags, den trees, red pine, and oak.

Access
State land must be crossed to access timber sale. Logger must obtain permits/permission from state. 0.2 miles to County Road 345. Snowmobile trail regulations in Itasca County Forest Management Guideline & Specifications apply. A minimum of two inches of compacted snow must remain on the trail as a running surface.

Landings and Access Roads
Location and construction of any new roads/landings must be pre-approved by the sale administrator. Timber sale administrator shall be notified at least 3 working days prior to completion of hauling and road work. This provides adequate time for permit area inspection and addressing of permit compliance requirements before hauling and road work equipment is removed. Trails and landings need to be rehabilitated to a satisfactory condition, determined by administering forester, before performance bond is returned. Landings must be kept back at least 100' from County Road 345 and must not be in powerline row.

Itasca County Timber Appraisal Report

Appraised By: Nick Schreiber Appraisal Date: 02/03/2022	Sale Type: INTERMEDIATE AUCTION Auction Date: 06/08/2022	Appraisal Number: 22-03-03 Permit Number: Expiration Date: 03/01/2025 Page: 2 of 3
--	---	---

Cutting, Felling, and Skidding

Harvest boundaries are painted with 3 orange dashes. Property boundaries are painted with 3 orange circles or 1 orange dash with/without ribbon. Natural boundaries also exist on the sale.

Cut stems greater than 2" at DBH. Cut fir greater than 2 sticks. Cut tamarack along sale edge within reach of machinery from dry ground.

Site, Soil, and Water Protection

Filter strips require <5% soil disturbance within 50' of all wetlands.

Slash Disposal

A 10 ft. wide slash free zone must be maintained along roads and trails.

Slash must be evenly distributed throughout permit area.

Regeneration Plan

Natural regeneration to aspen.

Itasca County Timber Appraisal Report

Appraised By: Nick Schreiber	Sale Type: INTERMEDIATE AUCTION	Appraisal Number: 22-03-03
Appraisal Date: 02/03/2022	Auction Date: 06/08/2022	Permit Number:
		Expiration Date: 03/01/2025
		Page: 3 of 3

Site Map:

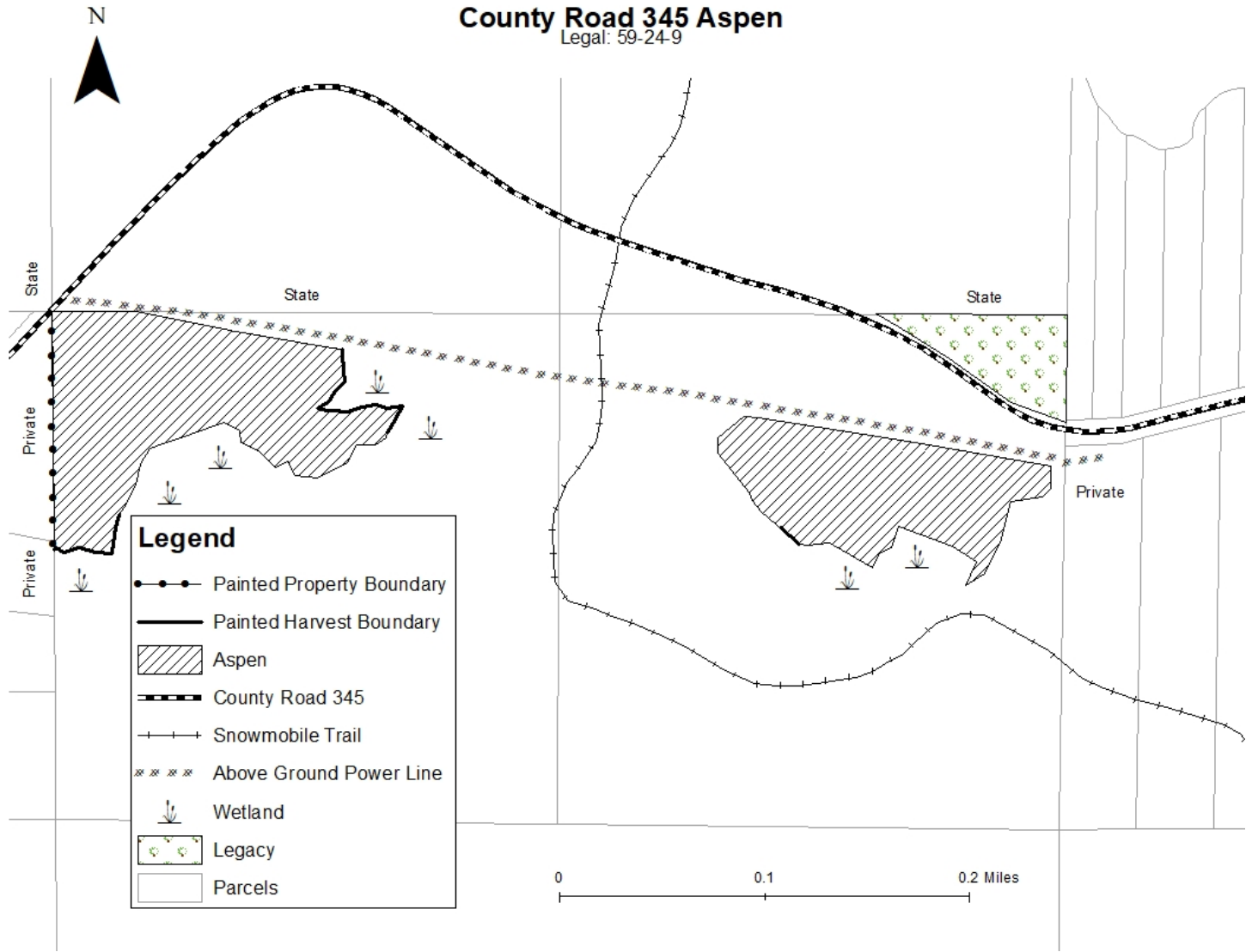

Appraisal examined and approved by _____
Forester Date

Appraisal examined and approved by _____
Land Department Date