

Itasca County Timber Appraisal Report

Appraised By:

Nick Schreiber

Appraisal Date:

03/16/2022

Sale Type:

REGULAR AUCTION SALE

Auction Date:

06/08/2022

Appraisal Number: 22-03-05**Permit Number:****Expiration Date:** 03/01/2025**Page:** 1 of 3**Legal Description**

<u>RE Code</u>	<u>Sec.</u>	<u>Twp.</u>	<u>Rge.</u>	<u>City/Twp</u>	<u>Subd</u>
52-027-1000	27	59	23	Unorganized	NE 1/4
52-027-2300	27	59	23	Unorganized	LOT 1 LESS PLAT OF WOLF LAKE
52-026-2300	26	59	23	Unorganized	SW NW
52-450-5000	27	59	23	Unorganized	OUTLOT B
52-027-2200	27	59	23	Unorganized	NW NW LESS PLAT OF WOLF LAKE

<u>Block 1 Species</u>	<u>Volume</u>	<u>Units</u>	<u>Unit Price</u>	<u>Value</u>	<u>Comments</u>	<u>Bolt %</u>	<u>Bid</u>
Red Pine	256	Cords	\$13.00	\$3,328.00	7-13" DBH, 3-7 sticks, good quality	40	^
Jack Pine	7	Cords	\$10.00	\$70.00	5-8" DBH, 2-3 sticks, good quality	15	#
Aspen	2	Cords	\$18.00	\$36.00	5-8" DBH, 2-4 sticks, good quality	0	#
				\$3,434.00	Subtotal		
Total Cords =	265		Total MBF: 0	\$3,434.00	Total		

Bid Symbols: ^ = Bid Species; # = Non-Bid Species; + = Sold Area Estimate; * = Sold Area Estimate & Non-Bid Species
All species woodsrun unless listed otherwise.

Species Scaled: Aspen, Jack Pine, Red Pine

Species SAE:

Operability: Dry Summer/Winter: 8/1 - 2/15

Soil Type: Menahga & Graycalm soils

Topography: Level

Cutting Acres: 12.7

All permits must follow Itasca County Forest Management Guidelines and Specifications (can be found at <http://www.co.itasca.mn.us/DocumentCenter/View/567/Forest-Management-Guidelines-and-Specifications>).

Harvest Specifications

<u>Comments</u>
Harvest Type: first time red pine thin (9 acres); second time red pine thin (3 acres). Waiting to hear from US Fish & Wildlife concerning abandoned nest (3 acre block).

Harvest and Reserves

Reserve all maple, oak, white pine, non-hazardous snags, den trees, and reserve trees painted with an orange "R". An eagle nest is in the second time thin - nesting tree and surround trees are painted with an orange "R".

Access

Private/Easement road must be used to access the timber sale. Access road must be kept in good condition, as determined by administering forester, at all times.

Eastern stand is 0.25 miles to Wolf Lake Trail. Western stand is adjacent to East Wolf Lake Trail.

Landings and Access Roads

Location and construction of any new roads/landings must be pre-approved by the sale administrator.

Trails and landings need to be rehabilitated to a satisfactory condition, determined by administering forester, before performance bond is returned.

Timber sale administrator shall be notified at least 3 working days prior to completion of hauling and road work. This provides adequate time for permit area inspection and addressing of permit compliance requirements before hauling and road work equipment is removed.

Itasca County Timber Appraisal Report

Appraised By: Nick Schreiber	Sale Type: REGULAR AUCTION SALE	Appraisal Number: 22-03-05
Appraisal Date: 03/16/2022	Auction Date: 06/08/2022	Permit Number:
		Expiration Date: 03/01/2025
		Page: 2 of 3

Cutting, Felling, and Skidding

Do not fell timber into wetlands or across sale boundaries.

Do not disturb survey marker, including 3 witness trees.

Property boundaries painted with 3 orange circles or an orange dash; rest are natural boundaries.

First time thin, clearcut 12 ft. access strips reserving 40 ft. in between strips for thinning. Between clearcut strips, thin to a 90 basal area. First, cut overtopping fir, aspen and jack pine within 10 feet of any red pine. Second, cut smaller diameter and/or poor quality red pine. Second time thin, remove smaller diameter and/or poor quality red pine. Thin to a 100 BA.

Do not damage reserve trees.

Site, Soil, and Water Protection

Filter strips require <5% soil disturbance within 50' of all wetlands.

Slash Disposal

A 10 ft. wide slash free zone must be maintained along roads and trails.

Slash must be evenly distributed throughout permit area.

Special Conditions

Logging season may be restricted to August through February during high bark beetle risk. All cut pine must be hauled within 3 weeks during June through August.

Regeneration Plan

NA

Itasca County Timber Appraisal Report

Appraised By:

Nick Schreiber

Appraisal Date:

03/16/2022

Sale Type:

REGULAR AUCTION SALE

Auction Date:

06/08/2022

Appraisal Number: 22-03-05

Permit Number:

Expiration Date: 03/01/2025

Page: 3 of 3

Site Map:

Wolf Lake Red Pine

Legal: 59-23-26/27

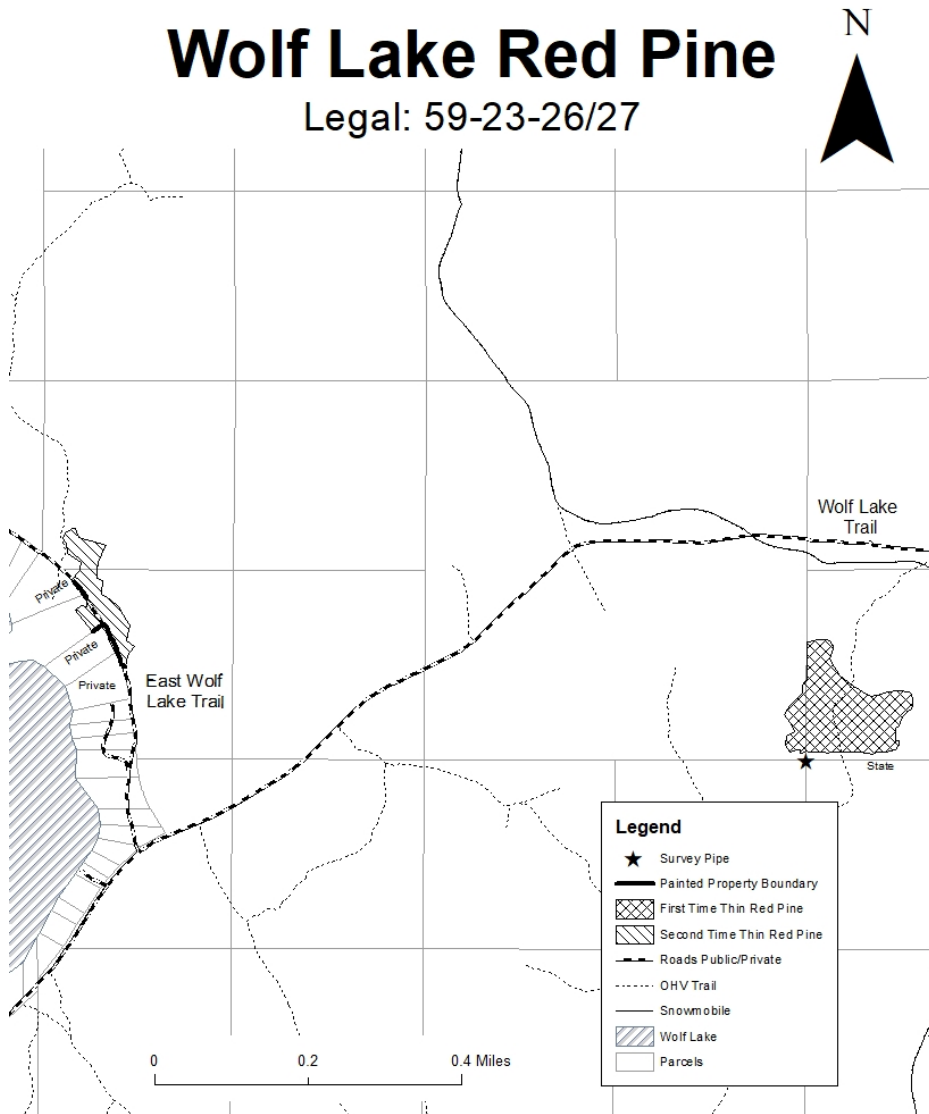

Appraisal examined and approved by

Forester

Date

Appraisal examined and approved by

Land Department

Date