

Itasca County Timber Appraisal Report

Appraised By:

Nick Schreiber

Appraisal Date:

03/24/2022

Sale Type:

REGULAR AUCTION SALE

Auction Date:

06/08/2022

Appraisal Number: 22-03-07**Permit Number:****Expiration Date:** 03/01/2023**Page:** 1 of 3**Legal Description**

<u>RE Code</u>	<u>Sec.</u>	<u>Twp.</u>	<u>Rge.</u>	<u>City/Twp</u>	<u>Subd</u>			
04-112-2100	12	58	24	Balsam	LOT 2			
04-101-4000	1	58	24	Balsam	SE 1/4			
04-101-3400	1	58	24	Balsam	LOT 6			
04-112-1000	12	58	24	Balsam	NE 1/4			
<u>Block 1 Species</u>	<u>Volume</u>	<u>Units</u>	<u>Unit Price</u>	<u>Value</u>	<u>Comments</u>	<u>Bolt %</u>	<u>Bid</u>	
Aspen	528	Cords	\$19.00	\$10,032.00	24% blowdown, 7-9" DBH, 4-6 sticks, fair quality	15	^	
Balsam Fir	20	Cords	\$9.00	\$180.00	6-9" DBH, 2-4 sticks, good quality	35	#	
Ash	2	Cords	\$11.00	\$22.00	7-12" DBH, 3-5 sticks, good quality	30	#	
Balm	1	Cords	\$17.00	\$17.00	6-9" DBH, 3-5 sticks, good quality	0	#	
Paper Birch	2	Cords	\$9.00	\$18.00	6-10" DBH, 2-4 sticks, good quality	20	#	
				\$10,269.00	Subtotal			
Total Cords =	553		Total MBF: 0	\$10,269.00	Total			

Bid Symbols: ^ = Bid Species; # = Non-Bid Species; + = Sold Area Estimate; * = Sold Area Estimate & Non-Bid Species
 All species woodsrun unless listed otherwise.

Species Scaled: Ash , Aspen, Balm , Balsam Fir, Paper Birch

Species SAE:

Operability: Dry Summer: 7/15 - 3/1

Soil Type: Nashwauk fine sandy loam

Topography: Level to rolling

Cutting Acres: 16.0

All permits must follow Itasca County Forest Management Guidelines and Specifications (can be found at <http://www.co.itasca.mn.us/DocumentCenter/View/567/Forest-Management-Guidelines-and-Specifications>).

Harvest Specifications

Comments
Harvest Type: aspen clearcut with reserves, 25% blowdown reduction reflected in price (no additional price reduction will be applied), 1 year sale.

Harvest and Reserves
Cut stems greater than 2" at DBH. Cut fir greater than 2 sticks. Reserve all spruce, pine, and oak.

Access
0.7 miles to County Road 336. Balsam ATV Trail will be used for access. Trail be rerouted for ATV users. ATV riders will be rerouted. Truck hauling and detour signs will be placed along the ATV route.

Landings and Access Roads
Location and construction of any new roads/landings must be pre-approved by the sale administrator. Trails and landings need to be rehabilitated to a satisfactory condition, determined by administering forester, before performance bond is returned. Timber sale administrator shall be notified at least 3 working days prior to completion of hauling and road work. This provides adequate time for permit area inspection and addressing of permit compliance requirements before hauling and road work equipment is removed.

Itasca County Timber Appraisal Report**Appraised By:**

Nick Schreiber

Appraisal Date:

03/24/2022

Sale Type:

REGULAR AUCTION SALE

Auction Date:

06/08/2022

Appraisal Number: 22-03-07**Permit Number:****Expiration Date:** 03/01/2023**Page:** 2 of 3**Cutting, Felling, and Skidding**

Do not fell timber into wetlands or across sale boundaries.

Do not disturb survey marker, including witness tree.

Harvest boundaries are painted with orange dashes; rest of boundaries are natural.

Site, Soil, and Water Protection

Filter strips require <5% soil disturbance within 50' of all wetlands.

Slash Disposal

Slash must be evenly distributed throughout permit area.

A 10 ft. wide slash free zone must be maintained along roads and trails.

Regeneration Plan

Natural regeneration to aspen.

Itasca County Timber Appraisal Report

Appraised By:

Nick Schreiber

Appraisal Date:

03/24/2022

Sale Type:

REGULAR AUCTION SALE

Auction Date:

06/08/2022

Appraisal Number: 22-03-07

Permit Number:

Expiration Date: 03/01/2023

Page: 3 of 3

Site Map:

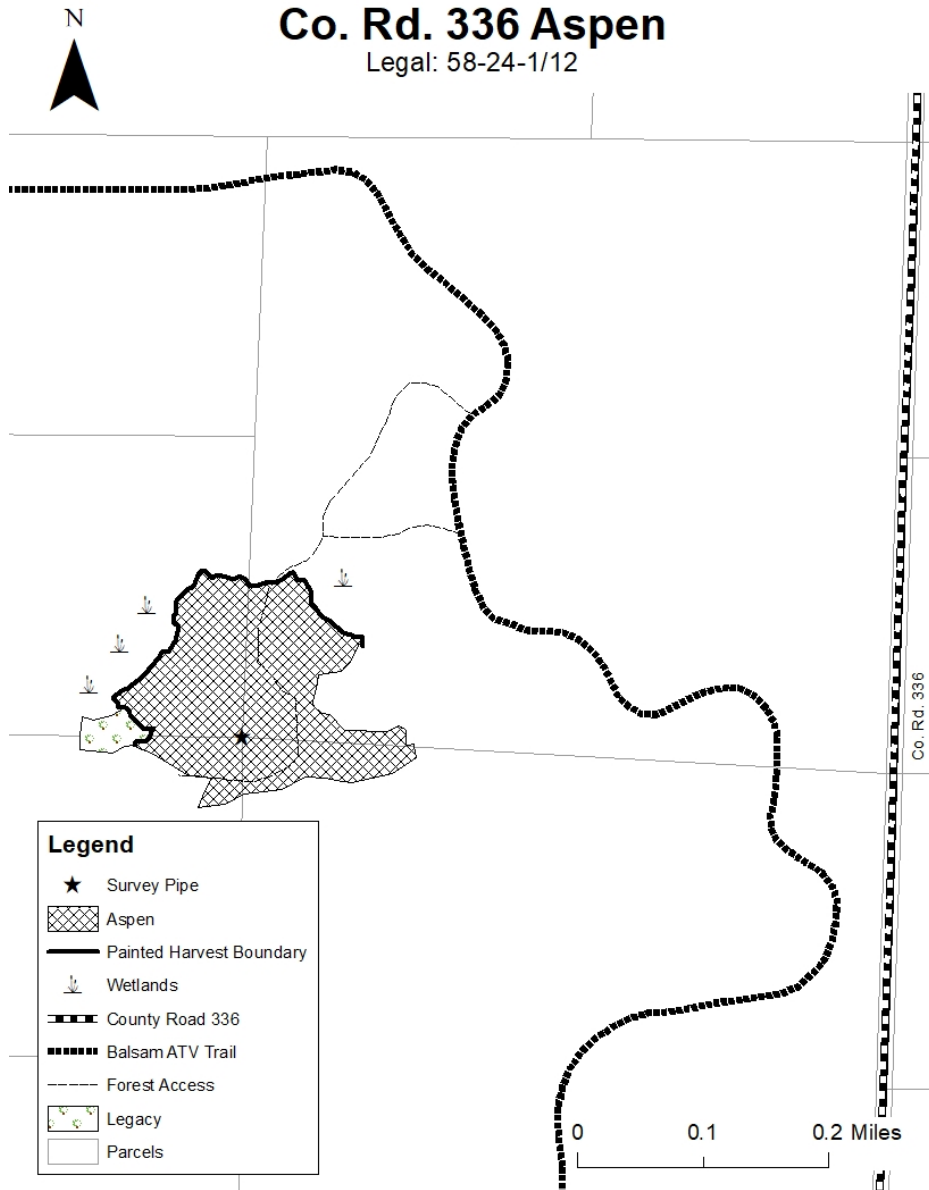

Appraisal examined and approved by

Forester

Date

Appraisal examined and approved by

Land Department

Date