

Itasca County Timber Appraisal Report

Appraised By: Nick Schreiber Appraisal Date: 03/24/2022	Sale Type: INTERMEDIATE AUCTION Auction Date: 06/08/2022	Appraisal Number: 22-03-08 Permit Number: Expiration Date: 03/01/2025 Page: 1 of 3
--	---	---

Legal Description

RE Code	Sec.	Twp.	Rge.	City/Twp	Subd
60-031-2300	31	60	25	Unorganized	LOT 2
60-031-3300	31	60	25	Unorganized	LOT 4

Block 1 Species	Volume	Units	Unit Price	Value	Comments	Bolt %	Bid
Red Pine	349	Cords	\$24.00	\$8,376.00	8-10" DBH, 4-6 sticks, good quality	60	^
Aspen	9	Cords	\$23.00	\$207.00	6-9" DBH, 3-5 sticks, good quality	30	#
Paper Birch	7	Cords	\$10.00	\$70.00	7-9" DBH, 3-5 sticks, good quality	30	#
				\$8,653.00	Subtotal		
Total Cords =	365		Total MBF: 0	\$8,653.00	Total		

Bid Symbols: ^ = Bid Species; # = Non-Bid Species; + = Sold Area Estimate; * = Sold Area Estimate & Non-Bid Species
 All species woodsrun unless listed otherwise.

Species Scaled: Aspen, Paper Birch, Red Pine

Species SAE:

Operability: Dry Summer: 7/1 - 3/1	Soil Type: Warba-Menahga Complex
Topography: Level to rolling	Cutting Acres: 23.8

All permits must follow Itasca County Forest Management Guidelines and Specifications (can be found at <http://www.co.itasca.mn.us/DocumentCenter/View/567/Forest-Management-Guidelines-and-Specifications>).

Harvest Specifications

Comments
Harvest Type: 2nd time red pine thin operator select.

Harvest and Reserves
Target removal of overtopping aspen and birch as well as suppressed, forked, or poor quality red pine. Thin to a 90 BA.

Access
1.25 miles from East Burns Lake Road to southern block and 1.5 miles to northern block. Federal and state land must be crossed to access timber sale. Logger must obtain permits/permission from land managers.

Landings and Access Roads
Location and construction of any new roads/landings must be pre-approved by the sale administrator. Trails and landings need to be rehabilitated to a satisfactory condition, determined by administering forester, before performance bond is returned. Timber sale administrator shall be notified at least 3 working days prior to completion of hauling and road work. This provides adequate time for permit area inspection and addressing of permit compliance requirements before hauling and road work equipment is removed.

Cutting, Felling, and Skidding
Do not fell timber into wetlands or across sale boundaries. Do not disturb survey markers, including 3 witness trees. Painted property boundaries have 3 orange circles. Painted harvest boundaries have 3 orange dashes; rest of boundaries are natural. Do not damage non-hazardous snags or den trees. Do not damage reserve trees.

Itasca County Timber Appraisal Report

Appraised By: Nick Schreiber	Sale Type: INTERMEDIATE AUCTION	Appraisal Number: 22-03-08
Appraisal Date: 03/24/2022	Auction Date: 06/08/2022	Permit Number:
		Expiration Date: 03/01/2025
		Page: 2 of 3

Site, Soil, and Water Protection

Filter strips require <5% soil disturbance within 50' of all wetlands.

Slash Disposal

A 10 ft. wide slash free zone must be maintained along roads and trails.
Slash must be evenly distributed throughout permit area.

Special Conditions

Logging season may be restricted to August through February during high bark beetle risk. All cut pine must be hauled within 3 weeks during June through August.

Itasca County Timber Appraisal Report

Appraised By: Nick Schreiber	Sale Type: INTERMEDIATE AUCTION	Appraisal Number: 22-03-08
Appraisal Date: 03/24/2022	Auction Date: 06/08/2022	Permit Number:
		Expiration Date: 03/01/2025
		Page: 3 of 3

Site Map:

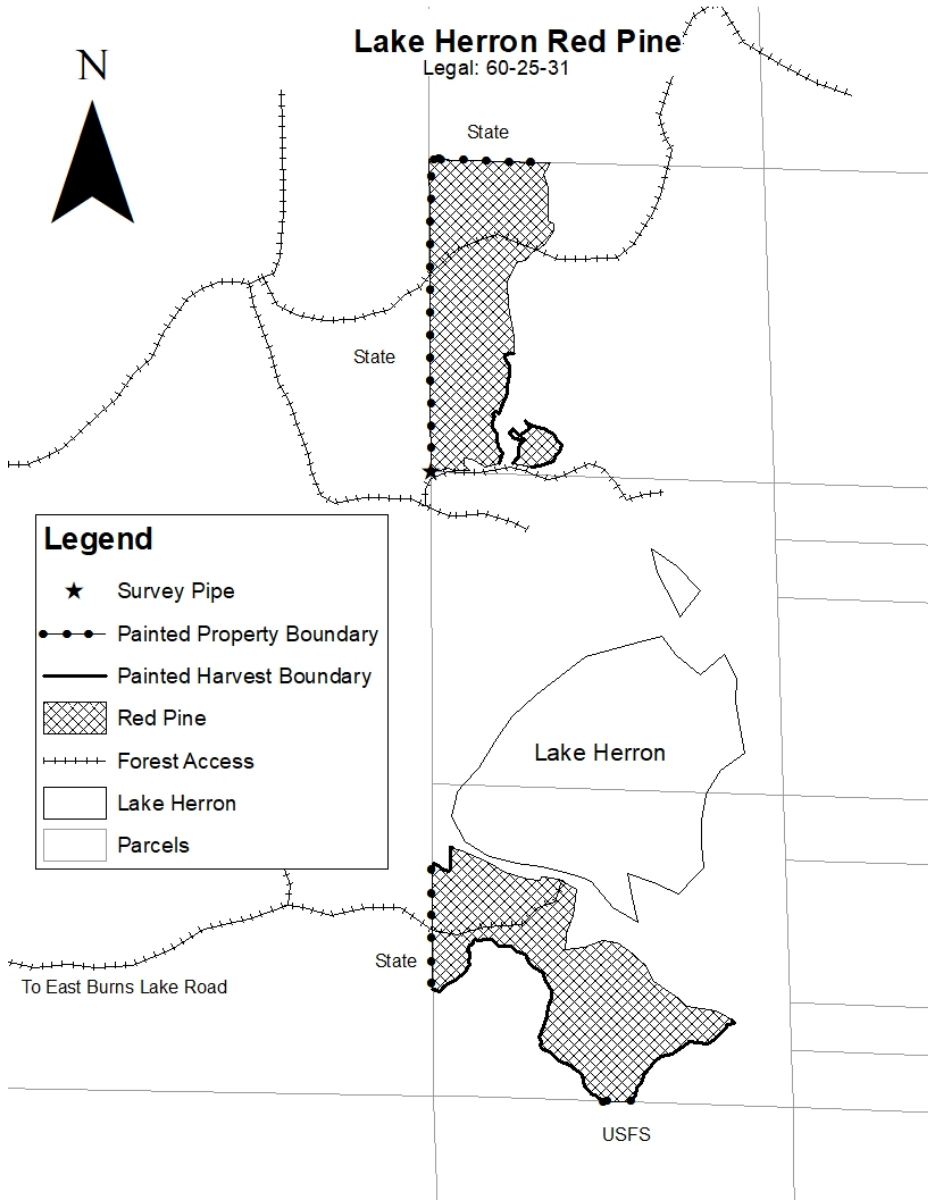

Appraisal examined and approved by _____
Forester
Date

Appraisal examined and approved by _____
Land Department
Date