

Itasca County Timber Appraisal Report

Appraised By: Nick Schreiber Appraisal Date: 04/05/2022	Sale Type: INTERMEDIATE AUCTION Auction Date: 12/08/2022	Appraisal Number: 22-03-11 Permit Number: Expiration Date: 03/01/2025 Page: 1 of 3
--	---	---

Legal Description

RE Code	Sec.	Twp.	Rge.	City/Twp	Subd		
04-131-1100	31	58	24	Balsam	NE NE		
04-131-1400	31	58	24	Balsam	SE NE		
Block 1 Species	Volume	Units	Unit Price	Value	Comments	Bolt %	Bid
Spruce	270	Cords	\$9.00	\$2,430.00	6-10" DBH, 2-4 sticks, good quality (less than 5% black spruce)	20	^
Balm	11	Cords	\$15.00	\$165.00	7-9" DBH, 3-4 sticks, good quality	0	#
Balsam Fir	9	Cords	\$5.00	\$45.00	6-10" DBH, 2-4 sticks, good quality	15	#
Aspen	3	Cords	\$15.00	\$45.00	7-9" DBH, 3-4 sticks, good quality	0	#
				\$2,685.00	Subtotal		
Total Cords =	293	Total MBF: 0		\$2,685.00	Total		

Bid Symbols: ^ = Bid Species; # = Non-Bid Species; + = Sold Area Estimate; * = Sold Area Estimate & Non-Bid Species
 All species woodsrun unless listed otherwise.

Species Scaled: Aspen, Balm, Balsam Fir, Spruce

Species SAE:

Operability: Frozen Ground: 12/1 - 3/1	Soil Type: Nashwauk fine sandy loam
Topography: Level	Cutting Acres: 22.7

All permits must follow Itasca County Forest Management Guidelines and Specifications (can be found at <http://www.co.itasca.mn.us/DocumentCenter/View/567/Forest-Management-Guidelines-and-Specifications>).

Harvest Specifications

Comments
Harvest Type: 1st time white spruce thin operator select (23 acres).

Access
Easement road must be used to access the timber sale. Access road must be kept in good condition, as determined by administering forester, at all times. 200 feet to County Road 332.

Landings and Access Roads
Location and construction of any new roads/landings must be pre-approved by the sale administrator. Trails and landings need to be rehabilitated to a satisfactory condition, determined by administering forester, before performance bond is returned. Timber sale administrator shall be notified at least 3 working days prior to completion of hauling and road work. This provides adequate time for permit area inspection and addressing of permit compliance requirements before hauling and road work equipment is removed.

Cutting, Felling, and Skidding
Do not damage reserve trees. Do not fell timber into wetlands or across sale boundaries. Sale boundaries are natural. Cut 12 foot access strips reserving 40 feet in between strips for thinning. Thin stand down to an average of 90 basal area. Cut overtopping fir, aspen, and balm of Gilead within 10 feet of any spruce before cutting spruce. Favor the removal of smaller diameter, poor quality, and damaged trees. Utilize 2 stick and greater spruce. Cutting SW to NE access strips is preferred.

Itasca County Timber Appraisal Report

Appraised By: Nick Schreiber Appraisal Date: 04/05/2022	Sale Type: INTERMEDIATE AUCTION Auction Date: 12/08/2022	Appraisal Number: 22-03-11 Permit Number: Expiration Date: 03/01/2025 Page: 2 of 3
--	---	---

Site, Soil, and Water Protection

Filter strips require <5% soil disturbance within 50 feet of all wetlands.
 Reserve all non-merchantable timber within 15 feet of all wetlands.

Slash Disposal

A 10 foot wide slash free zone must be maintained along roads and trails.
 Slash must be evenly distributed throughout permit area.

Regeneration Plan

Due to nature of managed species and type of harvest little to no tree regeneration is expected to occur after harvest.

Itasca County Timber Appraisal Report

Appraised By: Nick Schreiber	Sale Type: INTERMEDIATE AUCTION	Appraisal Number: 22-03-11
Appraisal Date: 04/05/2022	Auction Date: 12/08/2022	Permit Number:
		Expiration Date: 03/01/2025
		Page: 3 of 3

Site Map:

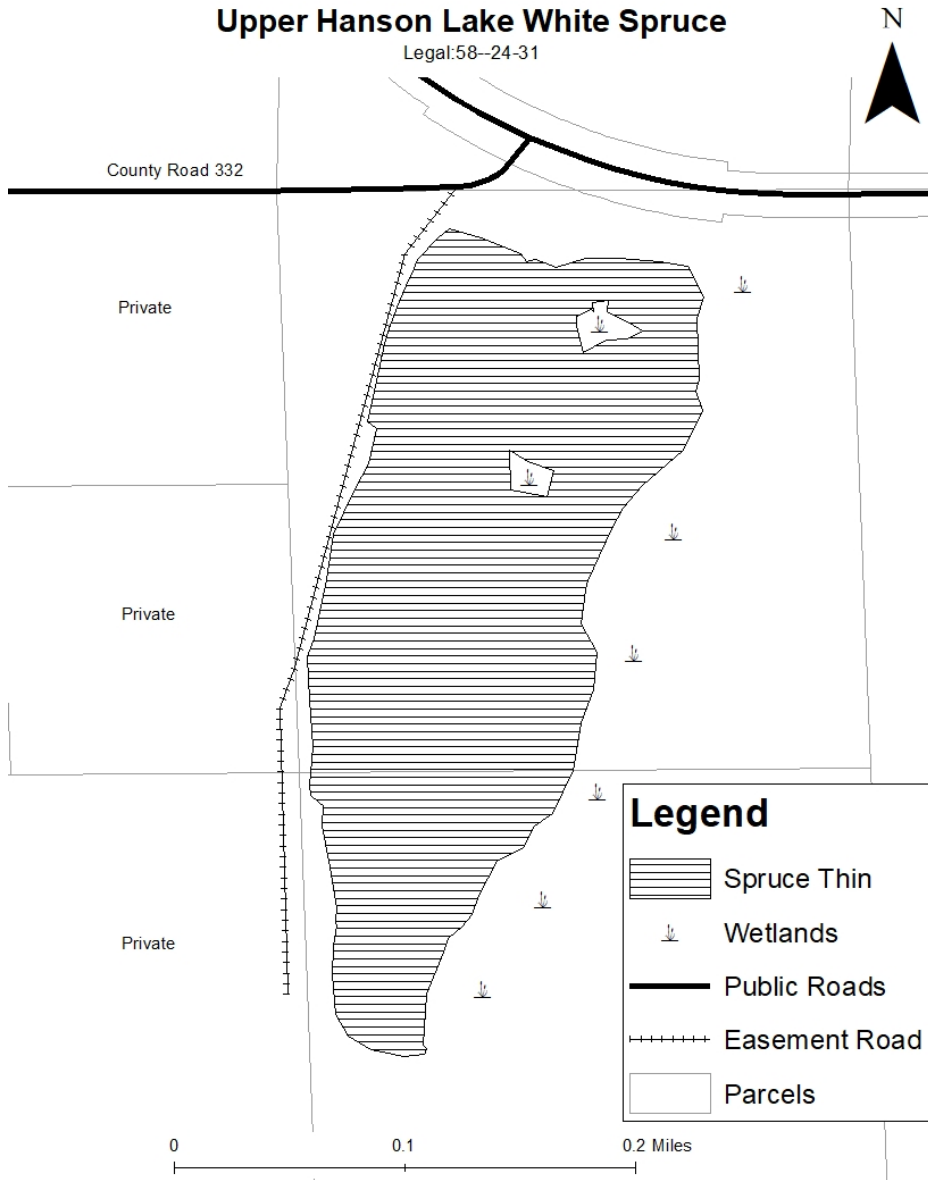

Appraisal examined and approved by _____
Forester Date

Appraisal examined and approved by _____
Land Department Date