

Itasca County Timber Appraisal Report

Appraised By: Nick Schreiber Appraisal Date: 08/25/2022	Sale Type: REGULAR AUCTION SALE Auction Date: 12/08/2022	Appraisal Number: 22-03-18 Permit Number: Expiration Date: 03/01/2026 Page: 1 of 3
--	---	---

Legal Description

<u>RE Code</u>	<u>Sec.</u>	<u>Twp.</u>	<u>Rge.</u>	<u>City/Twp</u>	<u>Subd</u>		
55-021-4000	21	59	24	Unorganized	SE 1/4		
<u>Block 1 Species</u>	<u>Volume</u>	<u>Units</u>	<u>Unit Price</u>	<u>Value</u>	<u>Comments</u>	<u>Bolt %</u>	<u>Bid</u>
Red Pine	288	Cords	\$26.00	\$7,488.00	7-14" DBH, 5-6 sticks, good condition	70	^
Spruce	143	Cords	\$12.00	\$1,716.00	7-12" DBH, 4-6 sticks, good condition	35	^
Maple	5	Cords	\$7.00	\$35.00	6-12" DBH, 3-5 sticks, fair condition	0	#
Paper Birch	12	Cords	\$8.00	\$96.00	6-10" DBH, 3-5 sticks, fair condition	10	#
Balsam Fir	12	Cords	\$11.00	\$132.00	6-11" DBH, 3-6 sticks, fair condition	15	#
Aspen	40	Cords	\$20.00	\$800.00	6-12" DBH, 4-6 sticks, good condition	10	#
				\$10,267.00	Subtotal		
Total Cords =	500			Total MBF: 0	Total		

Bid Symbols: ^ = Bid Species; # = Non-Bid Species; + = Sold Area Estimate; * = Sold Area Estimate & Non-Bid Species
 All species woodsrun unless listed otherwise.

Species Scaled: Aspen, Balsam Fir, Maple, Paper Birch, Red Pine, Spruce
Species SAE:

Operability: Dry Summer or frozen ground: 7-1 - 3-1 **Soil Type:** 620B Cutaway loamy sand, 1826D Nashwauk-Menahga complex
Topography: Level/rolling; some steep **Cutting Acres:** 47.0

All permits must follow Itasca County Forest Management Guidelines and Specifications (can be found at <http://www.co.itasca.mn.us/DocumentCenter/View/567/Forest-Management-Guidelines-and-Specifications>).

Harvest Specifications

Comments
Harvest Type: 2nd time white spruce thin (17 acres) and 3rd time red pine(30 acres) thin; both operator select.

Harvest and Reserves
Reserve all white pine and oaks.

Access
Access across tax-forfeited land. Road and ATV trail must be kept in good condition, as determined by administering forester, at all times. "Caution Logging Ahead" signs will be placed along ATV trail to alert users. 0.10 miles to Scenic Highway 7.

Landings and Access Roads
Trails and landings need to be rehabilitated to a satisfactory condition, determined by administering forester, before performance bond is returned. Landings must be kept back at least 100 feet from Scenic Highway 7.

Itasca County Timber Appraisal Report

Appraised By: Nick Schreiber Appraisal Date: 08/25/2022	Sale Type: REGULAR AUCTION SALE Auction Date: 12/08/2022	Appraisal Number: 22-03-18 Permit Number: Expiration Date: 03/01/2026 Page: 2 of 3
--	---	---

Cutting, Felling, and Skidding

Timber must be processed at the stump.
 Do not damage reserve crop trees.
 Do not fell timber into wetlands or across sale boundaries.
 Thin white spruce stand down to an average of 90 basal area. Thin red pine stands down to an average of 110 basal area. Favor the removal of smaller diameter, poor quality, and damaged trees. Cut overtopping aspen, balsam, and paper birch within 10 feet of any spruce/red pine crop tree.
 Do not disturb survey marker in SE corner of sale, including witness trees.
 Sale boundaries painted in blue/pink ribbon and natural boundaries.
 Slash may be needed on the steep hills where forwarding/skidding to prevent soil erosion.

Site, Soil, and Water Protection

Filter strips require <5% soil disturbance within 50 feet of all wetlands.

Slash Disposal

Slash must be evenly distributed throughout permit area.
 Slash height must not exceed 3 feet within view of road. 10 foot wide slash free zone along all roads and trails.

Special Conditions

Logging season may be restricted to August through February during high bark beetle risk. All cut pine must be hauled within 3 weeks during June through August.
 Utilize all trees with at least 2 sticks up to a 3" top.

Regeneration Plan

Due to nature of managed species and type of harvest little to no tree regeneration is expected to occur after harvest.

Itasca County Timber Appraisal Report

Appraised By: Nick Schreiber	Sale Type: REGULAR AUCTION SALE	Appraisal Number: 22-03-18
Appraisal Date: 08/25/2022	Auction Date: 12/08/2022	Permit Number:
		Expiration Date: 03/01/2026
		Page: 3 of 3

Site Map:

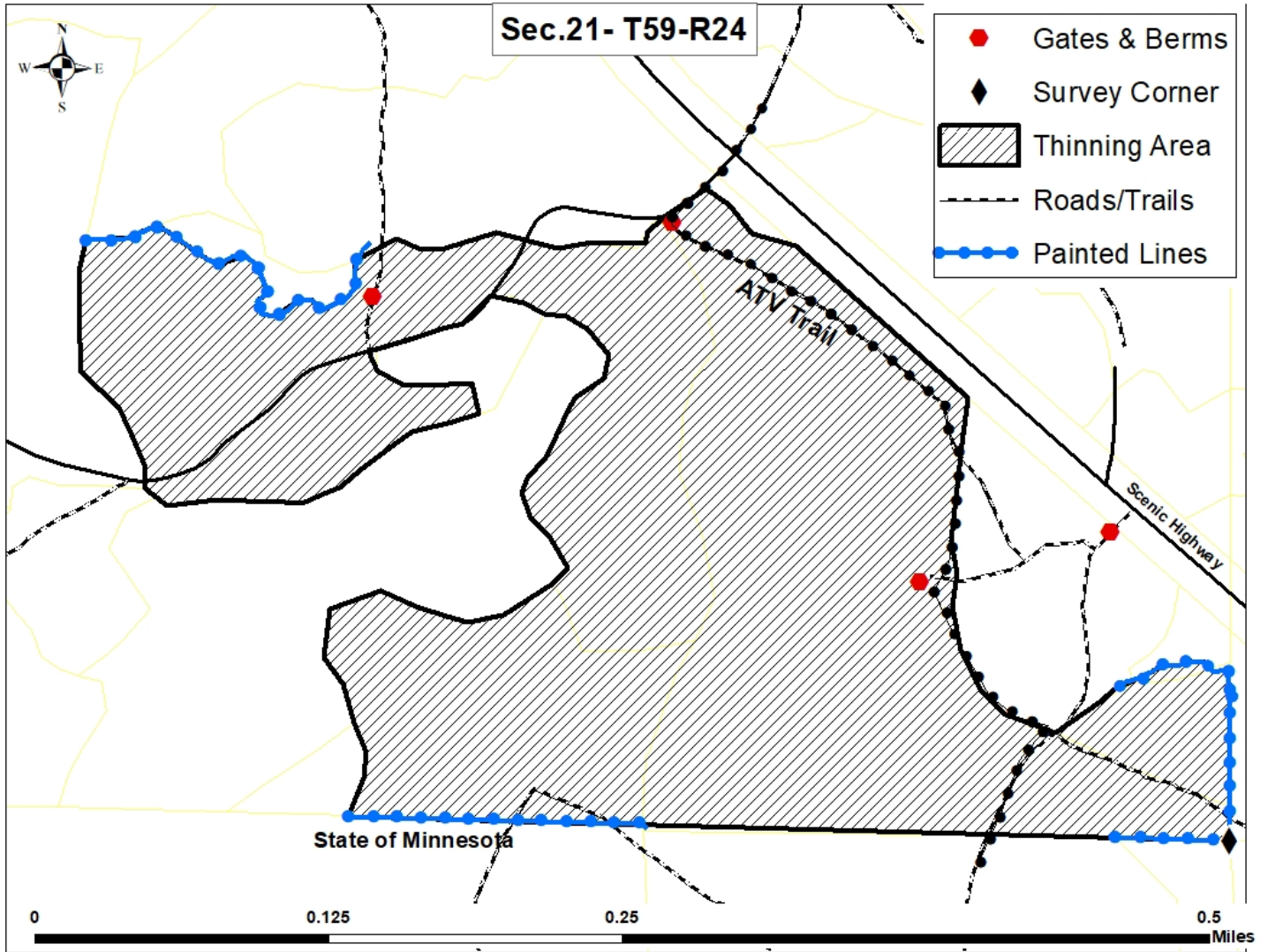

Appraisal examined and approved by _____
Forester Date

Appraisal examined and approved by _____
Land Department Date