

Itasca County Timber Appraisal Report

Appraised By: Loren Eide Appraisal Date: 04/07/2022	Sale Type: INTERMEDIATE AUCTION Auction Date: 06/08/2022	Appraisal Number: 22-04-02 Permit Number: Expiration Date: 03/01/2025 Page: 1 of 3
--	---	---

Legal Description

<u>RE Code</u>	<u>Sec.</u>	<u>Twp.</u>	<u>Rge.</u>	<u>City/Twp</u>	<u>Subd</u>		
48-033-1300	33	58	22	Unorganized	SW NE		
48-033-1400	33	58	22	Unorganized	SE NE		
<u>Block 1 Species</u>	<u>Volume</u>	<u>Units</u>	<u>Unit Price</u>	<u>Value</u>	<u>Comments</u>	<u>Bolt %</u>	<u>Bid</u>
Aspen	350	Cords	\$23.00	\$8,050.00		35	^
Spruce	10	Cords	\$23.00	\$230.00	White Spruce	90	#
Balsam Fir	5	Cords	\$8.00	\$40.00			#
Balm	2	Cords	\$17.00	\$34.00			#
Paper Birch	3	Cords	\$8.00	\$24.00			*
Maple	2	Cords	\$8.00	\$16.00			*
				\$8,394.00	Subtotal		
Total Cords =	372			Total MBF: 0	\$8,394.00	Total	

Bid Symbols: ^ = Bid Species; # = Non-Bid Species; + = Sold Area Estimate; * = Sold Area Estimate & Non-Bid Species
 All species woodstrun unless listed otherwise.

Species Scaled: Aspen, Balm , Balsam Fir, Spruce
Species SAE: Maple , Paper Birch

Operability: Frozen ground.: 12/15 - 3/1 **Soil Type:** 622B Nashwauk fine sandy loam.
Topography: Level **Cutting Acres:** 11.9

All permits must follow Itasca County Forest Management Guidelines and Specifications (can be found at <http://www.co.itasca.mn.us/DocumentCenter/View/567/Forest-Management-Guidelines-and-Specifications>).

Harvest Specifications

Comments
Harvest Type: Aspen Clearcut w/reserves.

Harvest and Reserves
A presale meeting with the sale administrator is required before any harvesting operations begin. Reserve all non-hazardous snags and cavity trees. Reserve all pine and ash. Reserve any unmerchantable balsam, birch or maple.

Access
Private industrial land must be crossed to access timber sale. Logger must obtain permission from land owner. .9 miles to Co Rd. #54

Landings and Access Roads
No new road development needed using existing road shown on map. Possible shorter route through private from the NE. landings must be pre-approved by the sale administrator. There is a rock berm on the approach to the private access trail shown on map that would need to be re- installed after sale is completed.

Cutting, Felling, and Skidding
Do not fell timber into wetlands or across sale boundaries. Most of sale boundaries painted with orange. There is a natural boundary along aspen regen on the north edge of the west part of sale.

Itasca County Timber Appraisal Report

Appraised By: Loren Eide Appraisal Date: 04/07/2022	Sale Type: INTERMEDIATE AUCTION Auction Date: 06/08/2022	Appraisal Number: 22-04-02 Permit Number: Expiration Date: 03/01/2025 Page: 2 of 3
--	---	---

Site, Soil, and Water Protection

Filter strips require <5% soil disturbance within 50' of all wetlands.

Slash Disposal

Slash must be evenly distributed throughout permit area.

Regeneration Plan

Natural regeneration to aspen.

Itasca County Timber Appraisal Report

Appraised By: Loren Eide	Sale Type: INTERMEDIATE AUCTION	Appraisal Number: 22-04-02
Appraisal Date: 04/07/2022	Auction Date: 06/08/2022	Permit Number:
		Expiration Date: 03/01/2025
		Page: 3 of 3

Site Map:

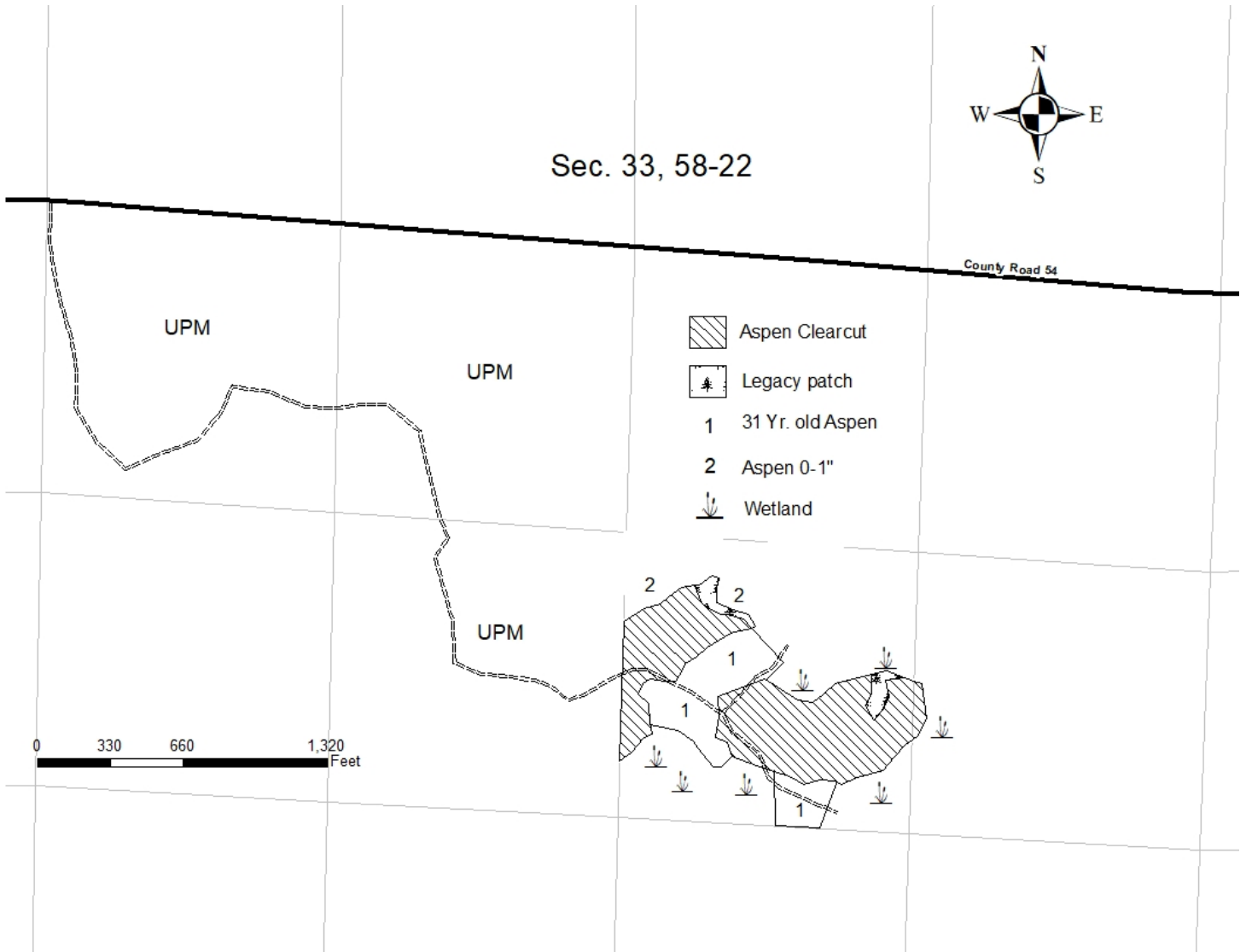

Appraisal examined and approved by _____
Forester Date

Appraisal examined and approved by _____
Land Department Date