

Itasca County Timber Appraisal Report

Appraised By: Loren Eide Appraisal Date: 04/14/2022	Sale Type: REGULAR AUCTION SALE Auction Date: 06/08/2022	Appraisal Number: 22-04-05 Permit Number: Expiration Date: 03/01/2025 Page: 1 of 3
--	---	---

Legal Description

<u>RE Code</u>	<u>Sec.</u>	<u>Twp.</u>	<u>Rge.</u>	<u>City/Twp</u>	<u>Subd</u>			
06-124-2100	24	60	22	Bearville	NE NW			
06-124-2400	24	60	22	Bearville	SE NW LYG N OF CO RD			
06-124-1303	24	60	22	Bearville	LOT 3 LESS PLATS			
06-124-2200	24	60	22	Bearville	NW NW			
<u>Block 1 Species</u>	<u>Volume</u>	<u>Units</u>	<u>Unit Price</u>	<u>Value</u>	<u>Comments</u>	<u>Bolt %</u>	<u>Bid</u>	
Red Pine	560	Cords	\$28.00	\$15,680.00	8" DBH,5 stick avg.	80	^	
Jack Pine	50	Cords	\$21.00	\$1,050.00		35	#	
Aspen	30	Cords	\$22.00	\$660.00			#	
Paper Birch	20	Cords	\$7.00	\$140.00			#	
				\$17,530.00	Subtotal			
Total Cords =	660		Total MBF: 0	\$17,530.00	Total			

Bid Symbols: ^ = Bid Species; # = Non-Bid Species; + = Sold Area Estimate; * = Sold Area Estimate & Non-Bid Species
 All species woodsrun unless listed otherwise.

Species Scaled: Aspen, Jack Pine, Paper Birch , Red Pine

Species SAE:

Operability: Summer: 7/1 - 10/1	Soil Type: Menahga Loamy sand
Topography: rolling to hilly	Cutting Acres: 50.2

All permits must follow Itasca County Forest Management Guidelines and Specifications (can be found at <http://www.co.itasca.mn.us/DocumentCenter/View/567/Forest-Management-Guidelines-and-Specifications>).

Harvest Specifications

Comments
Harvest Type: 2nd Entry Red Pine Thin (operator select).

Access
Sale is on the W. Sturgeon State Forest Road. The road must be kept in good condition through sale area at all times and must not be blocked by trucks or equipment.

Landings and Access Roads
Use existing landing areas cleared along the W. Sturgeon State Forest Road from 1st thinning. Any changes to landings or locations must be pre-approved by the sale administrator. Landing areas are limited, so waiting on hauling may not be an option. Any berms removed must be re- installed after sale is completed. Timber sale administrator shall be notified at least 3 working days prior to completion of hauling and road work. This provides adequate time for permit area inspection and addressing of permit compliance requirements before hauling and road work equipment is removed.

Cutting, Felling, and Skidding
Timber must be processed at the stump. Do not damage remaining crop trees. Do not fell timber into wetlands or across sale boundaries. Follow clearcut strips from 1st thinning. Thin stand down to an average of 90 basal area. Favor the removal of smaller diameter, poor quality, and damaged trees. Remove jack pine before red pine when equal in quality. Sale has natural and orange painted boundaries. Slash may be needed on some steeper areas where forwarding to prevent soil erosion.

Itasca County Timber Appraisal Report

Appraised By: Loren Eide Appraisal Date: 04/14/2022	Sale Type: REGULAR AUCTION SALE Auction Date: 06/08/2022	Appraisal Number: 22-04-05 Permit Number: Expiration Date: 03/01/2025 Page: 2 of 3
--	---	---

Site, Soil, and Water Protection
Filter strips require <5% soil disturbance within 50' of all wetlands. Increase width 2' for each slope percentage above 10%.

Slash Disposal
A 15 ft. wide slash free zone must be maintained along W. Sturgeon forest road. Slash height must not exceed 2 ft. within view of road.

Special Conditions
Logging season may be restricted to August through February during high bark beetle risk. All cut pine must be hauled within 3 weeks during June through August.

Regeneration Plan
N/A

Itasca County Timber Appraisal Report

Appraised By: Loren Eide	Sale Type: REGULAR AUCTION SALE	Appraisal Number: 22-04-05
Appraisal Date: 04/14/2022	Auction Date: 06/08/2022	Permit Number:
		Expiration Date: 03/01/2025
		Page: 3 of 3

Site Map:

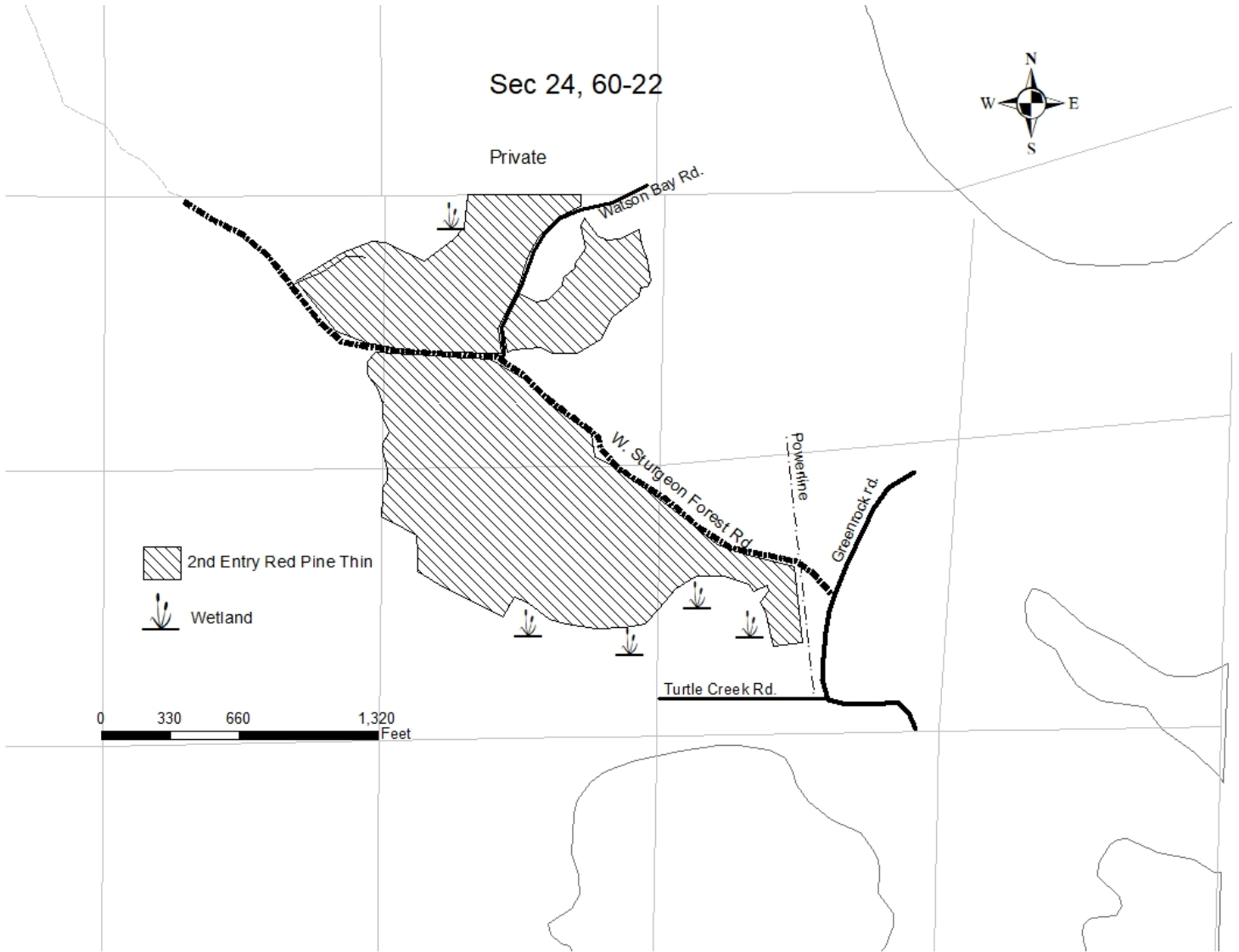

Appraisal examined and approved by _____
Forester Date

Appraisal examined and approved by _____
Land Department Date