

Itasca County Timber Appraisal Report

Appraised By: Loren Eide Appraisal Date: 10/13/2022	Sale Type: REGULAR AUCTION SALE Auction Date: 12/08/2022	Appraisal Number: 22-04-14 Permit Number: Expiration Date: 03/01/2025 Page: 1 of 3
--	---	---

Legal Description

RE Code	Sec.	Twp.	Rge.	City/Twp	Subd
06-114-3400	14	60	22	Bearville	SE SW
06-126-2000	26	60	22	Bearville	NW 1/4
06-123-0000	23	60	22	Bearville	ALL OF SEC 23
06-114-3300	14	60	22	Bearville	SW SW
06-124-2200	24	60	22	Bearville	NW NW

Block 1 Species	Volume	Units	Unit Price	Value	Comments	Bolt %	Bid
Aspen	650	Cords	\$24.00	\$15,600.00	Variable (5-16", 4-8 stick)	20	^
Red Pine	200	Cords	\$26.00	\$5,200.00	6-10", 5-8 Stick	75	^
Paper Birch	65	Cords	\$13.00	\$845.00	8-13"	30	#
Ash	60	Cords	\$13.00	\$780.00	9-14"	50	#
Balsam Fir	50	Cords	\$9.00	\$450.00			#
Maple	50	Cords	\$9.00	\$450.00			#
Spruce	25	Cords	\$21.00	\$525.00		35	#
Jack Pine	2	Cords	\$8.00	\$16.00		20	#

\$23,866.00 **Subtotal**

Total Cords = 1,102 **Total MBF: 0** \$23,866.00 **Total**

Bid Symbols: ^ = Bid Species; # = Non-Bid Species; + = Sold Area Estimate; * = Sold Area Estimate & Non-Bid Species
 All species woodsrun unless listed otherwise.

Species Scaled: Ash , Aspen, Balsam Fir, Jack Pine, Maple , Paper Birch , Red Pine, Spruce

Species SAE:

Operability: Winter/Summer: 12/15 - 3/1 - 7/1-9/15	Soil Type: Nashwauk fine sandy loam, Menahga/Graycalm, Sandwick
Topography: Level to rolling	Cutting Acres: 40.5

All permits must follow Itasca County Forest Management Guidelines and Specifications (can be found at <http://www.co.itasca.mn.us/DocumentCenter/View/567/Forest-Management-Guidelines-and-Specifications>).

Harvest Specifications

Comments
Harvest Type: Aspen Clearcuts w/reserves 30 ac, Second Entry Red Pine Thin (operator select) 6 ac, Ash Thin 4.5 ac

Harvest and Reserves
Reserve all non-hazardous snags and cavity trees or any trees marked with an "R". In aspen clearcuts, also reserve cedar, yellow birch and pine. 10 acre aspen stand to SE could be logged during dry summer conditions (map), remainder of harvest requires winter frozen ground.

Access
Private road must be used to access the timber sale. Access road must be kept in good condition, as determined by administering forester, at all times. 2.4 miles to Turtle Creek Road.

Itasca County Timber Appraisal Report

Appraised By: Loren Eide Appraisal Date: 10/13/2022	Sale Type: REGULAR AUCTION SALE Auction Date: 12/08/2022	Appraisal Number: 22-04-14 Permit Number: Expiration Date: 03/01/2025 Page: 2 of 3
--	---	---

Landings and Access Roads

Timber sale administrator shall be notified at least 3 working days prior to completion of hauling and road work. This provides adequate time for permit area inspection and addressing of permit compliance requirements before hauling and road work equipment is removed. Location and construction of any new roads/landings must be pre-approved by the sale administrator.

Cutting, Felling, and Skidding

The second entry red pine thin requires timber to be processed at the stump. Use existing access strips and thin stand down to an average of 100 basal area. Favor the removal of smaller diameter, poor quality, and damaged trees. On ash thin, harvest ash >8" dbh.

Sale has both orange painted and natural cutting boundaries.

Do not disturb survey markers, including witness trees.

Site, Soil, and Water Protection

Filter strips require <5% soil disturbance within 50' of all wetlands.

Slash Disposal

Slash must be evenly distributed throughout permit area.

A 10 ft. wide slash free zone must be maintained along roads and trails.

Itasca County Timber Appraisal Report

Appraised By: Loren Eide	Sale Type: REGULAR AUCTION SALE	Appraisal Number: 22-04-14
Appraisal Date: 10/13/2022	Auction Date: 12/08/2022	Permit Number:
		Expiration Date: 03/01/2025
		Page: 3 of 3

Site Map:

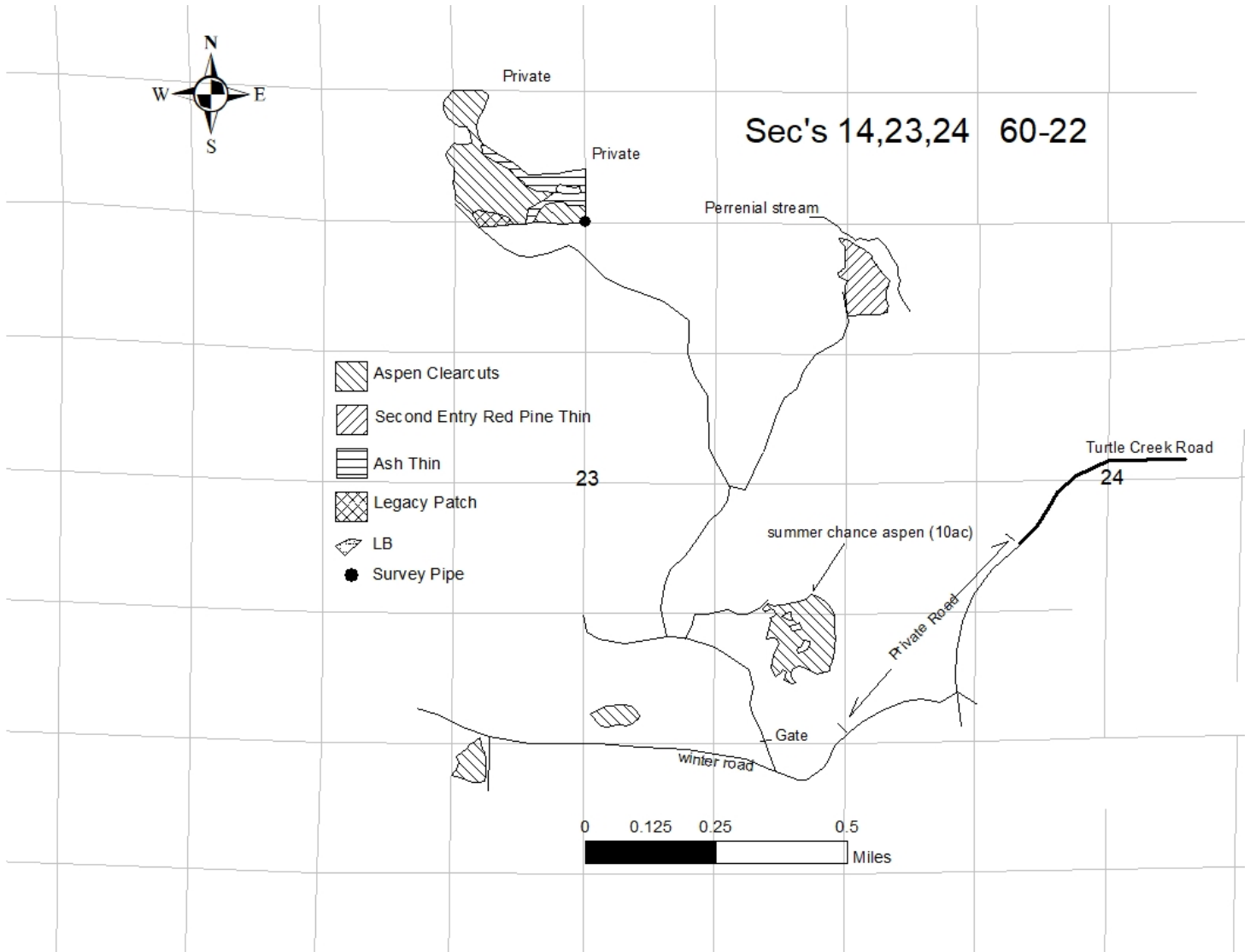

Appraisal examined and approved by _____
Forester Date

Appraisal examined and approved by _____
Land Department Date