

Itasca County Timber Appraisal Report

Appraised By: Ryan Newman Appraisal Date: 02/09/2022	Sale Type: REGULAR AUCTION SALE Auction Date: 06/08/2022	Appraisal Number: 22-05-01 Permit Number: Expiration Date: 03/01/2025 Page: 1 of 3
---	---	---

Legal Description

<u>RE Code</u>	<u>Sec.</u>	<u>Twp.</u>	<u>Rge.</u>	<u>City/Twp</u>	<u>Subd</u>
53-018-4100	18	60	23	Unorganized	NE SE
53-018-4400	18	60	23	Unorganized	SE SE
53-017-2000	17	60	23	Unorganized	NW 1/4
53-018-1400	18	60	23	Unorganized	SE NE
53-018-2400	18	60	23	Unorganized	SE NW
53-018-1300	18	60	23	Unorganized	SW NE
53-018-4200	18	60	23	Unorganized	NW SE
53-018-1102	18	60	23	Unorganized	NE NE LESS...
53-018-4300	18	60	23	Unorganized	SW SE
53-018-3000	18	60	23	Unorganized	SW 1/4

<u>Block 1 Species</u>	<u>Volume</u>	<u>Units</u>	<u>Unit Price</u>	<u>Value</u>	<u>Comments</u>	<u>Bolt %</u>	<u>Bid</u>
Aspen	1,643	Cords	\$23.00	\$37,789.00	3-7 Stick/ 10" avg. DBH	10	^
Spruce	697	Cords	\$12.00	\$8,364.00	3 Stick avg./ 8" avg. DBH	20	^
Jack Pine	330	Cords	\$11.00	\$3,630.00	3-4 Stick/ 9" avg. DBH	20	^
Red Pine	97	Cords	\$15.00	\$1,455.00	4 Stick avg./ 9"avg. DBH	40	#
Balsam Fir	88	Cords	\$11.00	\$968.00	3 Stick avg./ 6" avg. DBH	20	#
Balm	35	Cords	\$23.00	\$805.00	5 Stick avg./ 10" avg. DBH	5	^
Paper Birch	21	Cords	\$8.00	\$168.00	4 Stick/ 10" avg. DBH	15	#
Tamarack	19	Cords	\$5.00	\$95.00	5 Stick/ 10" avg. DBH	10	#
Maple	6	Cords	\$8.00	\$48.00			#

\$53,322.00 **Subtotal**

Total Cords = 2,936 **Total MBF: 0** \$53,322.00 **Total**

Bid Symbols: ^ = Bid Species; # = Non-Bid Species; + = Sold Area Estimate; * = Sold Area Estimate & Non-Bid Species
 All species woodsrun unless listed otherwise.

Species Scaled: Aspen, Balm , Balsam Fir, Jack Pine, Maple , Paper Birch , Red Pine, Spruce , Tamarack

Species SAE:

Operability: Winter - Frozen Ground: 12/1 - 3/1	Soil Type: 620B Cutaway loamy sand. 867B Menahga and Graycalm.
Topography: Level to rolling	Cutting Acres: 121.9

All permits must follow Itasca County Forest Management Guidelines and Specifications (can be found at <http://www.co.itasca.mn.us/DocumentCenter/View/567/Forest-Management-Guidelines-and-Specifications>).

Harvest Specifications

Comments
Harvest Type: Aspen Clearcut with Reserves (52.2 acres). First Time Spruce Thin (68.3 acres). Pine Thin (1.4 acres).

Harvest and Reserves
Reserve oak, white pine, and all non-hazardous snags.

Itasca County Timber Appraisal Report

Appraised By: Ryan Newman Appraisal Date: 02/09/2022	Sale Type: REGULAR AUCTION SALE Auction Date: 06/08/2022	Appraisal Number: 22-05-01 Permit Number: Expiration Date: 03/01/2025 Page: 2 of 3
---	---	---

Access
0.15 miles to Co. Rd. 52.

Landings and Access Roads
Location and construction of any new roads/landings must be pre-approved by the sale administrator. Trails and landings need to be rehabilitated to a satisfactory condition, determined by administering forester, before performance bond is returned.

Cutting, Felling, and Skidding
Spruce Thinning Block: Timber must be processed at the stump. Cut 12 ft. access strips reserving 40 ft. in between strips for thinning. Thin stand down to an average of 90 basal area. Favor the removal of smaller diameter, poor quality, and damaged trees. Favor white spruce crop trees. Pine Thinning Block: Timber must be processed at the stump. Cut 12 ft. access strips reserving 40 ft. in between strips for thinning. Thin stand down to an average of 90 basal area. Favor the removal of smaller diameter, poor quality, and damaged trees. Aspen Block: Clearcut with reserves. Sale boundaries painted blue and natural boundaries. Do not disturb survey markers, including witness trees. Do not fell timber into wetlands or across sale boundaries.

Site, Soil, and Water Protection
Filter strips require <5% soil disturbance within 50' of all wetlands.

Slash Disposal
Slash must be evenly distributed throughout permit area.

Regeneration Plan
Thinning Blocks: Due to nature of managed species and type of harvest little to no tree regeneration is expected to occur after harvest. Aspen Block: Natural regeneration to aspen.

Itasca County Timber Appraisal Report

Appraised By: Ryan Newman	Sale Type: REGULAR AUCTION SALE	Appraisal Number: 22-05-01
Appraisal Date: 02/09/2022	Auction Date: 06/08/2022	Permit Number:
		Expiration Date: 03/01/2025
		Page: 3 of 3

Site Map:

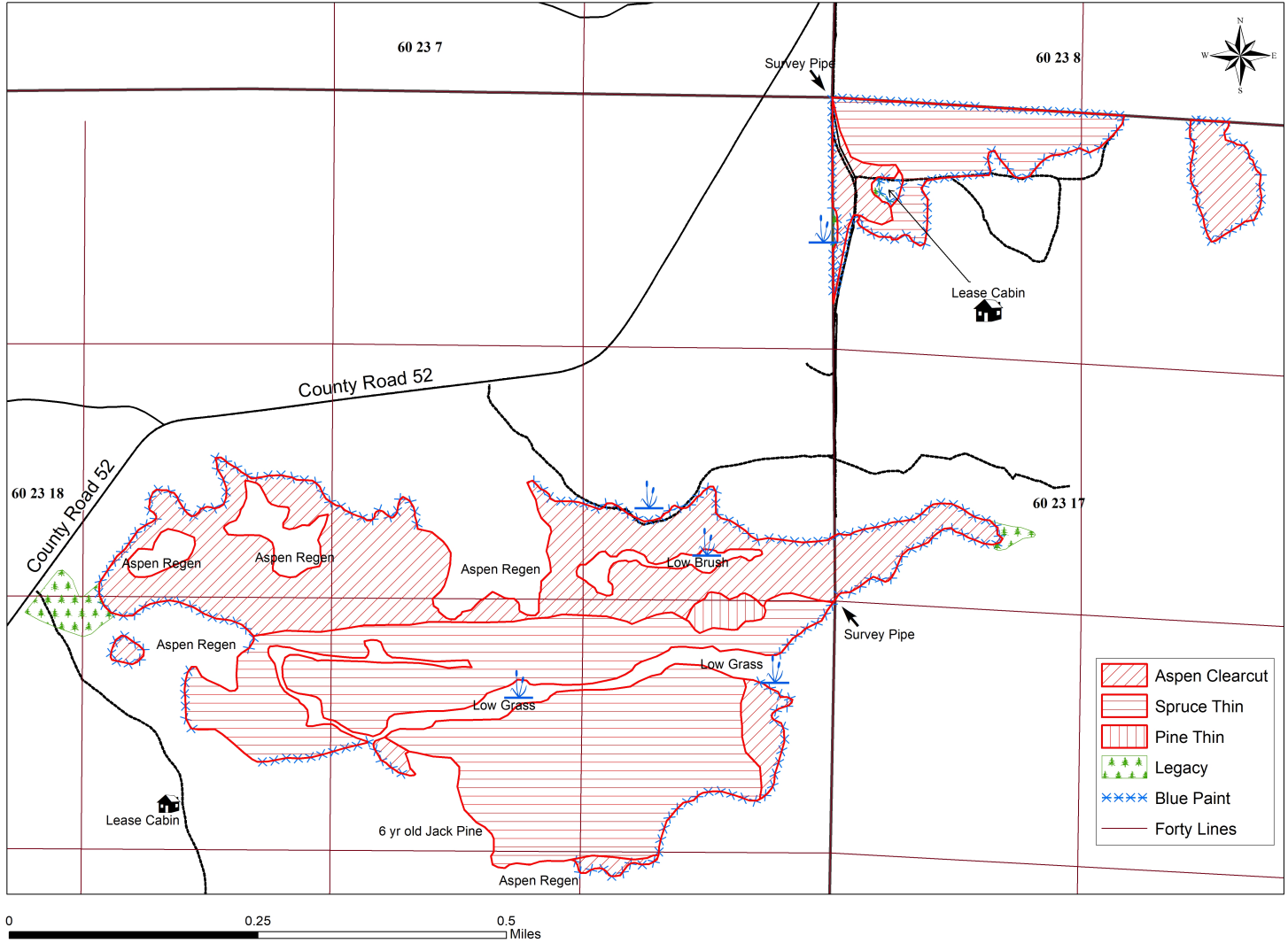

Appraisal examined and approved by _____
Forester Date

Appraisal examined and approved by _____
Land Department Date