

Itasca County Timber Appraisal Report

Appraised By: Tony Schram Appraisal Date: 04/12/2022	Sale Type: REGULAR AUCTION SALE Auction Date: 06/08/2022	Appraisal Number: 22-06-09 Permit Number: Expiration Date: 03/01/2025 Page: 1 of 3
---	---	---

Legal Description

<u>RE Code</u>	<u>Sec.</u>	<u>Twp.</u>	<u>Rge.</u>	<u>City/Twp</u>	<u>Subd</u>		
09-021-1400	21	147	25	Bowstring	SE NE		
09-022-2300	22	147	25	Bowstring	SW NW		
<u>Block 1 Species</u>	<u>Volume</u>	<u>Units</u>	<u>Unit Price</u>	<u>Value</u>	<u>Comments</u>	<u>Bolt %</u>	<u>Bid</u>
Ash	110	Cords	\$9.00	\$990.00	3-5 stick 7-10 inch	20	^
Balsam Fir	80	Cords	\$9.00	\$720.00	3-5 stick 6-10 inch		^
Aspen	30	Cords	\$22.00	\$660.00	3-5 stick 6-14 inch Highly variable condition		^
Balm	20	Cords	\$22.00	\$440.00	3-5 stick 7-16 inch Poor quality		^
Basswood	20	Cords	\$6.00	\$120.00	3-5 stick 7-12 inch	10	#
Paper Birch	10	Cords	\$9.00	\$90.00	3-5 stick 7-10 inch		#
				\$3,020.00	Subtotal		
Total Cords =		270	Total MBF: 0		\$3,020.00	Total	

Bid Symbols: ^ = Bid Species; # = Non-Bid Species; + = Sold Area Estimate; * = Sold Area Estimate & Non-Bid Species
 All species woodsrun unless listed otherwise.

Species Scaled: Ash , Aspen, Balm , Balsam Fir, Basswood , Paper Birch

Species SAE:

Operability: Frozen Ground : 12-1 - 3-1	Soil Type: Spooner-Littleswan, Sax, Littleswan silt loam, Baudette-Littleswan complex
Topography: Level	Cutting Acres: 20.6

All permits must follow Itasca County Forest Management Guidelines and Specifications (can be found at <http://www.co.itasca.mn.us/DocumentCenter/View/567/Forest-Management-Guidelines-and-Specifications>).

Harvest Specifications

Comments
Harvest Type: Lowland Hardwoods clearcut with reserves (15.4 ac) Ash Thin (5.2 Ac)

Harvest and Reserves
Lowland Hardwood clearcut: Harvest all aspen, Balm, balsam, ash, basswood, and birch. Ash Thin: Thin ash down to a 60 basal area. Reserve all non-hazardous snags.

Access
Private must be crossed to access timber sale. Logger must obtain permits/ permission from land owner/ land manager.

Landings and Access Roads
Existing trails and landings will be used to access the sale and land the wood, they need to be rehabilitated to a satisfactory condition, determined by administering forester, before performance bond is returned. If wildlife opening is used for a landing it will need to be cleaned up and left in original condition.

Cutting, Felling, and Skidding
Do not damage unmarked trees, regeneration, or reserve trees. Do not fell timber into wetlands or across sale boundaries. Sale boundaries painted with orange circles on the property line and orange slashes on the cutting boundaries.

Itasca County Timber Appraisal Report

Appraised By: Tony Schram	Sale Type: REGULAR AUCTION SALE	Appraisal Number: 22-06-09
Appraisal Date: 04/12/2022	Auction Date: 06/08/2022	Permit Number:
		Expiration Date: 03/01/2025
		Page: 2 of 3

Slash Disposal

Slash must be evenly distributed throughout permit area.

Regeneration Plan

Natural Regeneration back to lowland hardwood species.

Itasca County Timber Appraisal Report

Appraised By: Tony Schram	Sale Type: REGULAR AUCTION SALE	Appraisal Number: 22-06-09
Appraisal Date: 04/12/2022	Auction Date: 06/08/2022	Permit Number:
		Expiration Date: 03/01/2025
		Page: 3 of 3

Site Map:

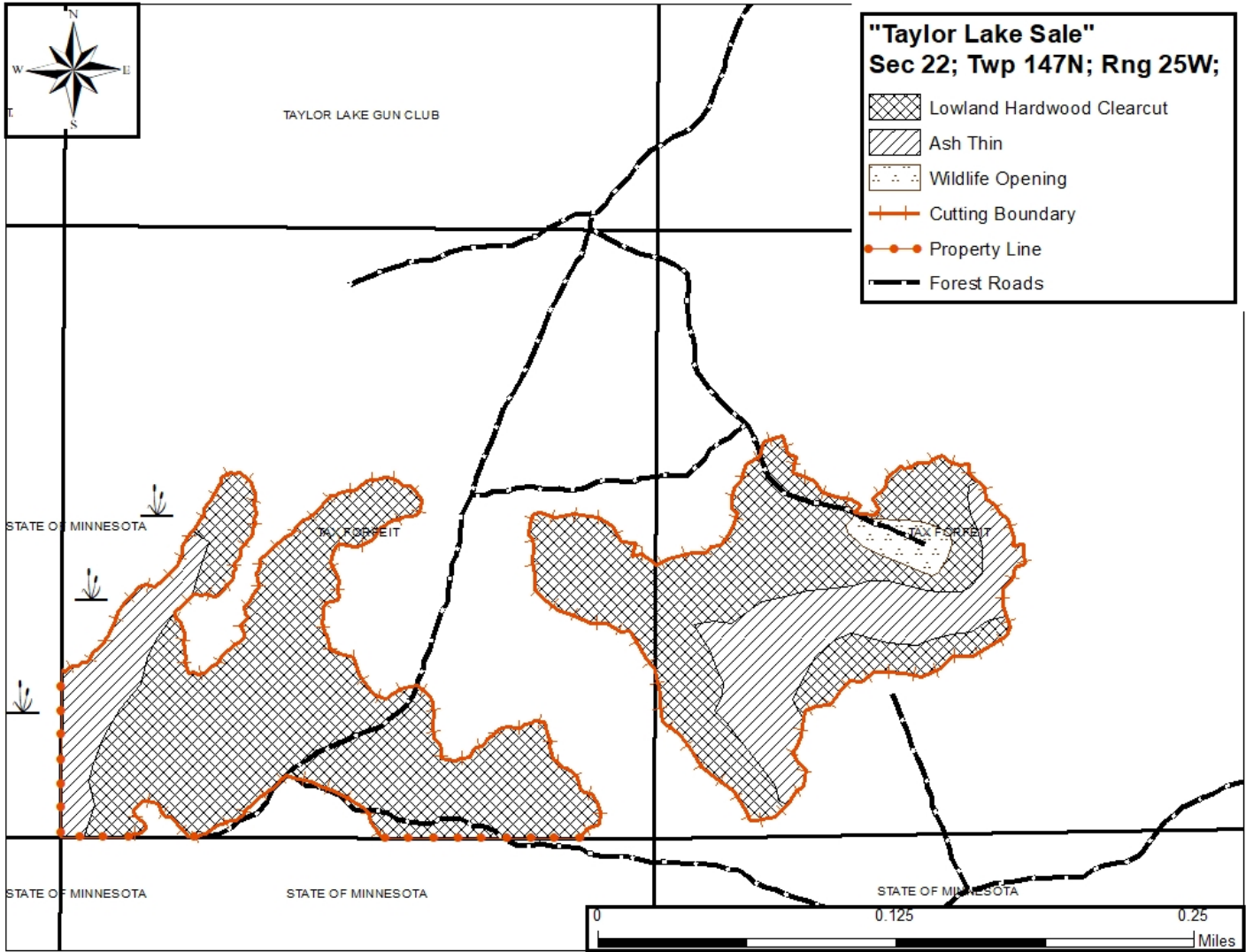

Appraisal examined and approved by _____
Forester
Date

Appraisal examined and approved by _____
Land Department
Date