



## Itasca County Timber Appraisal Report

<b>Appraised By:</b> Jesse Lehner <b>Appraisal Date:</b> 10/14/2021	<b>Sale Type:</b> REGULAR AUCTION SALE <b>Auction Date:</b> 06/08/2022	<b>Appraisal Number:</b> 22-07-05 <b>Permit Number:</b> <b>Expiration Date:</b> 03/01/2025 <b>Page:</b> 2 of 3
--	---	---

### Site, Soil, and Water Protection

Filter strips require <5% soil disturbance within 50' of all wetlands.

Reserve all non-merchantable timber within 15ft of all wetlands.

### Slash Disposal

Slash must be evenly distributed throughout permit area.

### Special Conditions

As seen on map a fence divided areas of this permit. Fence can be cut open for access needs, but must be closed again after harvest activities.

### Regeneration Plan

Natural regeneration of a new aspen cohort by way of coppice is expected.

# Itasca County Timber Appraisal Report

<b>Appraised By:</b> Jesse Lehner <b>Appraisal Date:</b> 10/14/2021	<b>Sale Type:</b> REGULAR AUCTION SALE <b>Auction Date:</b> 06/08/2022	<b>Appraisal Number:</b> 22-07-05 <b>Permit Number:</b> <b>Expiration Date:</b> 03/01/2025 <b>Page:</b> 3 of 3
--	---	---

**Site Map:**

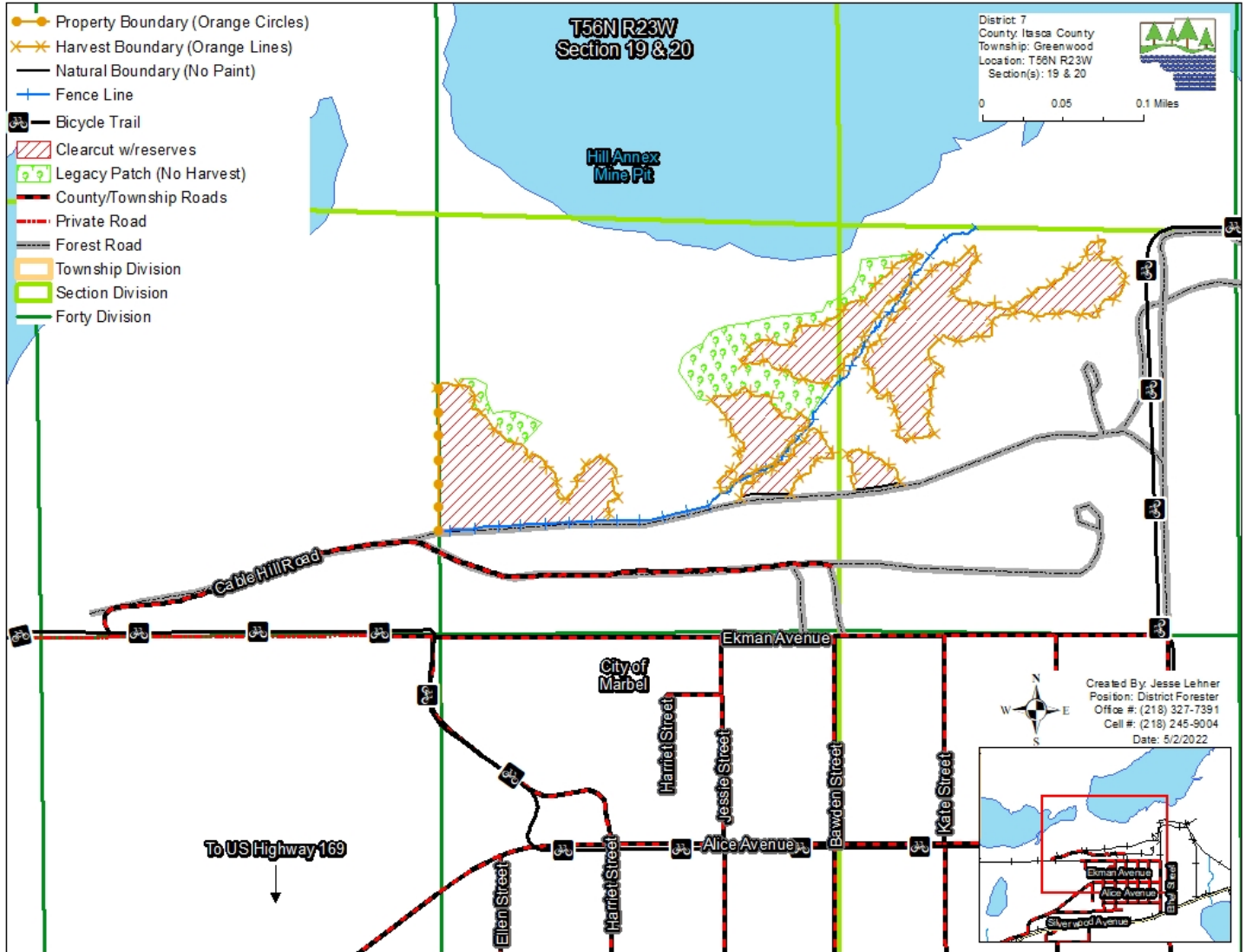

Appraisal examined and approved by \_\_\_\_\_  
Forester Date

Appraisal examined and approved by \_\_\_\_\_  
Land Department Date