

Itasca County Timber Appraisal Report

Appraised By:

Bob Rother

Appraisal Date:

03/15/2023

Sale Type:

REGULAR AUCTION SALE

Auction Date:

06/05/2024

Appraisal Number: 23-01-03**Permit Number:****Expiration Date:** 03/01/2027**Page:** 1 of 3**Legal Description**

RE Code	Sec.	Twp.	Rge.	City/Twp	Subd			
42-029-3100	29	53	22	Wawina	NE SW			
42-020-3000	20	53	22	Wawina	SW 1/4			
42-029-2000	29	53	22	Wawina	NW 1/4			
42-030-1000	30	53	22	Wawina	NE 1/4			
Block 1 Species	Volume	Units	Unit Price	Value	Comments	Bolt %	Bid	
Tamarack	1,150	Cords	\$4.00	\$4,600.00	3-7 Sticks, 5-9" DBH, Fair-Good Condition, 19% Mortality	40	^	
Spruce	5	Cords	\$15.00	\$75.00	2-4 Sticks, 5" DBH, Fair-Good Condition, 100% Black Spruce	0	#	
				\$4,675.00	Subtotal			
Total Cords =	1,155		Total MBF: 0	\$4,675.00	Total			

Bid Symbols: ^ = Bid Species; # = Non-Bid Species; + = Sold Area Estimate; * = Sold Area Estimate & Non-Bid Species
 All species woodsrun unless listed otherwise.

Species Scaled: Spruce , Tamarack

Species SAE:

Operability: Winter Chance - Frozen Ground: 12/15 - 3/15

Soil Type: Greenwood Peat

Topography: Level

Cutting Acres: 43.4

All permits must follow Itasca County Forest Management Guidelines and Specifications (can be found at <http://www.co.itasca.mn.us/DocumentCenter/View/567/Forest-Management-Guidelines-and-Specifications>).

Harvest Specifications**Harvest Guidelines**

Harvest Type: Tamarack Clearcut with Reserves

Reserve Guidelines

Reserve 6 to 12, healthy full-crowned tamarack seed trees per acres. Space the reserves approximately 60-70 feet apart. Reserve tamarack & black spruce regeneration.

Reserve all non-hazardous snags, den and cavity trees.

Cutting, Felling, and Skidding

Do not damage regeneration or reserve trees.

Sale boundaries painted ORANGE Slashes (III). All other boundaries are GPS/Natural cover type boundaries.

Access

0.9 miles southwest of US HWY 2 and 0.25 miles north of Co Rd 429. If accessing from the south, permittee must obtain permission to cross pipeline along snowmobile trail.

Landings and Access Roads

Location and construction of any new roads/landings must be pre-approved by the sale administrator.

Trails and landings need to be rehabilitated to a satisfactory condition, determined by administering forester, before performance bond is returned.

Slash Disposal

Slash must be evenly distributed throughout permit area.

Itasca County Timber Appraisal Report

Appraised By: Bob Rother	Sale Type: REGULAR AUCTION SALE	Appraisal Number: 23-01-03
Appraisal Date: 03/15/2023	Auction Date: 06/05/2024	Permit Number:
		Expiration Date: 03/01/2027
		Page: 2 of 3

Regeneration Plan
Natural Regeneration to Tamarack

Itasca County Timber Appraisal Report

Appraised By:

Bob Rother

Appraisal Date:

03/15/2023

Sale Type:

REGULAR AUCTION SALE

Auction Date:

06/05/2024

Appraisal Number: 23-01-03

Permit Number:

Expiration Date: 03/01/2027

Page: 3 of 3

Site Map:

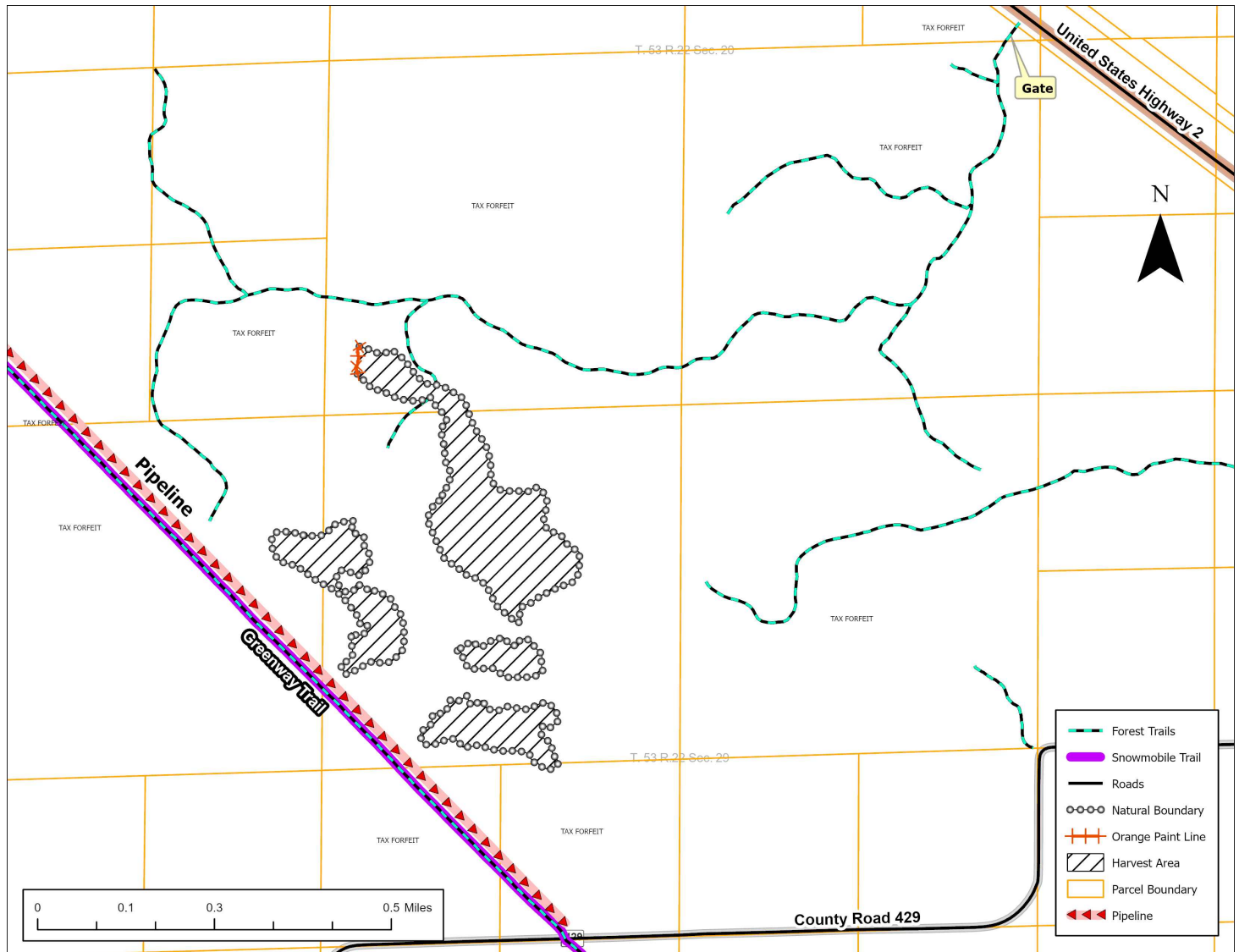

Appraisal examined and approved by

Forester

Date

Appraisal examined and approved by

Land Department

Date