

# Itasca County Timber Appraisal Report

<b>Appraised By:</b> Bob Rother	<b>Sale Type:</b> REGULAR AUCTION SALE	<b>Appraisal Number:</b> 23-01-11
<b>Appraisal Date:</b> 04/12/2023	<b>Auction Date:</b> 12/14/2023	<b>Permit Number:</b>
		<b>Expiration Date:</b> 03/01/2026
		<b>Page:</b> 1 of 2

**Legal Description**

<u>RE Code</u>	<u>Sec.</u>	<u>Twp.</u>	<u>Rge.</u>	<u>City/Twp</u>	<u>Subd</u>		
34-025-4100	25	53	23	Sago	NE SE		
34-025-1000	25	53	23	Sago	NE 1/4		
<u>Block 1 Species</u>	<u>Volume</u>	<u>Units</u>	<u>Unit Price</u>	<u>Value</u>	<u>Comments</u>	<u>Bolt %</u>	<u>Bid</u>
Tamarack	1,000	Cords	\$4.00	\$4,000.00	5-14 inch, 2-5 stick, 60% mortality	30	^
Spruce	65	Cords	\$15.00	\$975.00	5-10 inch, 2-6 stick.	10	#
Paper Birch	70	Cords	\$6.00	\$420.00	5-14 inch, 2-5 stick.	0	#
Balsam Fir	5	Cords	\$7.00	\$35.00	5-9 inch, 1-4 stick.	0	#
				\$5,430.00	<b>Subtotal</b>		
<b>Total Cords =</b>	1,140	<b>Total MBF: 0</b>		\$5,430.00	<b>Total</b>		

Bid Symbols: ^ = Bid Species; # = Non-Bid Species; + = Sold Area Estimate; \* = Sold Area Estimate & Non-Bid Species  
 All species woodsrun unless listed otherwise.

**Species Scaled:** Balsam Fir, Paper Birch, Spruce, Tamarack

**Species SAE:**

<b>Operability:</b> Winter Frozen Ground: 12-1 - 3-1	<b>Soil Type:</b> Mooselake and Lupton mucky peats & Greenwood peat
<b>Topography:</b> Level	<b>Cutting Acres:</b> 60.1

All permits must follow Itasca County Forest Management Guidelines and Specifications (can be found at <http://www.co.itasca.mn.us/DocumentCenter/View/567/Forest-Management-Guidelines-and-Specifications> ).

**Harvest Specifications**

Harvest Guidelines
Harvest Type: Tamarack Clear Cut (52.3 ac) and Ash Thin (7.8 ac).
Reserve Guidelines
Reserve all non-hazardous snags. Reserve all: cedar, white pine, oak, elm, balm, and balsam < 2 sticks. In Tamarack clear cut area, reserve all regeneration along with one health tamarack seed tree every 60 feet.
Cutting, Felling, and Skidding
Sale boundaries painted in ORANGE slash (     ) along with natural boundaries. Ash Thin: cut 12 foot access strips reserving 40 feet in between strips for thinning. Thin stand down to an average of 50 basal area. Favor the removal of larger diameter & good quality trees first. The harvestable species in this area are: ash, balsam, black spruce, paper birch, and tamarack.
Access
Access is along County Rd 428.
Slash Disposal
Slash must be evenly distributed throughout permit area. Slash height must not exceed 3 feet within view of road.
Comments
As of site visit: Average basal area in ash thin area is 75 BA. In tamarack area, roughly 60% of the stand is in decline due to bark beetles.

# Itasca County Timber Appraisal Report

<b>Appraised By:</b> Bob Rother	<b>Sale Type:</b> REGULAR AUCTION SALE	<b>Appraisal Number:</b> 23-01-11
<b>Appraisal Date:</b> 04/12/2023	<b>Auction Date:</b> 12/14/2023	<b>Permit Number:</b>
		<b>Expiration Date:</b> 03/01/2026
		<b>Page:</b> 2 of 2

**Site Map:**

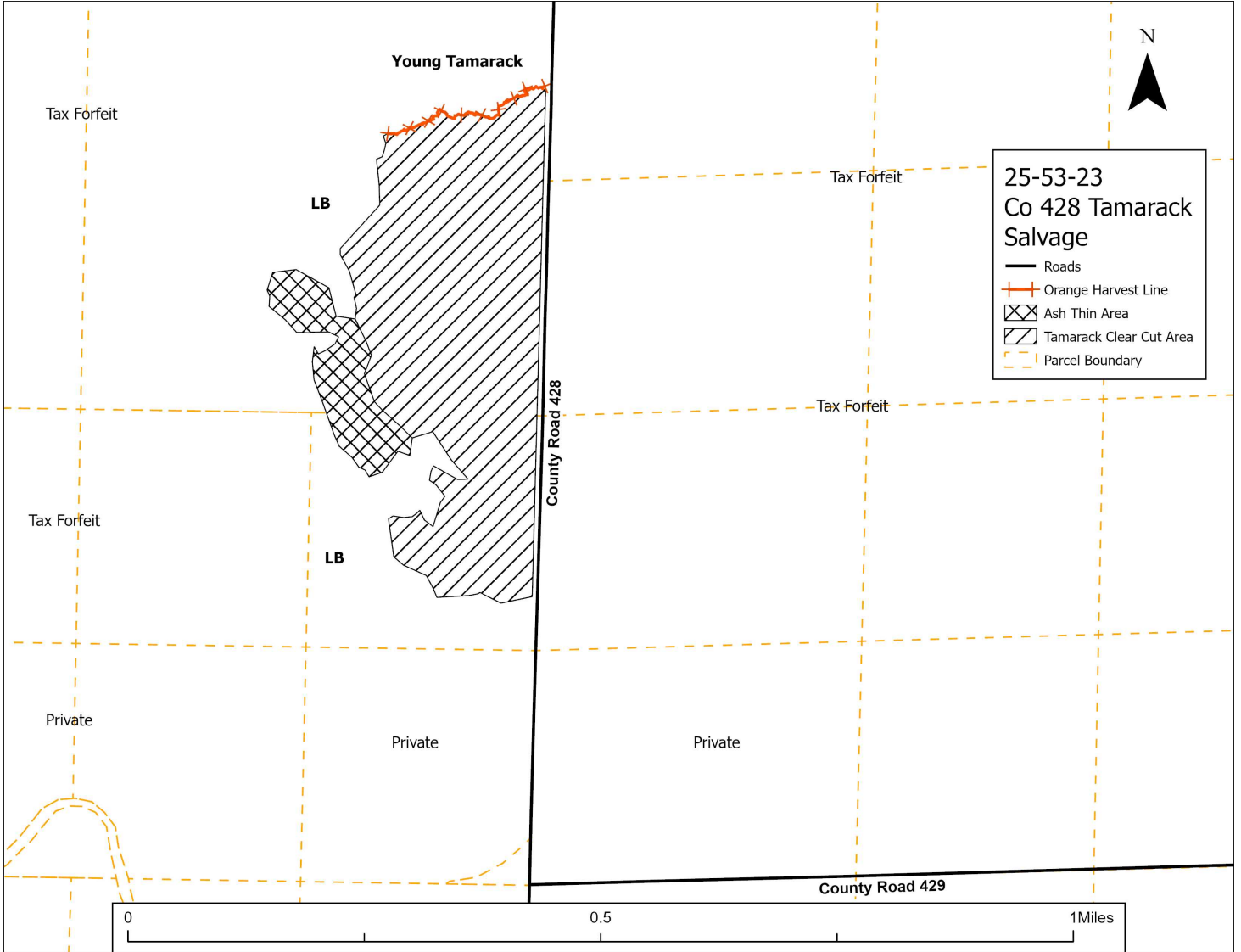

Appraisal examined and approved by \_\_\_\_\_  
Forester
Date

Appraisal examined and approved by \_\_\_\_\_  
Land Department
Date