

Itasca County Timber Appraisal Report

Appraised By: Nick Schreiber Appraisal Date: 05/19/2023	Sale Type: INTERMEDIATE AUCTION Auction Date: 12/14/2023	Appraisal Number: 23-03-20 Permit Number: Expiration Date: 03/01/2027 Page: 1 of 3
--	---	---

Legal Description

RE Code	Sec.	Twp.	Rge.	City/Twp	Subd
55-025-1200	25	59	24	Unorganized	NW NE
52-030-2200	30	59	23	Unorganized	LOT 1
52-030-2300	30	59	23	Unorganized	LOT 2
55-025-1100	25	59	24	Unorganized	NE NE

Block 1 Species	Volume	Units	Unit Price	Value	Comments	Bolt %	Bid
Red Pine	647	Cords	\$52.00	\$33,644.00	15-22" DBH, 7-9 sticks, good quality, 60% saw, 5% cabin logs	20	^
Paper Birch	58	Cords	\$14.00	\$812.00	7-11" DBH, 2-6 sticks, good quality	35	#
Aspen	42	Cords	\$27.00	\$1,134.00	9-14" DBH, 3-7 sticks, poor-fair quality	25	#
Jack Pine	5	Cords	\$9.00	\$45.00	8-12" DBH, 5-8 sticks, good quality	70	#
Spruce	4	Cords	\$17.00	\$68.00	6-11" DBH, 2-6 sticks, good quality	50	#
White Pine	2	Cords	\$9.00	\$18.00	7-16" DBH, 5-8 sticks, fair quality	50	#
Balsam Fir	1	Cords	\$9.00	\$9.00	6-10" DBH, 3-6 sticks, fair quality	40	#
Maple	1	Cords	\$9.00	\$9.00	6-9" DBH, 2-4 sticks, fair quality	0	#
				\$35,739.00	Subtotal		
Total Cords =	760	Total MBF: 0		\$35,739.00	Total		

Bid Symbols: ^ = Bid Species; # = Non-Bid Species; + = Sold Area Estimate; * = Sold Area Estimate & Non-Bid Species
 All species woodsrun unless listed otherwise.

Species Scaled: Aspen, Balsam Fir, Jack Pine, Maple , Paper Birch , Red Pine, Spruce , White Pine

Species SAE:

Operability: Dry Summer: 7/1 - 3/1	Soil Type: Menahga and Graycalm
Topography: Level	Cutting Acres: 13.2

All permits must follow Itasca County Forest Management Guidelines and Specifications (can be found at <http://www.co.itasca.mn.us/DocumentCenter/View/567/Forest-Management-Guidelines-and-Specifications>).

Harvest Specifications

Harvest Guidelines
Harvest Type: Red pine clearcut with reserves (11 acres), paper birch clearcut with reserves (1 acre), and aspen clearcut with reserves (1 acre).

Reserve Guidelines
Reserve all non-hazardous snags, den trees, cavity trees, white pine without blue "C", oak, and blue "R" reserves trees. East of prescription line, reserve red pine 5" DBH and less.

Cutting, Felling, and Skidding
Do not fell timber into wetlands or across sale boundaries. Property boundaries painted with 3 orange circles. Harvest boundaries painted with 3 or 1 vertical orange dash. Prescription boundary painted with 4 blue "+" marks. Rest are natural boundaries. Cut red pine, aspen, jack pine, paper birch, spruce, fir, and maple. Cut white pine with blue "C".

Itasca County Timber Appraisal Report

Appraised By: Nick Schreiber Appraisal Date: 05/19/2023	Sale Type: INTERMEDIATE AUCTION Auction Date: 12/14/2023	Appraisal Number: 23-03-20 Permit Number: Expiration Date: 03/01/2027 Page: 2 of 3
--	---	---

Access

Snowmobile trail regulations in Itasca County Forest Management Guideline & Specifications apply. A minimum of two inches of compacted snow must remain on the trail as a running surface.
 Access is along County Roads 53 and 336.

Landings and Access Roads

Location and construction of any new roads/landings must be pre-approved by the sale administrator.
 Trails and landings need to be rehabilitated to a satisfactory condition, determined by administering forester, before performance bond is returned.
 Reserve all non-merchantable timber within 15 feet of county roads.
 Landings must be kept back at least 100 feet from county roads.
 Timber sale administrator shall be notified at least 3 working days prior to completion of hauling and road work. This provides adequate time for permit area inspection and addressing of permit compliance requirements before hauling and road work equipment is removed.

Site, Soil, and Water Protection

Filter strips require <5% soil disturbance within 50 feet of all wetlands.
 Can cross intermittent creek in 1 location. All slash must be pulled from the creek and banks rehabilitated upon sale completion.
 Reserve all non-merchantable timber within 15 feet of all wetlands.

Slash Disposal

Slash must be evenly distributed throughout permit area.
 A 10 foot wide slash free zone must be maintained along roads and trails.
 Slash height must not exceed 3 feet within view of county roads.

Special Conditions

Logging season may be restricted to August through February during high bark beetle risk. All cut pine must be hauled within 3 weeks during June through August.

Regeneration Plan

Artificial red pine regeneration in 75% of the sale area. Natural regeneration in the rest of the area.

Itasca County Timber Appraisal Report

Appraised By:
Nick Schreiber
Appraisal Date:
05/19/2023

Sale Type:
INTERMEDIATE AUCTION
Auction Date:
12/14/2023

Appraisal Number: 23-03-20
Permit Number:
Expiration Date: 03/01/2027
Page: 3 of 3

Site Map:

Someman Lake Red Pine

Legal: 59-23-30, 59-24-25

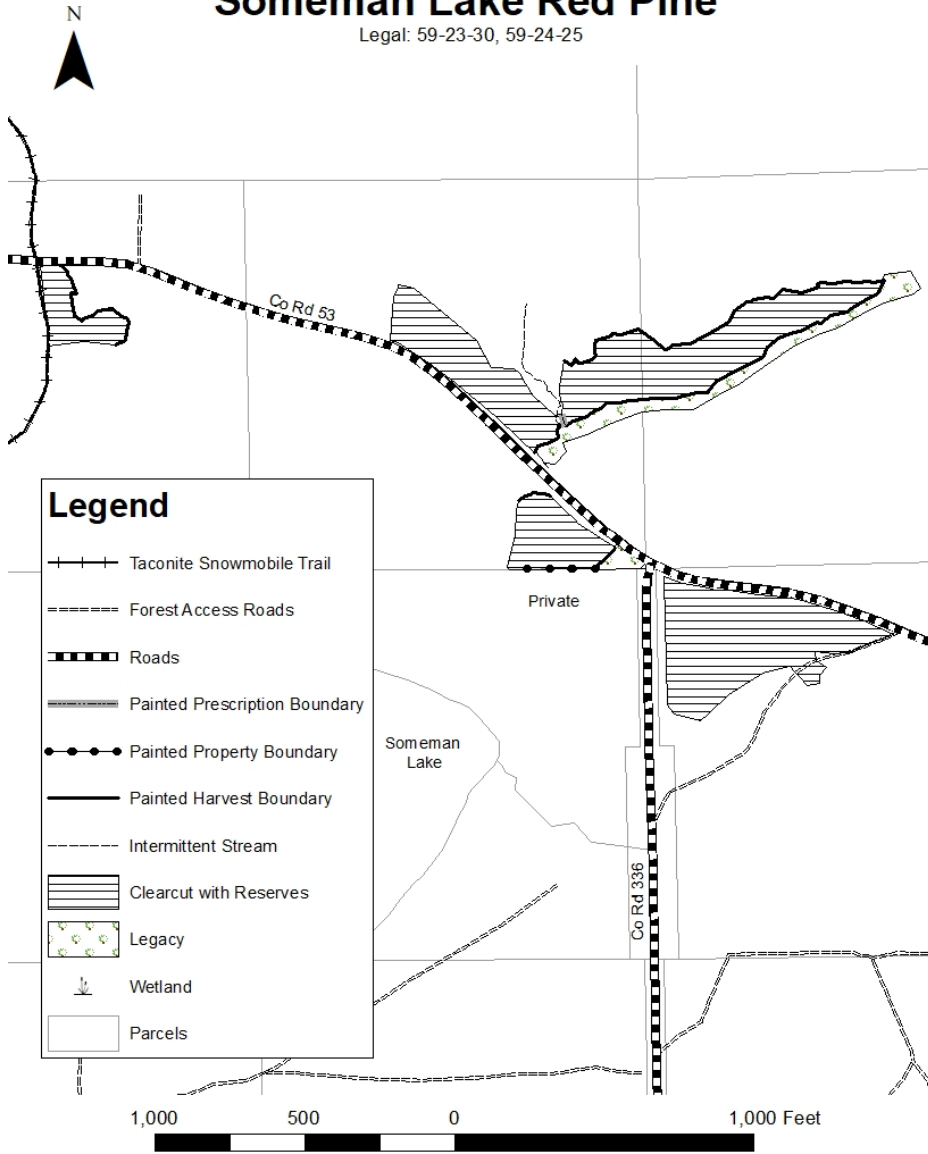

Appraisal examined and approved by _____
Forester Date

Appraisal examined and approved by _____
Land Department Date