

Itasca County Timber Appraisal Report

Appraised By: Loren Eide Appraisal Date: 10/17/2023	Sale Type: REGULAR AUCTION SALE Auction Date: 12/14/2023	Appraisal Number: 23-04-14 Permit Number: Expiration Date: 03/01/2026 Page: 1 of 3
--	---	---

Legal Description

RE Code	Sec.	Twp.	Rge.	City/Twp	Subd
06-120-1400	20	60	22	Bearville	SE NE
06-120-4000	20	60	22	Bearville	SE 1/4
06-121-3000	21	60	22	Bearville	SW 1/4
06-128-1200	28	60	22	Bearville	NW NE
06-128-2000	28	60	22	Bearville	NW 1/4
06-121-2000	21	60	22	Bearville	NW 1/4
06-129-1000	29	60	22	Bearville	NE 1/4

Block 1 Species	Volume	Units	Unit Price	Value	Comments	Bolt %	Bid
Spruce	890	Cords	\$9.00	\$8,010.00	5-12"	10	^
Ash	200	Cords	\$9.00	\$1,800.00	8-18", 7% saw	40	^
Balsam Fir	180	Cords	\$5.00	\$900.00	5-11"	5	^
Aspen	50	Cords	\$14.00	\$700.00	5-10"		#
Paper Birch	25	Cords	\$6.00	\$150.00			#
Maple	5	Cords	\$6.00	\$30.00			#
				\$11,590.00	Subtotal		
Total Cords =	1,350			Total MBF: 0	Total		

Bid Symbols: ^ = Bid Species; # = Non-Bid Species; + = Sold Area Estimate; * = Sold Area Estimate & Non-Bid Species
 All species woodsrun unless listed otherwise.

Species Scaled: Ash , Aspen, Balsam Fir, Maple , Paper Birch , Spruce

Species SAE:

Operability:	Soil Type:	Nashwauk fine sandy loam, Cathrow muck
Topography: Level to rolling	Cutting Acres:	93.5

All permits must follow Itasca County Forest Management Guidelines and Specifications (can be found at <http://www.co.itasca.mn.us/DocumentCenter/View/567/Forest-Management-Guidelines-and-Specifications>).

Harvest Specifications

Harvest Guidelines
Harvest Type: 1st Entry White Spruce Thins (82ac.), 1st Entry Ash Thins (11.5ac. operator select).

Reserve Guidelines
Reserve cedar, ash <8" dbh in ash stands when possible, all non-hazardous snags, den trees and cavity trees.

Cutting, Felling, and Skidding
Timber must be processed at the stump. Cut 12 foot access strips reserving 40 feet in between strips for thinning. Thin stand down to an average of 90 basal area. Favor the removal of smaller diameter, poor quality, and damaged trees. Do not fell timber into wetlands or across sale boundaries. Sale uses mostly natural cutting boundaries, some orange painted. Some fringes of the spruce plantations are aspen. Where natural cutting boundaries are used, treat these as reserves with no thinning. Run the clearcut strips through them only if necessary for thinning the spruce. In ash types, thin from above 50% of basal area in trees 8" and greater. Leave 1 "plus tree" (large with good form/condition) per acre.

Itasca County Timber Appraisal Report

Appraised By: Loren Eide Appraisal Date: 10/17/2023	Sale Type: REGULAR AUCTION SALE Auction Date: 12/14/2023	Appraisal Number: 23-04-14 Permit Number: Expiration Date: 03/01/2026 Page: 2 of 3
--	---	---

Access

Taconite Snowmobile Trail crosses Sherry Lake Trail (access rd). Do not leave any plowed snow banks at crossing
Snowmobile trail regulations in Itasca County Forest Management Guideline & Specifications apply. A minimum of two inches of compacted snow must remain on the trail as a running surface.

Landings and Access Roads

Timber sale administrator shall be notified at least 3 working days prior to completion of hauling and road work. This provides adequate time for permit area inspection and addressing of permit compliance requirements before hauling and road work equipment is removed.
Location and construction of any new roads/landings must be pre-approved by the sale administrator.

Site, Soil, and Water Protection

Filter strips require <5% soil disturbance within 50 feet of all wetlands.

Slash Disposal

Slash must be evenly distributed throughout permit area.

Regeneration Plan

Natural Regeneration

Itasca County Timber Appraisal Report

Appraised By:

Loren Eide

Appraisal Date:

10/17/2023

Sale Type:

REGULAR AUCTION SALE

Auction Date:

12/14/2023

Appraisal Number: 23-04-14

Permit Number:

Expiration Date: 03/01/2026

Page: 3 of 3

Site Map:

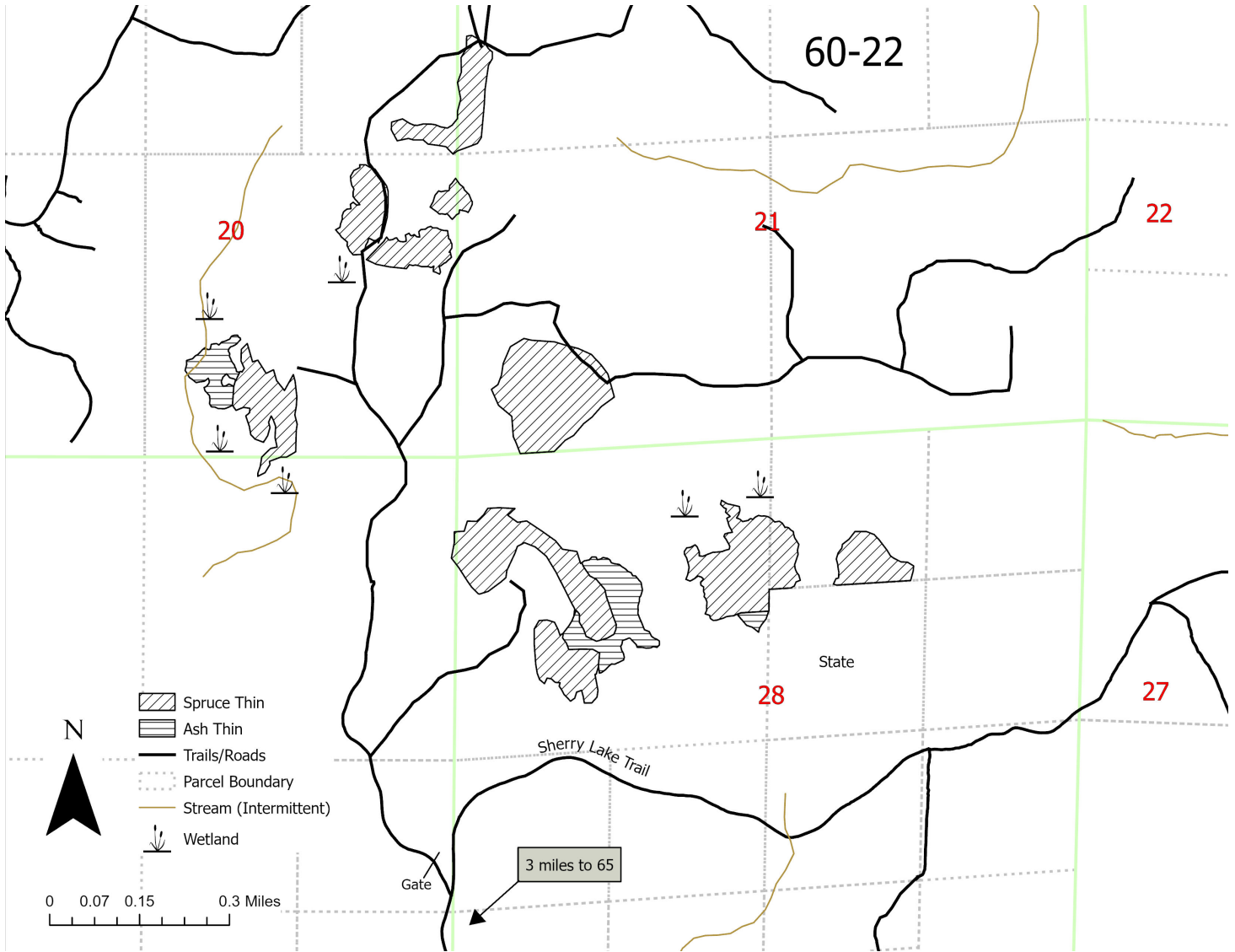

Appraisal examined and approved by _____

Forester

_____ Date

Appraisal examined and approved by _____

Land Department

_____ Date